

S3 DIGITAL BILGE SWITCH



SOLID STATE ELECTRONIC SENSING TECHNOLOGY

**SMART SENSING SYSTEM DISTINGUISHES BILGE
SUDS, GASOLINE, OR MARINE OIL MIXTURES FROM
BILGE WATER AND RESPONDS APPROPRIATELY**

**WAVES AND BOAT ROCKING WON'T CAUSE
EXCESSIVE CYCLING**

S3 DIGITAL BILGE SWITCH



Attwood's S3 electronic bilge switch is the industry answer to broken mechanical switches, jammed float mechanisms and ever annoying excessively cycling pump. The S3 Series bilge pump switch incorporates a proprietary Solid State electronic Sensing Technology to detect bilge water levels and trigger pump activation more consistently, more reliably and for a significantly longer working life compared to traditional mechanical float switches.

TECHNOLOGY YOU CAN TRUST

Attwood has engineered the S3 series to operate in any bilge water mixture dependably, without failure. The S3's smart sensing system can distinguish bilge suds, gasoline or marine oil mixtures for bilge water and respond appropriately. With Attwood S3, you can rest assured that harmful chemicals, if spilled into the bilge, won't be pumped overboard. More importantly, the Attwood S3 won't be fooled by splashing waves or water moving across the bilge in a rocking boat. Excessive pump cycling is a problem of the past when using the Attwood S3.

KEEPING THE CUSTOMER IN MIND

Attwood has incorporated several features into the housing of the S3 to accommodate just about every possible mounting configuration. The S3 can be hooked onto the side of the Tsunami series bilge pumps, can be mounted to the floor of the bilge or mounted to the side wall of a stringer without any additional brackets. Convenience and ease of installation come standard with the Attwood S3.

BUILT TO LAST

Backed by an industry leading 5-year warranty, Attwood's S3 series bilge switch incorporates a unique encapsulation process to protect all electronic components, utilizes high quality stainless steel components and incorporates a chemical resistant housing. More importantly, the Attwood S3 is free of any moving parts that can jam up, break or wear out over time. With minimal maintenance, you can expect the Attwood S3 to deliver throughout the life of your boat.

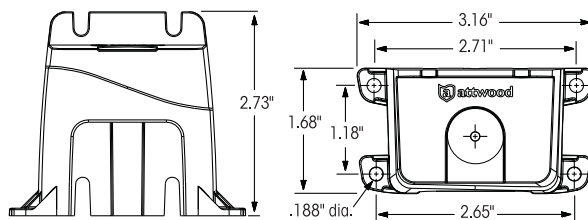

Description	Rated Voltage	Wire	Bulk Packaging	Aftermarket Packaging*
TS12	12V	36"	4801-1	4801-7
TS24	24V	36"	4802-1	4802-7

Available January 2009

*Clamshell