



Frosted Globe All-Round Light

5100, 5110, or 7100 Series Installation Instructions

SAVE THESE INSTRUCTIONS

Form Number 69367 Rev. B

03-10

CAUTION:

Read all instructions carefully before installing and using this product.

All positive (+12V DC) lighting wires require a 1-amp fuse to protect circuits and vessel. The aluminum light pole is not grounded. **MAKE SURE POWER SOURCE IS 12-VOLT DC ONLY. HIGHER VOLTAGE WILL DAMAGE LIGHT AND CIRCUITRY.**

WARNING:

To prevent injury, disconnect power when installing or servicing this product. Remove boat from water before using 120V power tools.

LOCATION

Frosted Globe All-Round Lights are designed for boats up to 39.4 feet (12m). Position the All-Round Light so its bulb is not less than one meter (39.4") above sidelights. If replacing an existing pole light, replace with a pole at least as long as the existing. Mount the light in a position that will allow the light to shine 360°, unobstructed. (See Figure 1)

Figure 1

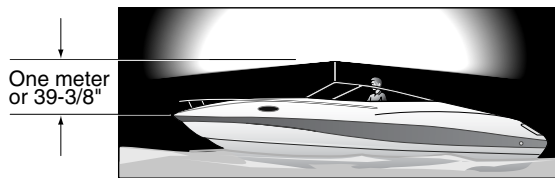

INSTALLATION

Lights that Include Stowaway Base

The Attwood 7100 Series All-Round Lights include a two-wire base with swing-away cover.

For detailed installation location, follow the standards of navigation rules. Figure 2 is a simplified drawing of sidelight and all-round light placement.

1. Choose a position near transom that is accessible to wiring and has clearance below deck (See Figure 2).

Figure 2

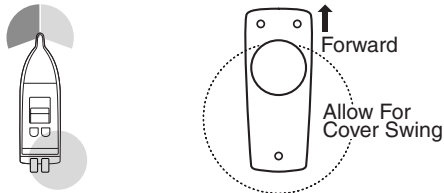

2. Place base on the gunwale or deck. At desired location, be sure there is room to rotate the cover. Mark position for the 1-3/8" socket hole.
3. Remove base and drill the 1-3/8" diameter socket hole, being careful not to crack the gel coat finish around the hole.
4. Fit base into socket hole so it is parallel to boat centerline. Mark position and drill the three screw holes.
5. Remove base and connect wires through socket hole. Connect one wire to the battery ground (-). Attach other wire to the 1-amp fused, positive (+) switched wire from the navigation light switch.
6. Apply sealant between deck and light base. Fasten base with three #10 stainless steel screws.

CAUTION: Do not overtighten screws.

Replacing Light Poles Without a Locking Collar (5100 Series)

1. Align pole screw with slot in the existing base. Insert pole into base (Figure 3).
2. Press down firmly to engage electrical connectors.
3. To remove pole, pull straight up.

Figure 3

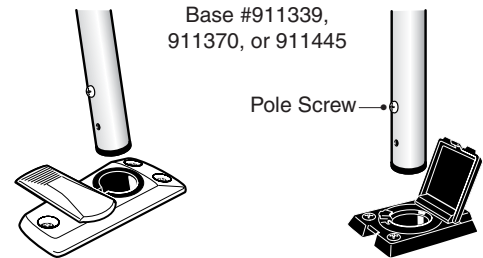

Replacing Light Poles With Locking Collar (5110 Series)

1. Align pole screw with slot in the base. Insert pole into base (Figure 4).
2. Press down firmly to engage electrical connectors.
3. Slide locking collar down to base, rotate until you can insert lower ring inside top of base.
4. Press collar down into base and rotate until it tightens between pole and base.

NOTE: Periodically check pole to make sure it is secure.

5. To remove light, rotate locking collar in opposite direction until it loosens, then pull up on pole.

Figure 4

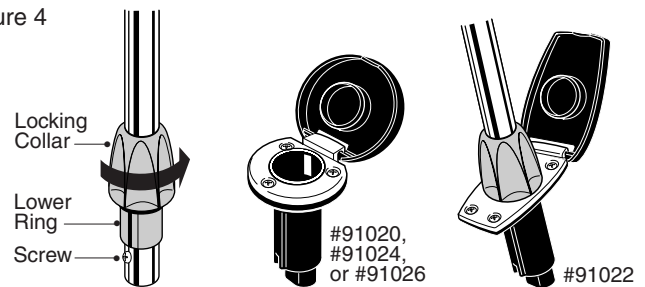

TO CONVERT POLE FOR USE WITHOUT LOCKING COLLAR

1. For bases that do not accept locking collar, remove screw at bottom of pole. Slide locking collar off end of pole.
2. Replace screw in the upper screw hole.

OPERATION

After installation, check lights to verify proper operation. Regulations require lights to be operated with a three-position switch for:

- Running lights (sidelights and all-round light)
- Anchor lights (all-round light only)
- Off

NOTE: Do not use light pole as a flagpole or handle.

MAINTENANCE

When not in use, store pole light in Pole Light Storage Clips (Attwood 7571). Choose a storage location where light will not be damaged or be in constant contact with water.

Replacing Bulb

1. Unscrew frosted globe counter-clockwise and remove.
2. Pull bulb straight up. Replace with #906 9-Watt Wedge Base Replacement Bulb (Attwood 9235-7) available in marine, auto, and convenience stores.
3. Screw lens clockwise onto pole.
4. If lens requires replacement, order Attwood #91017B.

Clean the light with a mild soap and warm water solution. Never use solvents or abrasives that may damage the lens or housing of the light.