

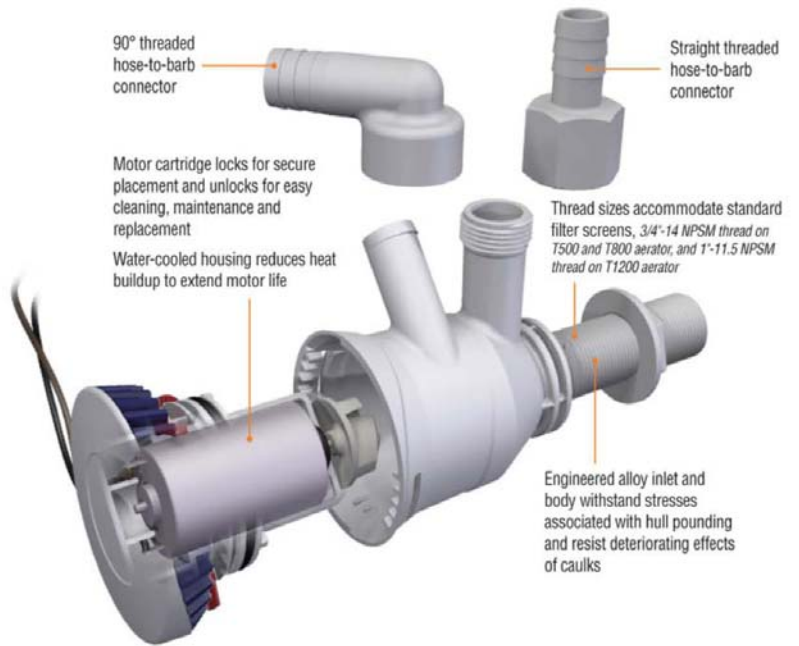

TSUNAMI DUAL OUTLET AERATOR PUMPS

The advantage of the dual outlet is that you can feed multiple applications through a single thru-hull fitting. The Tsunami second outlet is integrated into the pressure chamber, so it looks – and pumps – like part of the aerator. Both of the pump's outlets are engineered for the precise position and angle that will deliver optimum performance.



NMMA Numbers

Part No.	NMMA No.	IMCI (CE) Certificate No.
4672	Pending	IGPATT003
4670	Pending	IGPATT003

Specifications

Outlet	Amp Draw	GPH Output @ Design Voltage 13.6 VDC					GPH Output @ Nominal Voltage 12.0 VDC					Fuse Size	
		Both Outlets Open					Both Outlets Open						
		0 ft.	3.3 ft.	6.7 ft.	Max Head	0 ft.	Amp Draw	0 ft.	3.3 ft.	6.7 ft.	Max Head		0 ft.
Upper	3.0	750	600	460	13 ft.	880	2.5	670	500	390	11 ft.	770	4-amp
Lower	3.0	750	620	480	13 ft.	880	2.5	690	550	420	11 ft.	770	4-amp

Pump Dimensions

Part No.	Inlet Length	Inlet Dia.	A	B	C	D	E	F	G	H
4672	3-1/2"	3/4"	3-1/4"	3"	4-1/8"	4-1/4"	4"	3/4-14 NPSM	3/4" Barbed .554" I.D.	3/4-14 NPSM .620" I.D.
4670	3/4"	3/4"	1-1/4"	7/16"	4-1/8"	4-1/4"	4"	3/4-14 NPT	3/4" Barbed .554" I.D.	3/4-14 NPSM .620" I.D.

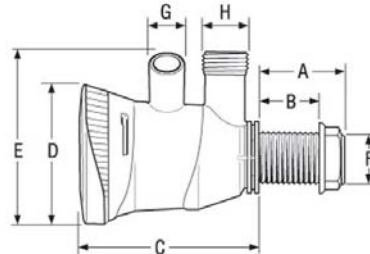

Applications

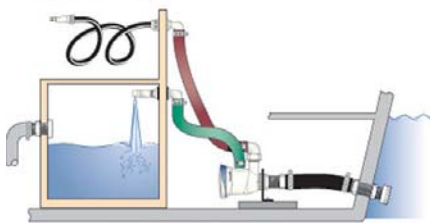

Rinse Hose plus Livewell

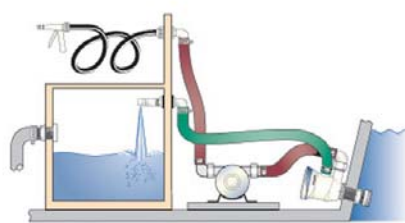

High Pressure Washdown plus Livewell

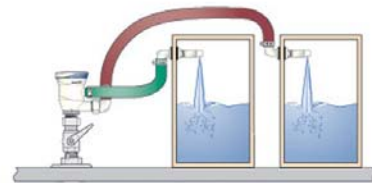

Supply Two Livewells