

EZ Mount Selector Battery Switch

771-S-EZ 400A EZ Mount Selector (Retail Packed)
771-S-EZ-B (Bulk Packed)

As easy to mount as 1, 2, 3, these revolutionary battery switches allow you to wire from the front.

1. Fit base
2. Add wiring
3. Clip on actuator

With their shared interconnection height, EZ-Mount Selector battery switches “cluster” directly with the Pro Installer Busbar Range, resulting in the fastest, most compact installations. All ratings, footprints and construction of the EZ-Mount Selector switches match the high quality of our standard switches.

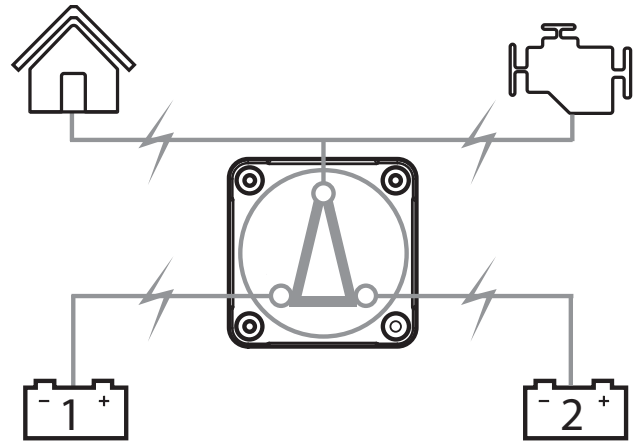

Features & Benefits:

- Easiest surface mounting, saves installation time and cost
- Front access studs match Pro Installer Busbar range interconnection height for direct linking and most compact mounting footprint
- Actuator assembly can be fitted at any 90 degree angle for optimal cabling flexibility
- Removable knob for isolation/safety
- Includes back cover and three side panels for security and cable protection
- Designed to withstand harsh marine environments
- High temperature reinforced plastics

Specifications:

- Continuous rating: 400A*
- Intermittent rating (5 minutes): 600A*
- Cranking rating (10 seconds): 1500A*
- Connection stud size: M10 (3/8")
- 12-48V DC
- IP66 – protection from powerful water jets
- Ignition protected
- Independently tested to meet UL1107 standards
- CE

* Electrical ratings achieved using cable size 120mm²

Installation Instructions: IMPORTANT! Read before installing

- It is recommended that electrical terminations and connections are carried out by a marine electrical technician.
- These battery switches are for isolation purposes and are not designed for switching under load.
- Ensure there are no circuits with high inductive loads directly connected to the switch in order to prevent any sudden in-rush of current which may cause damage to the switch.
- Although specially selected chemical resistant materials have been used, we recommend that for maximum product life only plastic safe corrosion inhibiting sprays are used.
- Ensure all cables are sized correctly for the loads they carry. Please refer to www.bepmarine.com to calculate correct cable sizes.
- Ensure all electrical connections are correctly tightened to prevent any damage to the battery switch.
- **WARNING:** Do not switch battery switch to off position while the engine is running.

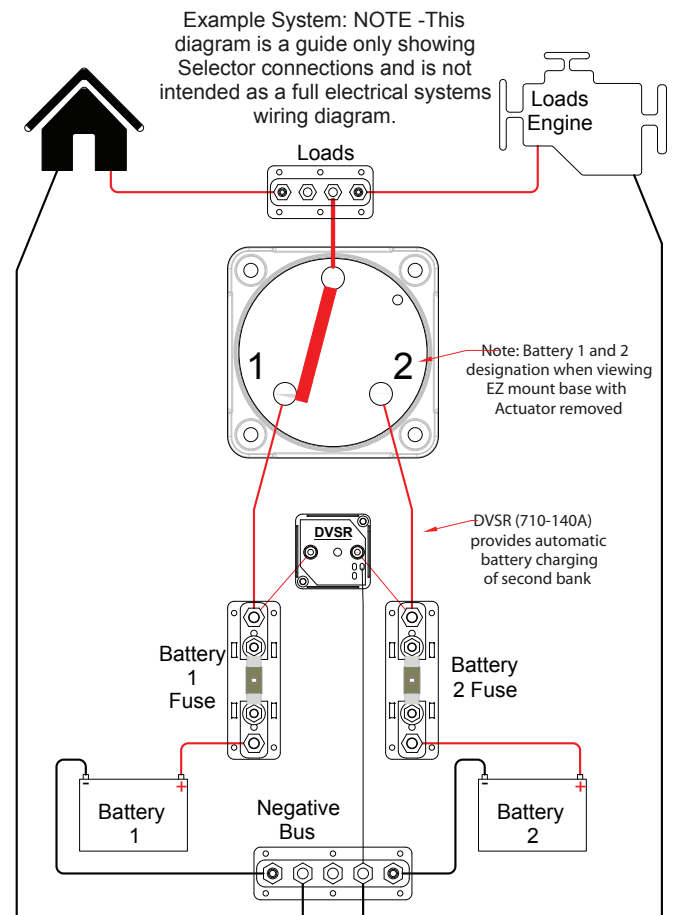
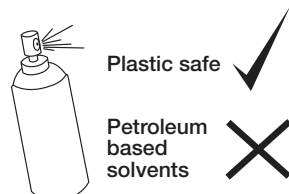

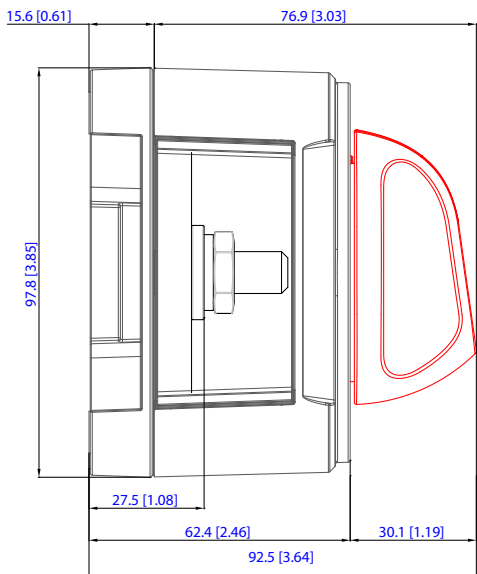
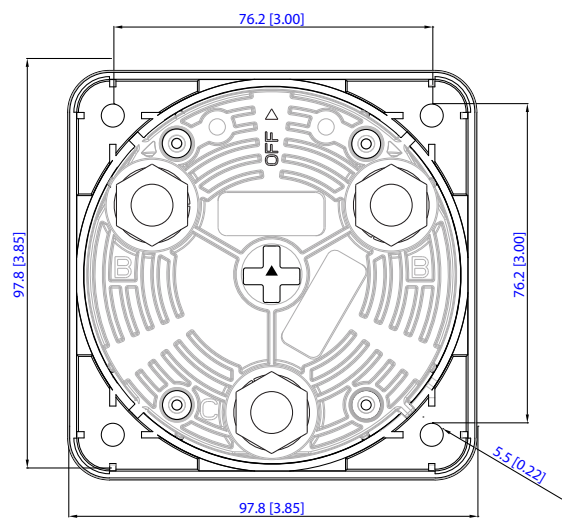

Learn more about marine electrical distribution we have.