



**CargoBuckle** ®

**BoatBuckle** ®

Advanced Tie-Down Solutions

## Advanced Tie-Downs & Accessories

### CargoBuckle

CargoBuckle Brand Tie-Down Systems offer high quality, innovative solutions for securing and towing gear in the powersports, automotive, hardware, material handling and assisted living markets. From innovative retractable tie-down systems to custom strap assemblies, CargoBuckle products provide the utmost in durability and convenience.

<b>Description</b>	<b>Page</b>
Retractable Ratchet Tie-Downs .....	1-2
Retractable Ratchet Adapters & Accessories .....	3
Light-Duty Tie-Downs .....	4
Medium-Duty Tie-Downs .....	5
Tow Strap .....	6

### BoatBuckle

BoatBuckle Brand Tie-Down Systems offer professional fishermen and weekend boaters convenient, high quality tie-down systems so they can spend more time on the water and less time on the boat ramp. IMMI is the leading marine tie-down manufacturer in North America.

<b>Description</b>	<b>Page</b>
Retractable Tie-Downs .....	7-8
Rod Tie-Down Systems .....	9
Hook & Loop Products .....	10
Pro Series Tie-Downs .....	11
Kwik-Lok Tie-Downs .....	12-13
Ratchet & Cam Buckle Tie-Downs .....	14
Gunwale Tie-Downs .....	15

<b>Description</b>	<b>Page</b>
Winch Straps .....	16
PWC Winch Straps & Tri-Downs .....	17
Miscellaneous Tie-Downs .....	18
Miscellaneous Bulk Products .....	19
CAPE - Center for Advanced Product Evaluation ...	20



## Retractable Ratchet Tie-Downs

The CargoBuckle Retractable Ratchet tie-down system takes the hassle out of securing gear. Longer, heavier web enables you to tie down more equipment in more applications, conveniently and securely. Just hook, ratchet and go!

All CargoBuckles can be permanently mounted with one bolt on a trailer, toy hauler, cargo rack, lift, truck, ladder rack and in various other applications.

- Permanent one-bolt installation
- Six-foot reach, self-retracting web
- Anti-corrosive construction
- Dual safety lock security
- Seat belt quality, polyester web
- Interactive display package
- Optional adapters available to enable mobility

For added versatility and convenience, the 1" Mini with Dual S-Hooks offers an attached vinyl-coated S-hook with keeper to provide an easy hook-up for any non-permanent mounting.



### *2" RETRACTABLE RATCHET TIE-DOWN*

#### **F18800**

2 per Interactive Display  
Case Quantity 4

#### **F101867** Bulk single item

No hardware  
Case Quantity 12  
Length up to 72 in.  
Break Strength 3,500 lbs./ea  
SWL 1,167 lbs./ea

### *1" MINI RETRACTABLE RATCHET TIE-DOWN*

#### **F103745**

2 per Interactive Display  
Case Quantity 4

#### **F103745BU** Bulk single item

No hardware  
Case Quantity 24  
Length up to 72 in.  
Break Strength 1,400 lbs./ea  
SWL 466 lbs./ea.

### *1" MINI WITH DUAL S-HOOKS*

#### **F111640**

2 per clam package  
Case Quantity 4

#### **F111640BU** Bulk single item

No hardware  
Case Quantity 12  
Length up to 72 in.  
Break Strength 1,400 lbs./ea  
SWL 466 lbs./ea.

## Retractable Ratchet Tie-Downs

### Innovation At It's Best

At CargoBuckle®, we are continually striving to design products for your safety and convenience. The Flush Mount System is no exception with the ever popular CargoBuckle Retractable Ratchet Tie-down conveniently tucked away in a durable, corrosion-resistant housing, to be instantly ready when you need it, and neatly concealed when you don't!

Let your customers experience CargoBuckle quality for themselves with our attractive, space-saving display.



### FLUSH MOUNT SYSTEM

#### F18804

Depth 4.5"  
Break Strength 3,500 lbs./ea  
SWL 1,167 lbs./ea  
1 per Carton  
Case Quantity 4

### FLUSH MOUNT DISPLAY UNIT

#### F18804D

Contains:  
-1 Flush Mount unit  
-1 Product Display  
-1 Header Card  
Case Quantity 1

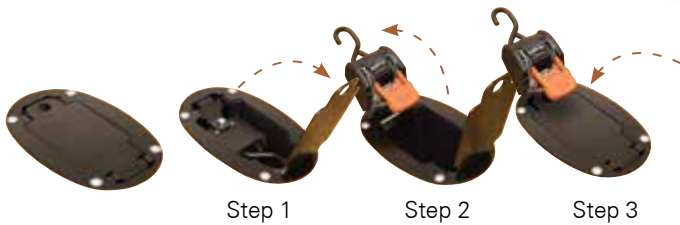

Valuable equipment is held securely with 7 feet of professional quality web and a strong double J-hook. Systems are available to accommodate square racks and virtually all sizes of round racks. Each system includes a Retractable Ratcheting Tie-Down, a ladder rack adapter and mounting hardware.

The Round Ladder Rack System includes spacers to accommodate 1 1/4" and 1 3/4" tubes.



### SQUARE LADDER RACK SYSTEMS

#### F18816

1.25" 2 pack  
Case quantity 4  
Length 7.0 ft.  
Break Strength 2,000 lbs./ea  
SWL 677 lbs.

### ROUND LADDER RACK SYSTEMS

#### F18821

2.0" 2 pack  
Case quantity 4  
Length 7.0 ft.  
Break Strength 2,000 lbs./ea  
SWL 677 lbs.



Fits 1 1/4", 1 3/4", 2.0" tubing.

If permanent mounting is not desired, any CargoBuckle retractable product can be used in conjunction with one of several optional adapters to enable portability.



**S-HOOK ADAPTER STRAP**

**F14086** Length 9.5"  
Break Strength 2,500 lbs./ea  
SWL 833 lbs.  
2 per clam package  
Case Quantity 12

**FLOOR MOUNTING BRACKET**

**F16777**  
Break Strength 2,500 lbs./ea  
SWL 833 lbs.  
2 per clam package  
Case Quantity 12

**E-TRACK ADAPTER STRAP**

**F14087** Length 7.0"  
Break Strength 2,500 lbs./ea  
SWL 833 lbs.  
2 per clam package  
Case Quantity 12

**SOFT LOOP HOOK CONVERTERS**

**F126817** Length 1" x 15"  
Break Strength 3,500 lbs./ea  
SWL 1167 lbs./ea  
2 per package  
Case Quantity 20

**PVC PROTECTIVE PADS**

**F13274** For use on 1" web  
**F13180** For use on 2" web  
2 per clam package  
Case Quantity 12

## Light Duty Tie-Downs

### Cam & Lift-Release Tie-Downs

When the tie-down application calls for quick and easy adjustment, look no further. Our cam and lift-release buckles provide a fast lock, along with a simple release.



#### *CAM BUCKLE TIE-DOWN VALUE PACK*

##### **F12637**

1.0 in. x 6 ft.  
Break Strength 800 lbs.  
SWL 267 lbs.  
4 per clam package  
Case Quantity 10



#### *CAM BUCKLE SPORTS TIE-DOWN*

##### **F14061**

1.0 in. x 5.5 ft.  
Break Strength 1,200 lbs.  
SWL 400 lbs.  
2 per clam package  
Case Quantity 6



#### *CONTINUOUS LOOP RATCHET*

##### **F13757**

1.0 in. x 15 ft.  
Break Strength 1,000 lbs.  
SWL 333 lbs.  
Clam single item  
Case Quantity 6



Continuous Loop Ratchet

**Value Packs**

The Pro-Series Value Packs feature our SUR-Grip rubber coated handles for comfort and ease, offered in a convenient 4-pack for added value.

**Ratchet Tie-Downs**

The 1" ratchet tie-down features durable, nylon webbing with solid, double J-hooks and convenient keeper.

The multipurpose 2" ratchet features high-quality, corrosion resistant, solid steel core ratchet with vinyl-coated S-hooks.

**PRO-SERIES RATCHET TIE-DOWN VALUE PACK****F18744**

1.0 in. x 15 ft.  
Break Strength 1,500 lbs.  
SWL 500 lbs.  
Display Package 4-pack  
Case Quantity 6

**RATCHET TIE-DOWN VALUE PACK****F12636**

1.0 in x 15 ft.  
Break Strength 1,500 lbs.  
SWL 500 lbs.  
4 per clam package  
Case Quantity 10

**RATCHET STRAP W/ DOUBLE J-HOOKS & KEEPER****F14060**

1.0 in. x 12 ft.  
Break Strength 1,000 lbs.  
SWL 333 lbs.  
Clam single item  
Case Quantity 6

**MULTIPURPOSE RATCHET STRAP****F13758**

2.0 in. x 15 ft.  
Break Strength 2,500 lbs.  
SWL 833 lbs.  
Clam single item  
Case Quantity 6

### Heavy Duty Tow Strap With Reel-Smart Storage Case

NO MORE TANGLED TOW STRAPS!

Easy reel-and-store case fits under seat or in trunk for easy access. Heavy-duty, 2" web for maximum resistance to fraying or tearing.



Place loop end over knob and rotate to wind web.



### REEL-SMART TOW STRAP

#### F100014

2.0 in. x 20 ft.  
Break Strength 10,000 lbs.  
SWL 3,333 lbs.  
Self-storing case  
Case Quantity 4







## Boatbuckle® Retractable Tie-Down Systems

The Mini Retractable Ratchet Transom tie-down can be permanently mounted with one bolt to most boat trailers. Six feet of one inch webbing enables you to secure more equipment in more applications, conveniently and securely.

- Permanent one-bolt installation
- Self-retracting web
- Anti-corrosive construction



Universal Mounting Bracket for flexible mounting options.



### MINI RETRACTABLE TRANSOM TIE-DOWN

**F106877**

2 per Interactive Display  
Case Quantity 4

**F106877BU**

Bulk single item  
Case Quantity 12

Length up to 72 in.  
Break Strength 1,400 lbs./ea  
SWL 466 lbs./ea

### UNIVERSAL MOUNTING BRACKET KIT

**F14254**

Break Strength 5,000 lbs./ea  
SWL 1,666 lbs./ea  
Clam Kit  
Case Quantity 12

## Retractable Ratchet Tie-Downs

### Just hook, ratchet and go!

With automotive style webbing, anti-corrosive construction, and sturdy coated hooks, BoatBuckle Retractable Ratcheting Tie-downs are still the ultimate tie-down system in convenience, style and innovative trailer boat rigging! The Retractable Ratchet Transom and Bow Tie-downs are available in Standard and Stainless Steel for brackish or saltwater environments. Interactive display packaging allows consumers to experience the BoatBuckle quality before they buy.



### RETRACTABLE TRANSOM TIE-DOWN

#### **F08893** Standard

Length up to 43 in.  
Break Strength 2,500 lbs./ea  
SWL 833 lbs./ea  
2 per Interactive Display  
Case Quantity 4

#### **F14256** Stainless Steel

Length up to 43 in.  
Break Strength 1,500 lbs./ea  
SWL 500 lbs./ea  
2 per Interactive Display  
Case Quantity 4



### RETRACTABLE BOW TIE-DOWN

#### **F14220** Standard

Length up to 43 in.  
Break Strength 2,500 lbs./ea  
SWL 833 lbs./ea  
1 per Interactive Display  
Case Quantity 4

#### **F14393** Stainless Steel

Length up to 43 in.  
Break Strength 1,500 lbs./ea  
SWL 500 lbs./ea  
1 per Interactive Display  
Case Quantity 4



### RETRACTABLE GUNWALE TIE-DOWN

#### **F14221**

Length 2 in. x 38 in.  
Break Strength 2,500 lbs./ea  
SWL 833 lbs./ea  
2 per Interactive Display  
Case Quantity 4

Fits gunwale rails measuring 2" wide or less.

**RodBuckle®**

Designed by fishermen for fishermen, the RodBuckle Retractable Rod Hold-Down System is the most attractive and functional rod hold-down on the market for deck style fishing boats. The self-retracting strap extends a full 24 inches and securely locks into position on the deck. The PVC extrusion coated polyester strap grips rods and resists hook penetration. When not in use, it neatly retracts out of the way. Easy installation with mounting template included.



**Concealed Mounting Kit**  
Mounts the retractor inside of the gunwale.

**RODBUCKLE GUNWALE/DECK MOUNT****F14200**

Length 24 in.  
Clam single item  
Case Quantity 12

**RODBUCKLE CONCEALED MOUNTING KIT****F14202**

Clam Kit  
Case Quantity 12

**RodBunk** is the perfect solution for carrying rods in your SUV, truck or mini-van. Holds up to 7 rod and reel combinations either horizontally or vertically.

**RodBunk Deluxe** features an automotive grade snap-lock connector with built-in adjuster that makes hook-up and adjustment easy.

**RODBUNK**

**F17726** Standard  
Length 30 in. x 65 in.  
Display Kit  
Case Quantity 12

**RODBUNK DELUXE**

**F17727**  
Length 30 in. x 65 in.  
Display Kit  
Case Quantity 6

## Hook & Loop Tie-Downs

### HLS Series

We've added two great new "PLUS" features to this line of hook and loop hold-down products. SUR-Grip release handle allows for a comfortable, secure hold. Rubber grommets provide maximum protection by keeping metal hardware away from valuable equipment.

The Vertical Rod Hold-Down features two foam molded rod inserts that hold up to 8 rods. Innovative design conceals all mounting hardware.



Deck Mount Rod Hold-Down



### *VERTICAL ROD HOLD-DOWN*

#### **F15435**

Length 12 in.  
Clam Set  
Case Quantity 12

### *DECK MOUNT ROD HOLD-DOWN*

#### **F15433**

Length 10 in./6 in.  
Clam Set  
Case Quantity 12



### *STRETCH DECK MOUNT ROD HOLD-DOWN*

#### **F15434**

Length 12 in./6 in.  
Clam Set  
Case Quantity 12



Trolling Motor Tie-Down



### *TROLLING MOTOR TIE-DOWN*

#### **F15437**

Clam single item  
Case Quantity 12

All Pro-Series tie-downs feature a SUR-Grip Kwik-Lok buckle for maximum comfort. For added safety and security, the transom and gunwale tie-downs also come standard with Hi-Vis protective PVC pads and our Night Eyes reflective closure patch for increased visibility in low light conditions.

### Pro Series Kwik-Lok Transom Tie-Down

Provides zinc-coated steel trailer hooks and vinyl-coated steel top hooks which resist cracking and peeling.

### Pro Series Ratchet Tie-down

Offers protective web pad along with a molded SUR-Grip handle for greater ease in ratcheting.

### Pro Series Gunwale Tie-Down

Features vinyl-coated S-hooks with keepers as well as a built-in closure that stores excess web while trailering.



### PRO SERIES KWIK-LOK TRANSOM TIE-DOWNS

**F17631** 2.0 in. x 2.0 ft.

**F17632** 2.0 in. x 4.0 ft.

**F17633** 2.0 in. x 6.0 ft.

Break Strength 1,200 lbs./ea  
SWL 400 lbs./ea  
2 per Display package  
Case Quantity 12



### PRO SERIES RATCHET TRANSOM TIE-DOWNS

**F18740**

1.0 in. x 3.0 ft.

Break Strength 1,200 lbs./ea  
SWL 400 lbs./ea  
2 per Display package  
Case Quantity 12



### PRO SERIES KWIK-LOK GUNWALE TIE-DOWNS

**F17634** 2.0 in. x 10 ft.

**F17635** 2.0 in. x 13 ft.

**F17636** 2.0 in. x 16 ft.

**F17637** 2.0 in. x 20 ft.

Break Strength 1,200 lbs./ea  
SWL 400 lbs./ea  
1 per Display package  
Case Quantity 12



### PRO SERIES KWIK-LOK BOW TIE-DOWN

**F18741**

1.0 in. x 3.0 ft.

Break Strength 1,200 lbs.  
SWL 400 lbs.  
1 per Display package  
Case Quantity 12

## Kwik-Lok Tie-Downs

### Kwik-Lok® G2 Transom Tie-Down

Tired of scuffs and scratches on your boat from your standard transom tie-down? The Kwik-Lok G2 protects your boat by keeping all of the buckle hardware away from your boat's transom and placing it at trailer level. The Kwik-Lok G2 is the only transom tie-down on the market with a 360 degree rotating hook, ensuring an easy and secure attachment to virtually any trailer.



#### *KWIK-LOK G2 TRANSOM TIE-DOWNS*

**F13128** 2.0 in. x 2.0 ft.

**F13130** 2.0 in. x 4.0 ft.

Break Strength 1,200 lbs./ea  
SWL 400 lbs./ea  
2 per Interactive package  
Case quantity 12

### Kwik-Lok Transom Tie-Downs

These quality, Kwik-Lok buckle tie-downs feature protective web pad to keep buckle hardware from coming in contact with boat surfaces. The Kwik-Lok buckle tie-downs are available in 1" and 2" widths.

The Stainless Steel tie-downs offer BoatBuckle quality stainless steel components, right down to the rivets and springs.



#### *KWIK-LOK TRANSOM TIE-DOWNS*

**F13109** 1.0 in. x 4.0 ft.

**F13110** 2.0 in. x 2.0 ft.

**F13111** 2.0 in. x 4.0 ft.

**F13112** 2.0 in. x 6.0 ft.

Break Strength 1,200 lbs./ea  
SWL 400 lbs./ea  
2 per clam package  
Case Quantity 12

#### *STAINLESS STEEL KWIK-LOK TRANSOM TIE-DOWNS*

**F12613** 1.0 in. x 3.5 ft.  
Case Quantity 6

**F12065** 2.0 in. x 2.0 ft.

**F12066** 2.0 in. x 4.0 ft.

**F12067** 2.0 in. x 6.0 ft.

Break Strength 1,000 lbs./ea  
SWL 333 lbs./ea  
2 per Display package  
Case Quantity 12

**Embroidered Kwik-Lok Transom Tie-Down**

Customize your tie-downs with your own digitized logo or artwork.



**EMBROIDERED KWIK-LOK TRANSOM TIE-DOWNS**

**F07930** 2.0 in. x 2.0 ft.

**F07931** 2.0 in. x 4.0 ft.

**F07933** 2.0 in. x 6.0 ft.

Break Strength 1,200 lbs./ea  
SWL 400 lbs./ea  
Bulk pair  
Case Quantity 10

**Tune-Up Value Pack**

This kit is designed to promote three-point tie-down safety on your trailer with a transom tie-down, a bow tie-down, a winch strap with a FREE replacement bolt.



**TRANSOM TUNE-UP VALUE PACK**

**F14251**

Kit includes  
-2.0 in. x 4.0 ft. Kwik-Lok Transom tie-down  
-1.0 in. x 3.0 ft. Kwik-Lok Bow tie-down  
-2.0 in. x 20.0 ft. Winch Strap  
Clam kit  
Case Quantity 6



## Ratchet & Cam Buckle Tie-Downs



### HEAVY DUTY RATCHET TRANSOM TIE-DOWNS

**F14206** 2.0 in. x 2.0 ft.

**F14207** 2.0 in. x 4.0 ft.

**F14208** 2.0 in. x 6.0 ft.

Break Strength 2,500 lbs./ea

SWL 833 lbs./ea

2 per Clam package

Case Quantity 6

### RATCHET TRANSOM/UTILITY TIE-DOWN

**F14209**

1.0 in. x 3.5 ft.

Break Strength 1,200 lbs./ea

SWL 400 lbs./ea

2 per Clam package

Case Quantity 12

### CAM BUCKLE TRANSOM/UTILITY TIE-DOWN

**F05851**

1.0 in. x 5.5 ft.

Break Strength 1,200 lbs.

SWL 400 lbs.

2 per Clam package

Case Quantity 6





We offer a wide variety of top quality gunwale tie-downs. Choose from standard or camouflage web in 1" or 2" widths, Kwik-Lok or ratchet buckles, vinyl-coated steel S-hooks or zinc-coated double J-hooks. Let's not forget our highest quality stainless steel tie-downs.



**KWIK-LOK  
GUNWALE TIE-DOWNS**

**F13113** 2.0 in. x 10.0 ft.

**F13114** 2.0 in. x 13.0 ft.

**F13115** 2.0 in. x 16.0 ft.

**F13116** 2.0 in. x 20.0 ft.

Break Strength 1,200 lbs.

SWL 400 lbs.

Clam single item

Case Quantity 12

**STAINLESS STEEL KWIK-LOK  
GUNWALE TIE-DOWNS**

**F12069** 2.0 in. x 10.0 ft.

**F12070** 2.0 in. x 13.0 ft.

**F12071** 2.0 in. x 16.0 ft.

**F12072** 2.0 in. x 20.0 ft.

Break Strength 1,000 lbs.

SWL 333 lbs.

Clam single item

Case Quantity 12

**STAINLESS STEEL RATCHET  
GUNWALE TIE-DOWNS**

**F12597** 1.0 in. x 12.0 ft.

**F12598** 1.0 in. x 18.0 ft.

Break Strength 1,000 lbs.

SWL 333 lbs.

Clam single item

Case Quantity 6

## Winch Straps

### Winch Strap with Latch-Lok Technology

The industry's most innovative hook makes attachment easier than ever. Latch-Lok Technology allows you to simply push-on and squeeze-off. It boasts of 5,500 lb. polyester webbing with a convenient loop end.

The interactive package allows shoppers to try the easy Latch-Lok Technology for themselves.

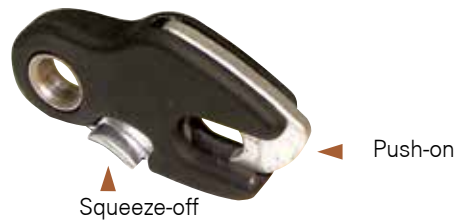

### WINCH STRAP WITH LATCH-LOK TECHNOLOGY

#### F17741

2.0 in. x 20.0 ft.  
Break Strength 4,000 lbs.  
SWL 1,333 lbs.  
Display single item  
Case Quantity 6



### Heavy-Duty Winch Straps

Designed for the heaviest of applications, the 2" heavy duty winch strap features 12,000 lb. polyester web and a 9,200 lb. forged steel snap hook.

### Winch Straps

Our boat winch straps feature up to 6,000 lb. polyester webbing and 9,200 lb. forged steel snap hooks. Choose from either 2" or 3"; loop or tail end style. Custom lengths and specifications available for OEM's.



### HEAVY DUTY WINCH STRAP WITH LOOP END

#### F14211

2.0 in. x 25.0 ft.  
Break Strength 8,000 lbs.  
SWL 2,667 lbs.  
Clam single item  
Case Quantity 12

### WINCH STRAP WITH LOOP END

**F14210** 2.0 in. x 15.0 ft.

**F05848** 2.0 in. x 20.0 ft.  
Break Strength 4,000 lbs.  
SWL 1,333 lbs.

**F14212** 3.0 in. x 20.0 ft.

**F14213** 3.0 in. x 25.0 ft.  
Break Strength 5,000 lbs.  
SWL 1,667 lbs.  
Clam single item  
Case Quantity 12

### WINCH STRAP WITH TAIL END

**F14214** 2.0 in. x 15.0 ft.

**F07674** 2.0 in. x 20.0 ft.  
Break Strength 4,000 lbs.  
SWL 1,333 lbs.  
Clam single item  
Case Quantity 12

**P.W.C. Winch Straps and Tri-Downs**

A built-in nylon soft-loop hook enables these tie-downs to attach to your P.W.C. without fear of scratching the gel coat.

**P.W.C. WINCH STRAPS****F14215** Tail End

2.0 in. x 15.0 ft.

**F14216** Loop End

2.0 in. x 15.0 ft.  
Break Strength 3,500 lbs.  
SWL 1,167 lbs.  
Clam single item  
Case Quantity 12

**P.W.C. CAM BUCKLE TRI-DOWN WITH SOFT HOOK****F10972BK**

1.0 in. x 6.0 ft.  
Break Strength 1,200 lbs.  
SWL 400 lbs.  
Clam single item  
Case Quantity 12

**P.W.C. RATCHET TRI-DOWN WITH SOFT HOOK****F14218**

1.0 in. x 8.0 ft.  
Break Strength 1,200 lbs.  
SWL 400 lbs.  
Clam single item  
Case Quantity 12



## Miscellaneous Tie-Downs



### Kwik-Lok Gas Tank/Battery Box Tie-down

This universal tie-down features durable 1" nylon webbing, sewn web pad and a Kwik-Lok buckle, along with a zinc-coated J-hook.

### Battery Box Tie-Down and Gas Tank Tie-down

Packaged with two polypropylene footmen loops and four stainless steel screws for permanent floor mounting.



### KWIK-LOK BOW TIE-DOWN

#### F12811

1.0 in. x 3.0 ft.  
Break Strength 1,200 lbs.  
SWL 400 lbs.  
Clam single item  
Case Quantity 20



### KWIK-LOK GAS TANK/ BATTERY BOX TIE-DOWN

#### F05343

1.0 in. x 4.0 ft.  
Clam single item  
Case Quantity 20



### GAS TANK/BATTERY BOX TIE-DOWN

#### F05352

1.5 in. x 6.0 ft.  
Clam single item  
Case Quantity 20



### BATTERY BOX TIE-DOWN

#### F05351

1.5 in. x 3.5 ft.  
Clam single item  
Case Quantity 20



### PROTECTIVE BOAT PADS

#### F13274 1 in.

#### F13180 2 in.

2 per clam  
Case Quantity 12



### SNAP-LOCK BOAT COVER TIE-DOWN

#### F14264

1.0 in. x 4.0 ft.  
6 pack clam  
Case Quantity 12

Bulk products are perfect in marine service centers and anywhere bulk displays and value oriented prices are key. We've hand picked our most popular items to make your job easier. Enjoy boating safely with our Retractable grab Handles.

### **Retractable Grab Handles**

IMMI is all about bringing safety to people. Our Retractable Grab Handles feature comfortable, contoured handles and a flush-mounted, recessed cavity that allows each handle to retract out of the way when not in use, providing a clean, attractive look. Stainless steel screws provided.



#### ***RETRACTABLE GRAB HANDLE LINEAR***

**F13664BU**

Bulk single item  
Case Quantity 20



#### ***RETRACTABLE GRAB HANDLE SPOOL***

**F12411**

Bulk single item  
Case Quantity 50



## **A One-of-a-Kind Test Facility**

At CAPE®, our commercial vehicle testing capabilities are unsurpassed. Awarded the Crash Test Facility of the Year by *Automotive Testing Technology International Magazine*, CAPE is the premiere test house for the commercial truck, fire apparatus, school bus, military, and motor coach industries.

With CAPE's one-of-a-kind crash test facility, you can count on quality, expertise, responsiveness, and precise results to best evaluate and validate your product's performance. That's what it means to be "CAPE Tested."



## **Built Big to Test Big**

CAPE built the biggest barrier block in the world to put some of the world's biggest vehicles to the test. Our findings have led to significant advancements in safety for the commercial trucking industry and the men and women who drive it forward.

Our modern, state-of-the-art facility is also home to a 90-degree dynamic rollover impact machine which enables us to study occupant protection in a rollover. Our findings led to IMMI's development of RollTek, the first sideroll protection system for commercial vehicles.

At CAPE, we know safety doesn't happen by accident. It happens when it's CAPE Tested.

## **Our Mission**

By God's grace, maintain a dynamic, growing business with a Christian impact...by developing and marketing quality products and providing services which enrich and protect the lives of those who use them throughout the world.

