



3" X 3" X 4" Wye Fitting

Part # 1200256

Centek WYE fittings are made from the same corrosion resistant high temperature resin used in Vernatube. Precise outer dimensions assure easy connections.

Fittings Family

MATERIALS AND CONSTRUCTION

Process	Filament Winding CNC, Resin Transfer Molding
Resin	Class 1 Fire Retardant Epoxy Vinyl Ester Thermoset
Glass	Corrosion-Resistant E Glass
Glass / Resin Ratio	60%

ATTRIBUTES

A1 & A2 - OD (IN / MM)	3.00 / 76
A3 - OD (IN / MM)	4.00 / 102
C - Lengthj (IN / MM)	14.00 / 356
H - Height (IN / MM)	9.30 / 236
Color	Standard Unpainted, White, Black; Gel-Coat; Yacht Quality; Yacht Quality Plus
Approvals	Lloyd's Register Type Approval
Flame Retardancy	UL94V-0

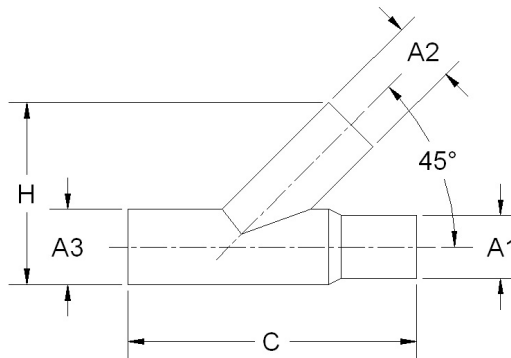

Learn more about boat exhaust systems we have.