



# 4" X 4" X 4" Wye Fitting

## Part # 1200316

Centek WYE fittings are made from the same corrosion resistant high temperature resin used in Vernatube. Precise outer dimensions assure easy connections.

Fittings Family

### MATERIALS AND CONSTRUCTION

Process	Filament Winding CNC, Resin Transfer Molding
Resin	Class 1 Fire Retardant Epoxy Vinyl Ester Thermoset
Glass	Corrosion-Resistant E Glass
Glass / Resin Ratio	60%

### ATTRIBUTES

A1 & A2 - OD (IN / MM)	4.00 / 102
A3 - OD (IN / MM)	4.00 / 102
C - Lengthj (IN / MM)	16.50 / 419
H - Height (IN / MM)	11.20 / 284
Color	Standard Unpainted, White, Black; Gel-Coat; Yacht Quality; Yacht Quality Plus
Approvals	Lloyd's Register Type Approval
Flame Retardancy	UL94V-0

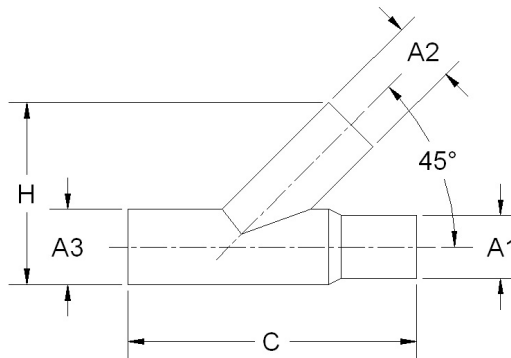

Learn more about boat exhaust systems we have.