

NavNet vx2 [Radar](#) Antenna Dimensional Drawings

18" Radome Antenna

4.9 kg 10.8 lb

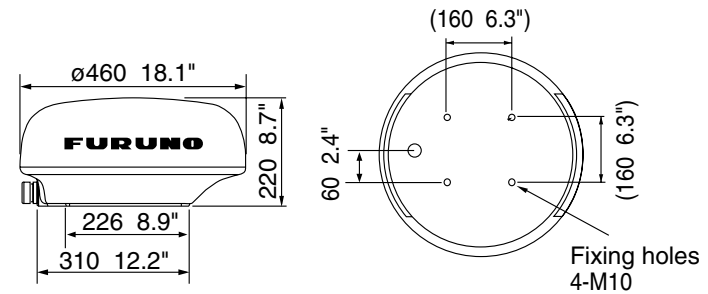

24" Radome Antenna

8 kg 17.6 lb

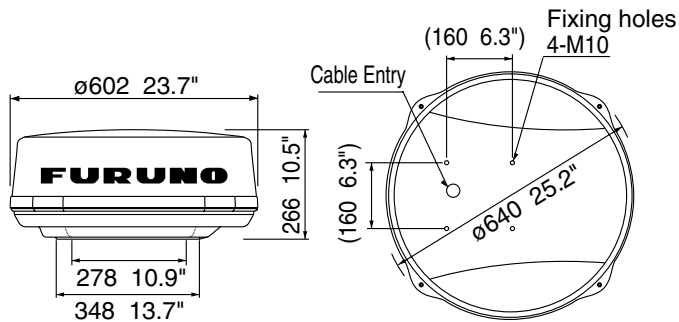

4 ft Open Antenna

23 kg 50.7 lb

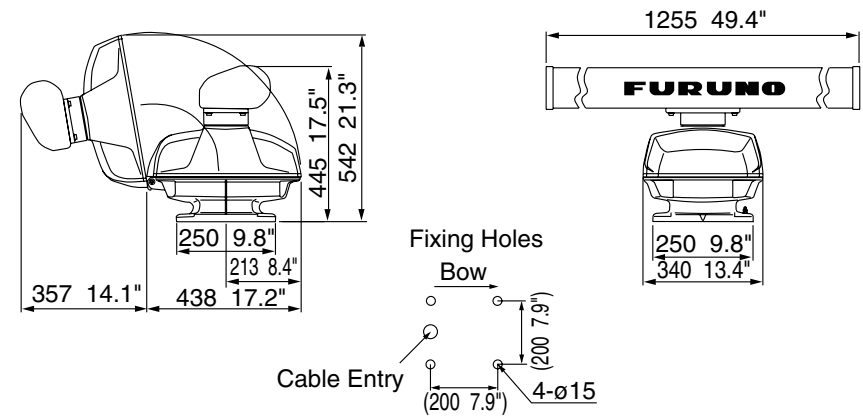

3.5 ft Open Antenna

22 kg 48.5 lb

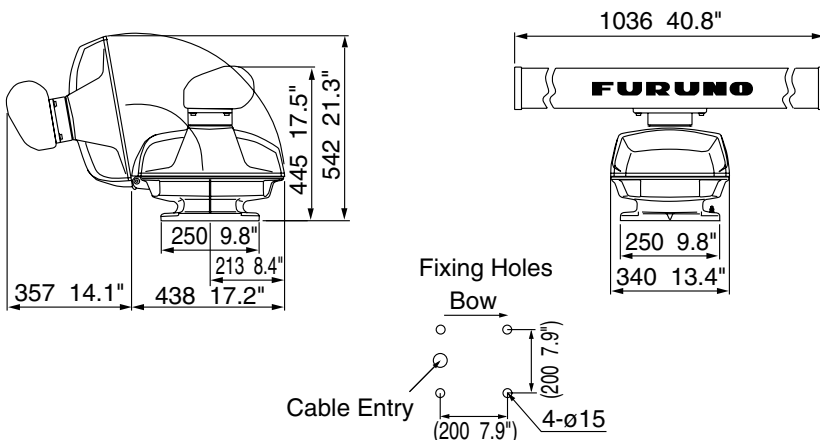

6 ft Open Antenna

25 kg 55.1 lb

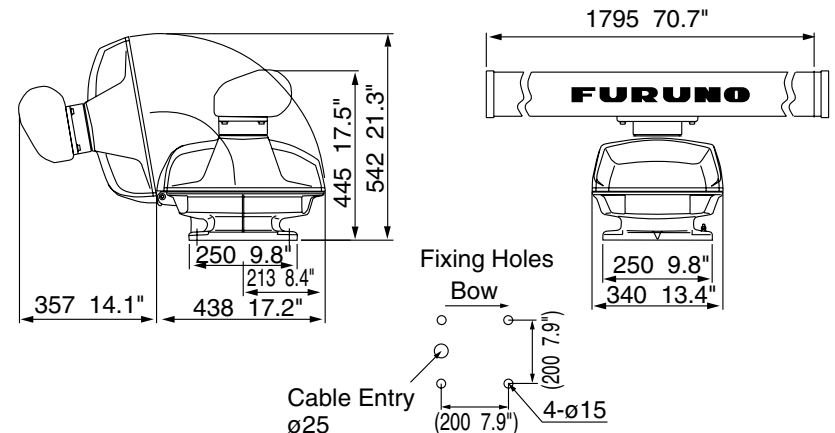

NavNet vx2 10.4" LCD Display

Dimensional Drawings

10.4" LCD (Bracket Mount)

6.0 kg 13.2 lb

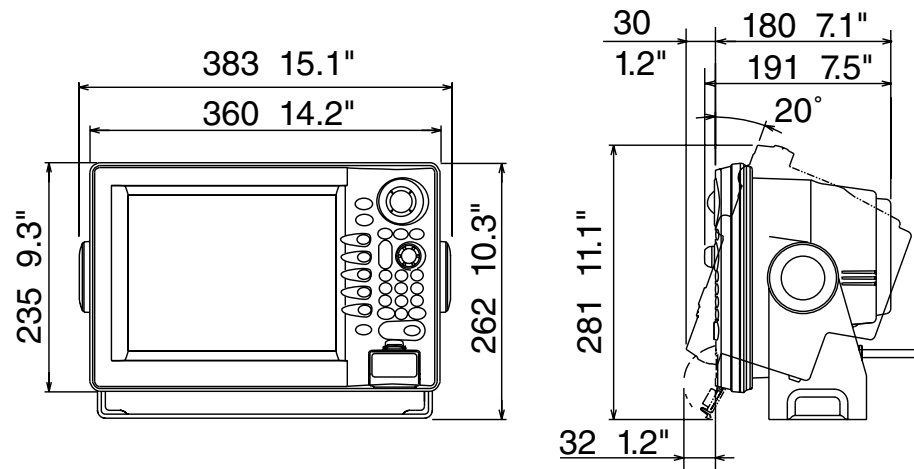

10.4" LCD (Flush Mount)

5.2 kg 11.5 lb

