

**PERFORMANCE:**

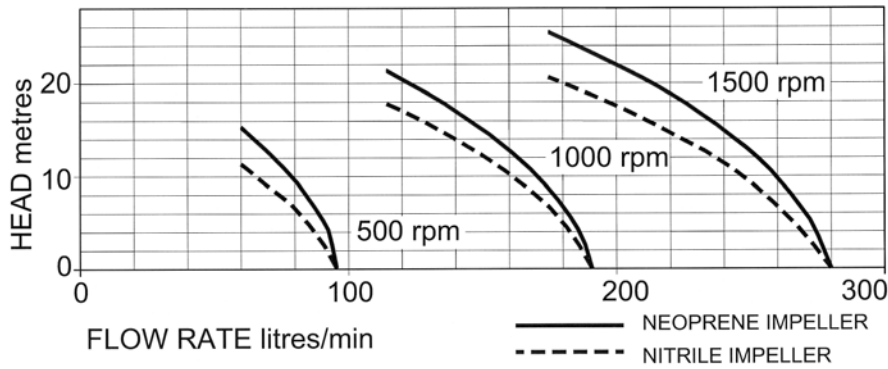

MODEL	Maximum flow rate		Maximum head	
	l/min	gall/min	metres	feet
<b>52270-2011</b>	300	66	25	82
<b>52270-2003</b>	300	66	20	65

Max Power absorbed 1800 watt at 1500rpm

**DIMENSIONS:**

**WEIGHT: 9Kg**

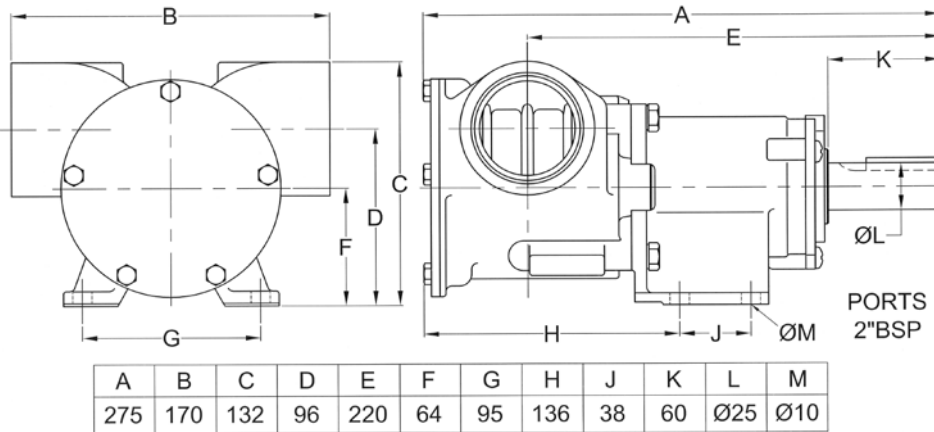

**MATERIALS OF CONSTRUCTION:**

<b>Body</b>	Bronze
<b>Impeller</b>	Neoprene or Nitrile
<b>Wearplate</b>	Replaceable
<b>Shaft</b>	Stainless steel type 316
<b>Shaft seal</b>	Mechanical, Carbon-Ceramic
<b>Bearings</b>	Twin row, ball type
<b>Port type</b>	2" BSP to BS21 (DIN2999)

**MODELS:**

**52270-2011** Standard Neoprene Impeller

**52270-2003** Oil resistant Nitrile

**52270-2021** High pressure Neoprene



a xylem brand

**BRONZE FLEXIBLE  
IMPELLER PEDESTAL  
PUMP**

**52270** SERIES



**PUMP with  
2" BSP PORTS**

- \* Constructed from marine quality bronze and stainless steel
- \* Self-prime from dry up to 3m
- \* Easy to service and maintain
- \* Will tolerate abrasive wear
- \* Handles hard and soft solids without clogging
- \* Can pump in either direction
- \* Will not airlock

