

KICKER[®]

KMC4 | *Media Center*

KMC4

Owner's Manual | English

mounting hole cutout template:
3 inches, 76.2 mm

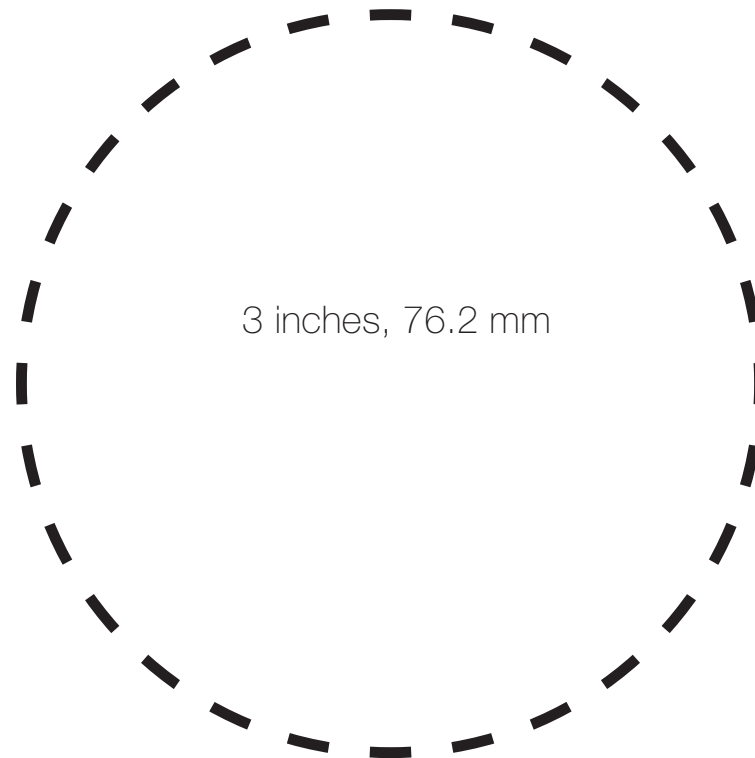

mounting hole cutout template:
3 inches, 76.2 mm

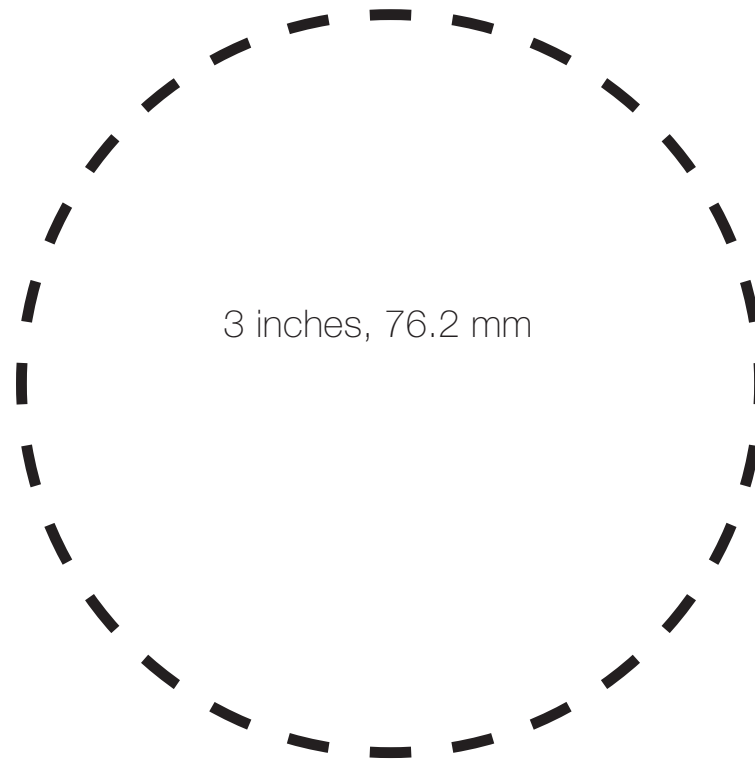



KMC4 OWNER'S MANUAL

Contents

Specs	5
Overview	6
Installation	7
Operation	10
Troubleshooting	11

SPECIFICATIONS

<i>Model</i>	<i>KMC4</i>
Power Output @ 14.4V, 2Ω stereo, <10% THD+N	38W x 4
Power Output @ 14.4V, 4Ω stereo, <10% THD+N	25W x 4
Frequency Response [Hz]	20 – 20k
Signal-to-Noise Ratio [dB]	100
Pre-Amp Outputs	Front, Rear, Sub, Zone2
Input Sensitivity	500mV
USB Playback	MP3/WMA/FLAC/AAC/WAV
USB Charging	DC 5V, 1A
USB Compatible File System	FAT32
IP Rating	IP66
Line-Out Level [V]	4
Outer Trim Dimensions[in, cm]	3.5 x 5.5, 8.89 x 13.97
Protrusion From Mounting Surface [in, cm]	1-1/8, 2.86
Total Mounting Depth [in, cm]	4-3/4, 12.07
Mounting Hole Diameter [in, cm]	3, 7.62

Authorized KICKER Dealer: _____

Purchase Date: _____

Serial Number: _____

Be careful not to drill into wiring or vehicle mechanisms. You are solely responsible for securely mounting the KMC4 Media Center. See page 2–3 for mounting hole cutout template.

Before installation, you may wish to plan your placement of the USB and Auxiliary inputs, and the optional KRC12 remote (sold separately), for both convenience and looks!

With a KICKER KXM amplifier, a pair of KICKER KM speakers, and a few KICKER cables, you're looking at a full system upgrade that will dominate! KICKER amplifiers and accessories make upgrading a snap. Ask your dealer about KICKER amplifiers and speaker upgrades to complete your system!

WARNING: KICKER products are capable of producing sound levels that can permanently damage your hearing! Turning up a system to a level that has audible distortion is more damaging to your ears than listening to an undistorted system at the same volume level. The threshold of pain is always an indicator that the sound level is too loud and may permanently damage your hearing. Please use common sense when controlling volume.

OVERVIEW

If the battery voltage is low (<+10.5V), an on-screen warning will appear.
Recharge battery and avoid becoming stuck or marooned.

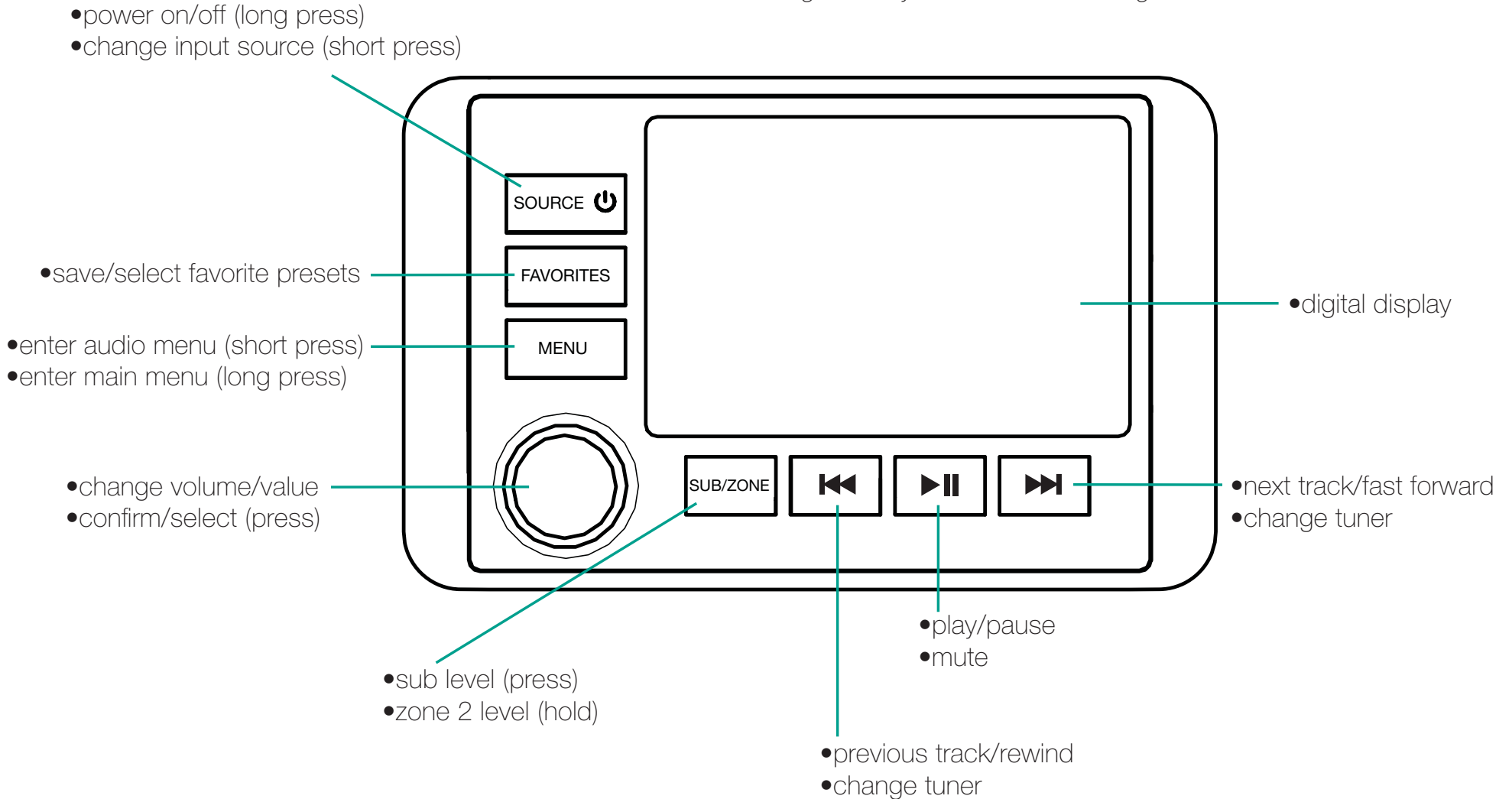

*NOTE: Use short and long presses to operate.
Some input sources do not support all functions.*

INSTALLATION

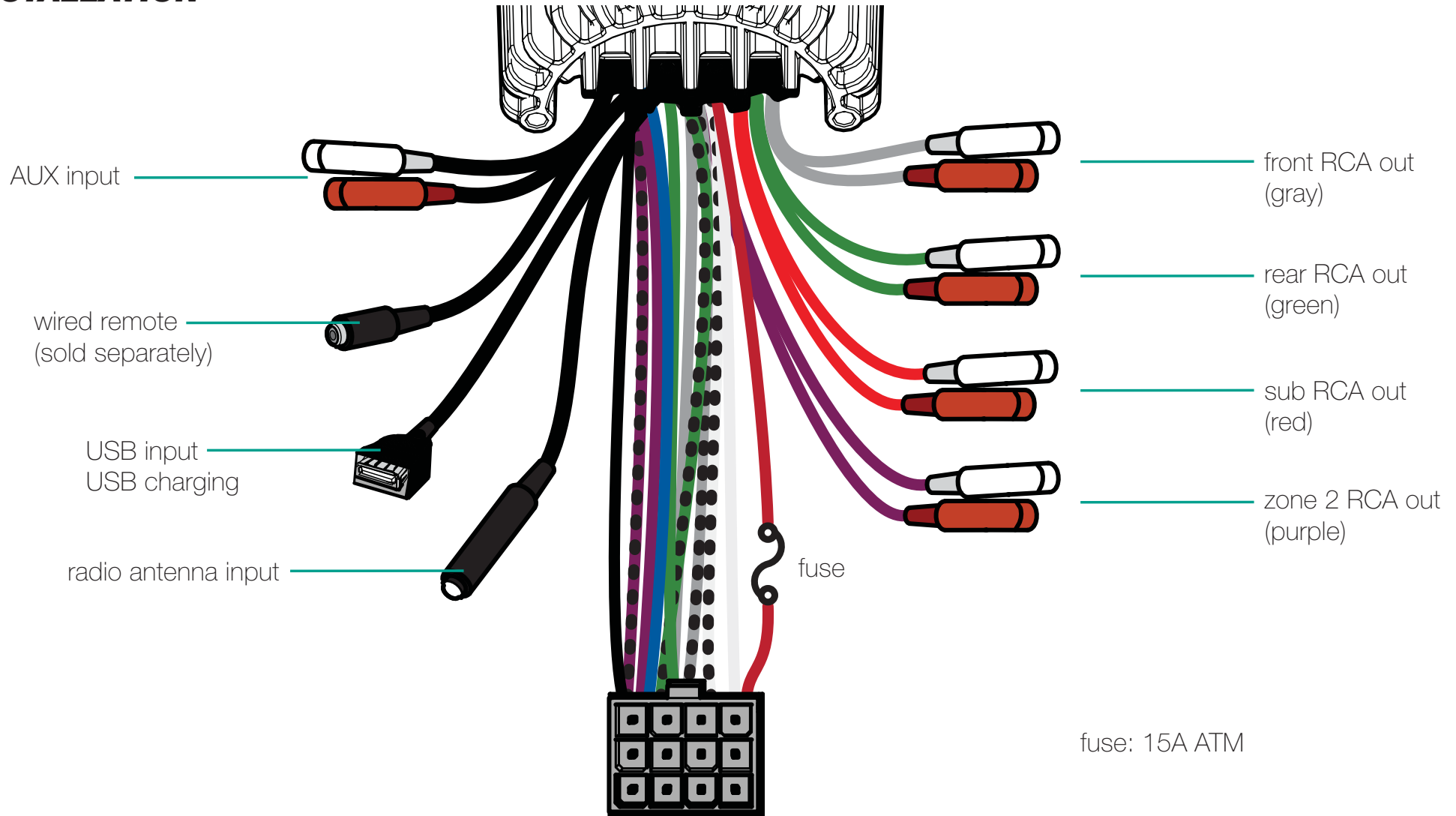

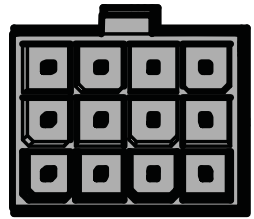

Remember to cap unused wires and avoid electrical shorts!

— positive
- - - negative

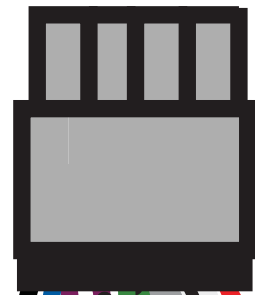

+12V (switched)

≤7"
18cm



ground

remote turn-on output

fuse

+12V

-

battery

ground

dimmer (leave disconnected if no dimmer circuit present)

rear right
(purple)

rear left
(green)

front right
(gray)

front left
(white)

- 1.** Remove adhesive from rear gasket and apply to the back of the KMC4.
- 2.** Securely fasten the KMC4 to the mounting surface using the including screws.
- 3.** Attach the snap-on trim ring to the front of the KMC4.

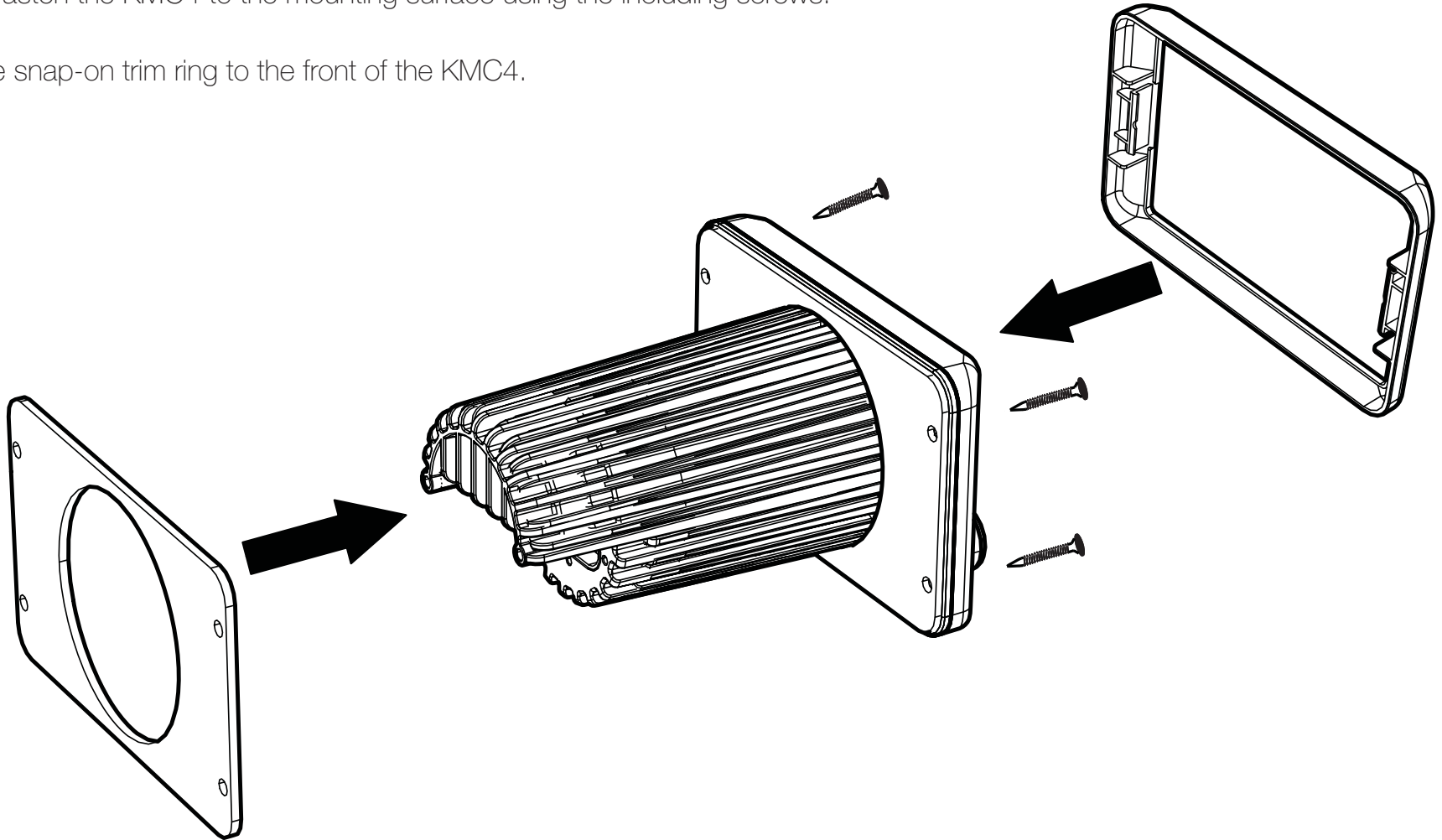

OPERATION

Playback

Use the **SOURCE** button to choose the input source for the KMC4: Bluetooth, USB, AUX, AM, FM, and WX. Press the **SUB/ZONE** button to change Subwoofer output volume; Hold the **SUB/ZONE** button to change the Zone2 output volume.

The KMC4 will automatically enter Bluetooth pairing mode when there is no Bluetooth connection, with the display message “In Pairing Mode”. Hold the **FAVORITES** button to manually disconnect from a paired device and re-enter pairing mode. When you begin scanning for devices on your audio device, the KMC4 will identify as “Media Center”.

Set favorite presets for your favorite AM, FM, and WX stations by selecting the station, pressing the **FAVORITES** button, selecting the favorite number (1–10) you wish to set, and pressing and holding the **VOLUME KNOB** for 2 seconds.

The USB input source is only available when there is a USB device connected. The KMC4 will automatically switch to USB input when a USB device is connected and detected. KICKER recommends SANDISK drives for the best performance. Drives must be formatted in FAT32 file system. USB hubs are not compatible. High-bit rate files (320kbps) may experience errors. In testing, the KMC4 has been shown to work with some HDD's and other file systems, however, this is *not supported by KICKER!*

Device Settings

Hold the **MENU** button to enter the device settings menu. Press the MENU button to enter the audio settings. The available settings are: Loud, Area, Beep, Zone2, Z2VOL, HPF, and Dimmer. Use the **VOLUME KNOB** to change the available values for each setting.

LOUD - select On or Off for a low frequency boost

AREA - select North America or Europe

BEEP - select whether the KMC4 responds with beeps

Zone 2 - toggles Zone 2 volume control on/off

Z2VOL - change behavior of Zone 2 volume control:
Relative: Zone 2 volume is locked to main volume.

Absolute: Zone 2 volume is adjusted independently of main volume

HPF - hi-pass crossover: OFF, 50Hz, 80Hz, 120Hz

Dimmer - adjusts screen and button brightness: 1–10

Audio Settings

Press the **MENU** button to begin cycling through the audio settings menu. Press the MENU button to enter the audio settings. The available audio settings are: Bass, Treble, Balance, Fader, and EQ. Use the **VOLUME KNOB** to change the available values for each setting.

EQ - select between EQ presets: Flat, Classical, Pop, Rock, Off, and Custom

When Custom EQ is selected, press the **MENU** button to enter custom frequency adjustments for 60Hz, 250Hz, 500Hz, 1kHz, 3kHz, and 8kHz.

TROUBLESHOOTING

If your KMC4 does not appear to be working, check the obvious things first such as blown fuses, poor or incorrect wiring connections etc. If you're using an amplifier, check for incorrect setting of crossover switches and gain controls etc.

No Power? ❶ Press the SOURCE/POWER button and make sure the KMC4 is turned on. ❷ Check the +12V power wire, ground wire, and fuse(s) for power and proper connection.

No or low output? ❶ Check the balance control on the KMC4. ❷ Check the speaker output connections. ❸ Power cycle the KMC4. ❹ Check the volume of the audio source.

Reduced volume? Reverse a speaker connection from positive to negative on the stereo channel(s); if the volume improves, the speaker was out of phase.

Buttons/Device Unresponsive? Perform Factory reset.

Factory reset: Reset the KMC4 to factory default settings by pressing and holding the **PLAY/PAUSE** button for ten seconds.

Radio stations not being received? ❶ Check volume of audio source. ❷ Check the antenna for proper connection and ensure the **AREA** setting in the menu is set to the correct region.