



TEAM LEW'S HYPERMAG
SPEED SPOOL® SLP

TLH1SH, TLH1XH

11 Bearing System
C45 CARBON



Reel Specifications

Model	Weight (oz.)	Gear Ratio	Line Capacity (yd./lbs.)	RPT* (in.)
TLH1SH	5.4	7.5:1	110/12	30
TLH1XH	5.4	8.3:1	110/12	33

*Recovery per turn.

FEATURES:

- 11-bearing system with stainless steel double shielded ball bearings and Zero-Reverse one-way clutch bearing
- One-piece, lightweight Magnesium frame
- Speed Dial line recognition system
- Speed Keeper hook keeper
- Lightweight double anodized aluminum spool
- Lightweight C45 Carbon sideplates
- SpeedCast® externally Adjustable Centrifugal Brake System
- Smooth carbon fiber drag system provides up to 20 lbs. drag po
- Titanium-coated Zirconia line guide
- External lube port

Performance – Right out of the Box!

Your Speed Spool® reel is designed for performance and functionality. From the way it conforms to your hand, to the way it reacts crisply and effortlessly to your command, you'll know the minute you grab onto your Speed Spool® that you've got a quality reel. Your Speed Spool® reel exploits several new developments which will allow you to set yourself apart from the competition.

High Strength Aluminum Gearing The drive gear, crankshaft, and worm shaft are made of high strength aluminum for increased strength and durability. In addition to these advantages, aluminum provides exceptionally low friction to enhanced efficiency.

Machined Aluminum Spool  **Lightweight Double Anodized Aluminum Spool**
The spool on your Lew's® reel has been engineered to maximize casting distance. Anodized to withstand oxidation and abrasion, machined and built for deep capacity.

One-piece Magnesium Frame Your Speed Spool® reel utilizes a one-piece, lightweight Magnesium frame that is both lightweight and strong, so you'll never have to worry about frame torque or twisting.

SPEED DIAL  **Line Recognition** Your Speed Spool® reel features a convenient line indicator dial on the spool's tension knob. Quickly recognize what line type and line weight you have loaded on your reel.

SPEED KEEPER®  **Hook Keeper** The innovative Speed Keeper® hook keeper gives convenience a whole new meaning. Swing it out and secure your hook, swing it back and it conveniently tucks back under the reel when not in use.

ZERO  **REVERSE Bearing** The handle on your Speed Spool® reel will only rotate forward for rock solid hook setting. When you release the handle it will hold its position because of the Zero-Reverse bearing, never losing an inch on your catch; an invaluable property to have when you're pulling it in.

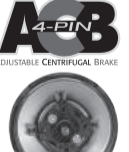
SpeedCast®
ACB  **Externally Adjustable Centrifugal Brake System** The SpeedCast® Adjustable Centrifugal Brake System delivers an extreme range of braking power from free spool to maximum by simply clicking its external dial to choose among 27 variable settings. The ACB system puts you in control of your casts, perfectly aligning brake power to conditions. With this system you will have more casting control over light lures, while maximizing casting distance with all lures.

Cast Control System A second feature exists to prevent backlash, the Cast Control System. An adjustment knob is found next to the star drag. The function saddles the spool shaft with steady pressure in order to stabilize spool speed.

To calibrate the system, reel your lure in until it rests on the tip of the rod, then tighten the knob until taut. Depress the thumb bar, and holding the rod horizontally loosen the knob slowly until the lure begins to descend. The spool should continue to spin after the lure contacts the ground, but should not complete more than one full rotation. If the spool does not continue to spin, the knob is too tight. If the spool completes more than one rotation, the knob is too loose. Repeat until you have achieved the desired results.

winn  **Bowed 95MM Carbon Fiber Winn® Handle** Our 95 mm bowed carbon fiber handle will give you all the cranking power you need. The Winn® Dri-tac handle knobs are an added bonus known for a comfortable grip for all day fishing.

Speed Spool SLP Baitcast reels are designed to be **Super Low Profile**.
Driven by innovation – Fueled with Passion
Feel the Difference!

ATTENTION BRAIDED LINE USERS!

If your Lew's® Baitcast reel has pre-drilled holes in the spool, you may tie your braid directly to the spool, by passing the braid thru the provided holes and tying a uni-knot.

If your Lew's® baitcast reel does not have pre-drilled holes in the spool, you will need to first tie on and spool at least 20 revolutions of monofilament line, and then tie your braided line to the monofilament line, with either a back-to-back uni-knot or an Albright knot.

Continue to spool your reel as normal, keeping strong tension on the line to ensure the line is properly wound onto the spool to keep from "digging in" to underlying line layers when pressure is on the line from fighting fish.

LURE TO PROPERLY SPOOL BRAIDED LINE ONTO YOUR REELS SPOOL WILL RESULT IN LINE PPAGE, AND THE IMPRESSION YOUR DRAG IS NOT WORKING PROPERLY.



TEAM LEW'S™ HYPERMAG
SPEED SPOOL® SLP
 TLH1SH, TLH1XH

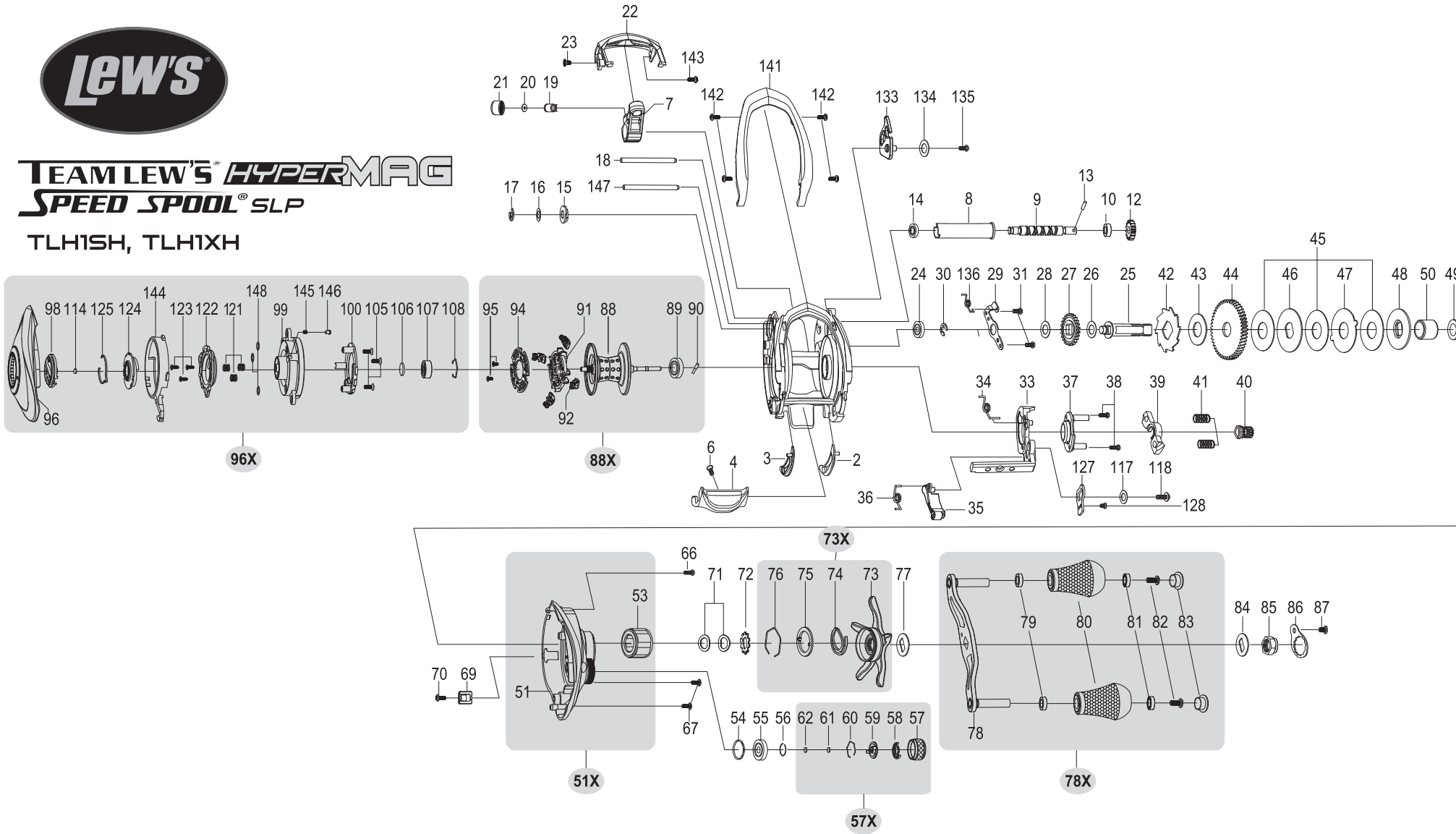
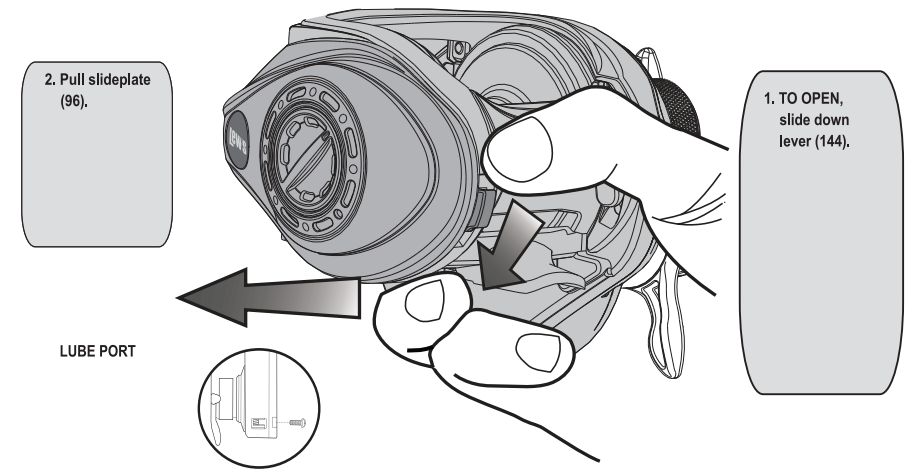

fig 1 To remove palming sideplate slide down lever (144) and pull slideplate off (96).



Maintenance and Care

When applying lubricant to your Speed Spool reel, avoid using multi-purpose oil. Use lightweight oils or greases made for fishing reels. Apply oil to all bearings, the crankshaft and the worm gear. Apply grease to the bushings, pinion gears, drive gears, and crank gears.

After usage, your reel should be inspected for dirt or sand and cleaned if excessive build-up is present. If your reel has come in contact with saltwater it is important to flush all parts with water, dry and re-lubricate your reel. Through diligent cleaning and maintenance your Lew's reel will provide you with years of reliability and sound performance.

KEY #	PART NAME	KEY #	PART NAME	KEY #	PART NAME
1	FRAME ASSEMBLY	46	DRAG WASHER(D1)	88X	SPOOL ASSEMBLY
2	CLUTCH BAR PLATE-R	47	DRAG WASHER (A)	89	BALL BEARING
3	CLUTCH BAR PLATE-L	48	DRAG WASHER (D2)	90	PIN
4	CLUTCH BAR	49	SLEEVE WASHER (OPTIONAL)	91	BRAKE HOLDER
6	CLUTCH BAR SCREW	50	SLEEVE	92	BRAKE SHOE ASSEMBLY (4)
7	LEVEL WIND ASSEMBLY	51	GEAR SIDE PLATE	94	BRAKE HOLDER PLATE
8	PIPE	51X	GEAR SIDE PLATE ASSEMBLY	95	BRAKE HOLDER PLATE SCREW (2)
9	WORM SHAFT	53	ONE-WAY CLUTCH	96	PALM SIDE PLATE
10	BALL BEARING	54	O-RING	96X	PALM SIDE PLATE ASSEMBLY
12	IDLER(S)	55	BALL BEARING	98	CONTROL DIAL
13	WORM SHAFT PIN	56	BEARING RETAINER	99	SPOOL COVER
14	BALL BEARING	57	CAST CONTROL CAP	105	SPOOL COVER SCREW (3)
15	WORM SHAFT BUSHING (B)	57X	CAST CONTROL CAP ASSEMBLY	106	SPOOL SPACER (A)
16	WORM SHAFT WASHER (OPTIONAL)	58	CLICKER	107	BALL BEARING
17	E-RING	59	CLICK PLATE	108	BEARING RETAINER
18	PILLAR	60	CLICK PLATE RETIANER	114	WASHER (OPTIONAL)
19	LEVEL WIND PIN	61	TENSION WASHER	117	CLUTCH WASHER
20	SPACER (OPTIONAL)	62	SPOOL SPACER (B)	118	CLUTCH SCREW
21	LEVEL WIND NUT	66	GEAR SIDE PLATE SCREW (A)	120	BRAKE PLATE HOLDER ASSEMBLY
22	FRONT COVER	67	GEAR SIDE PLATE SCREW (B)	121	SLIDE CAM SPRING (3)
23	FRONT COVER SCREW (A)	69	LUBE PORT CAP	122	SLIDE CAM (M)
24	BALL BEARING	70	LUBE PORT CAP SCREW	123	SLIDE CAM SCREW (3)
25	CRANK SHAFT	71	DRAG SPRING WASHER	124	DIAL CAM (M)
26	IDLER (L) WASHER (A)	72	CLICK HOLDER	125	CLICK SPRING
27	IDLER (L)	73	STAR DRAG	127	LINK PLATE
28	IDLER (L) WASHER (B)	73X	STAR DRAG ASSEMBLY	128	LINK PLATE SCREW
29	BEARING PLATE	74	CLICKER	133	HOOK HOLDER
30	E-RING	75	CLICK PLATE	134	HOOK HOLDER WASHER(OPTIONAL)
31	BEARING PLATE SCREW	76	CLICK PLATE RETIANER	135	HOOK HOLDER SCREW
33	CLUTCH CAM	77	HANDLE WASHER	136	HOOK HOLDER SPRING
34	CLUTCH SPRING	78	HANDLE	141	HOOD
35	KICK LEVER	78X	HANDLE ASSEMBLY	142	HOOD SCREW (4)
36	KICK LEVER SPRING	79	BUSHING	143	FRONT COVER SCREW (B)
37	CAM PLATE	80	HANDLE KNOB	144	LOCK LEVER
38	CLUTCH CAM SCREW	81	BALL BEARING	147	GUIDE PIN
39	PINION YOKE	82	HANDLE KNOB SCREW	148	WASHER
40	PINION GEAR	83	HANDLE KNOB CAP	149	SLIDE PLATE
41	PINION YOKE SPRING (2)	84	HANDLE WASHER	150	SLIDE PLATE SCREW
42	RATCHET	85	HANDLE NUT	151	LOCK LEVER SPRING
43	RATCHET WASHER	86	HANDLE NUT RETAINER	152	COLLAR-K
44	DRIVE GEAR	87	SCREW	153	SPRING PLATE
45	DRAG WASHER(L-3)	88	SPOOL		



TEAM LEW'S™ HYPERMAG
SPEED SPOOL® SLP

TLH1SHL, TLH1XHL



11 Bearing System
C45 CARBON

Reel Specifications

Model	Weight (oz.)	Gear Ratio	Line Capacity (yd./lbs.)	RPT* (in.)
TLH1SHL	5.4	7.5:1	110/12	30
TLH1XHL	5.4	8.3:1	110/12	33

*Recovery per turn.

FEATURES:

- 11-bearing system with stainless steel double shielded ball bearings and Zero-Reverse one-way clutch bearing
- One-piece, lightweight Magnesium frame
- Speed Dial line recognition system
- Speed Keeper hook keeper
- Lightweight double anodized aluminum spool
- Lightweight C45 Carbon sideplates
- SpeedCast® externally Adjustable Centrifugal Brake System
- Smooth carbon fiber drag system provides up to 20 lbs. drag power
- Titanium-coated Zirconia line guide
- External lube port

Performance – Right out of the Box!

Your Speed Spool® reel is designed for performance and functionality. From the way it conforms to your hand, to the way it reacts crisply and effortlessly to your command, you'll know the minute you grab onto your Speed Spool® that you've got a quality reel. Your Speed Spool® reel exploits several new developments which will allow you to set yourself apart from the competition.

High Strength Aluminum Gearing The drive gear, crankshaft, and worm shaft are made of high strength aluminum for increased strength and durability. In addition to these advantages, aluminum provides exceptionally low friction to enhanced efficiency.



Machined Aluminum Spool  **Lightweight Double Anodized Aluminum Spool**
The spool on your Lew's® reel has been engineered to maximize casting distance. Anodized to withstand oxidation and abrasion, machined and built for deep capacity.

One-piece Magnesium Frame Your Speed Spool® reel utilizes a one-piece, lightweight Magnesium frame that is both lightweight and strong, so you'll never have to worry about frame torque or twisting.

SPEED DIAL  **Line Recognition** Your Speed Spool® reel features a convenient line indicator dial on the spool's tension knob. Quickly recognize what line type and line weight you have loaded on your reel.

SPEED KEEPER  **Hook Keeper** The innovative Speed Keeper® hook keeper gives convenience a whole new meaning. Swing it out and secure your hook, swing it back and it conveniently tucks back under the reel when not in use.

ZERO  **REVERSE Bearing** The handle on your Speed Spool® reel will only rotate forward for rock solid hook setting. When you release the handle it will hold its position because of the Zero-Reverse bearing, never losing an inch on your catch; an invaluable property to have when you're pulling it in.

SpeedCast  **ACB**  **Externally Adjustable Centrifugal Brake System** The SpeedCast® Adjustable Centrifugal Brake System delivers an extreme range of braking power from free spool to maximum by simply clicking its external dial to choose among 27 variable settings. The ACB system puts you in control of your casts, perfectly aligning brake power to conditions. With this system you will have more casting control over light lures, while maximizing casting distance with all lures.

Cast Control System A second feature exists to prevent backlash, the Cast Control System. An adjustment knob is found next to the star drag. The function saddles the spool shaft with steady pressure in order to stabilize spool speed.

To calibrate the system, reel your lure in until it rests on the tip of the rod, then tighten the knob until taut. Depress the thumb bar, and holding the rod horizontally loosen the knob slowly until the lure begins to descend. The spool should continue to spin after the lure contacts the ground, but should not complete more than one full rotation. If the spool does not continue to spin, the knob is too tight. If the spool completes more than one rotation, the knob is too loose. Repeat until you have achieved the desired results.

winn  **Bowed 95MM Carbon Fiber Winn® Handle** Our 95 mm bowed carbon fiber handle will give you all the cranking power you need. The Winn® Dri-tac handle knobs are an added bonus known for a comfortable grip for all day fishing.

Speed Spool SLP Baitcast reels are designed to be **Super Low Profile**.
Driven by innovation – Fueled with Passion
Feel the Difference!

ATTENTION BRAIDED LINE USERS!

If your Lew's® Baitcast reel has pre-drilled holes in the spool, you may tie your braid directly to the spool, by passing the braid thru the provided holes and tying a uni-knot.

If your Lew's® baitcast reel does not have pre-drilled holes in the spool, you will need to first tie on and spool at least 20 revolutions of monofilament line, and then tie your braided line to the monofilament line, with either a back-to-back uni-knot or an Albright knot.

Continue to spool your reel as normal, keeping strong tension on the line to ensure the line is firmly wound onto the spool to keep from "digging in" to underlying line layers when pressure is put on the line from fighting fish.

FAILURE TO PROPERLY SPOOL BRAIDED LINE ONTO YOUR REELS SPOOL WILL RESULT IN LINE SLIPPAGE, AND THE IMPRESSION YOUR DRAG IS NOT WORKING PROPERLY.



TEAM LEW'S HYPERMAG
SPEED SPOOL SLP
 TLH1SHL, TLH1XHL

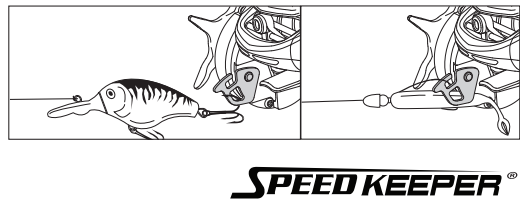
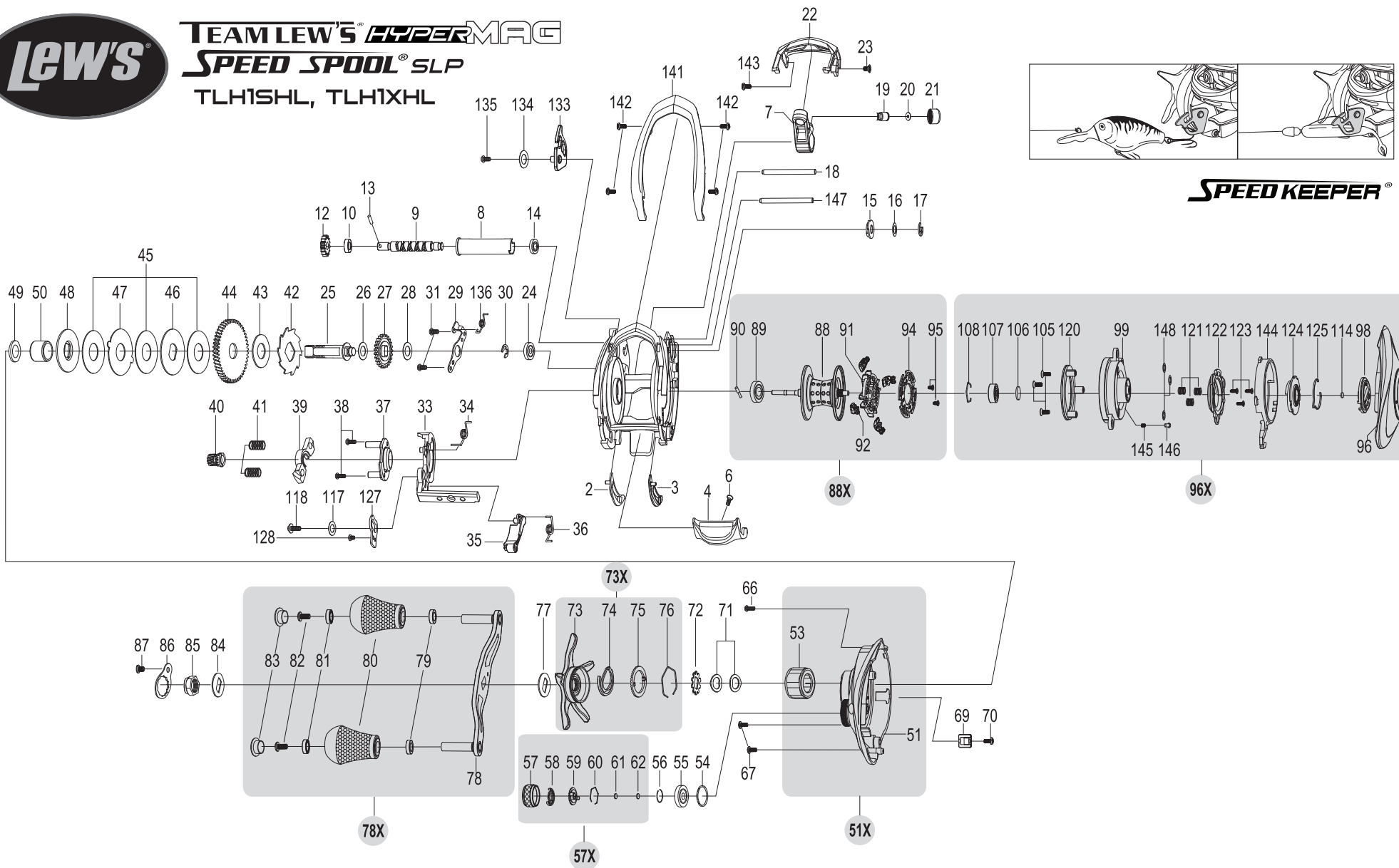
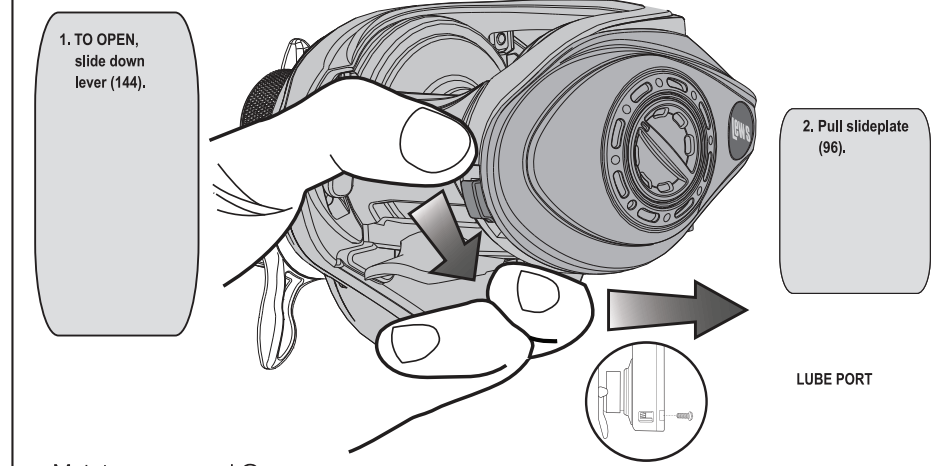

fig 1 To remove palming sideplate slide down lever (144) and pull slideplate off (96).



Maintenance and Care
 When applying lubricant to your Speed Spool reel, avoid using multi-purpose oil. Use lightweight oils or greases made for fishing reels. Apply oil to all bearings, the crankshaft and the worm gear. Apply grease to the bushings, pinion gears, drive gears, and crank gears.

After usage, your reel should be inspected for dirt or sand and cleaned if excessive build-up is present. If your reel has come in contact with saltwater it is important to flush all parts with water, dry and re-lubricate your reel. Through diligent cleaning and maintenance your Lew's reel will provide you with years of reliability and sound performance.

KEY #	PART NAME	KEY #	PART NAME	KEY #	PART NAME
1	FRAME ASSEMBLY	46	DRAG WASHER(D1)	88X	SPOOL ASSEMBLY
2	CLUTCH BAR PLATE-R	47	DRAG WASHER (A)	89	BALL BEARING
3	CLUTCH BAR PLATE-L	48	DRAG WASHER (D2)	90	PIN
4	CLUTCH BAR	49	SLEEVE WASHER (OPTIONAL)	91	BRAKE HOLDER
6	CLUTCH BAR SCREW	50	SLEEVE	92	BRAKE SHOE ASSEMBLY (4)
7	LEVEL WIND ASSEMBLY	51	GEAR SIDE PLATE	94	BRAKE HOLDER PLATE
8	PIPE	51X	GEAR SIDE PLATE ASSEMBLY	95	BRAKE HOLDER PLATE SCREW (2)
9	WORM SHAFT	53	ONE-WAY CLUTCH	96	PALM SIDE PLATE
10	BALL BEARING	54	O-RING	96X	PALM SIDE PLATE ASSEMBLY
12	IDLER(S)	55	BALL BEARING	98	CONTROL DIAL
13	WORM SHAFT PIN	56	BEARING RETAINER	99	SPOOL COVER
14	BALL BEARING	57	CAST CONTROL CAP	105	SPOOL COVER SCREW (3)
15	WORM SHAFT BUSHING (B)	57X	CAST CONTROL CAP ASSEMBLY	106	SPOOL SPACER (A)
16	WORM SHAFT WASHER (OPTIONAL)	58	CLICKER	107	BALL BEARING
17	E-RING	59	CLICK PLATE	108	BEARING RETAINER
18	PILLAR	60	CLICK PLATE RETIANER	114	WASHER (OPTIONAL)
19	LEVEL WIND PIN	61	TENSION WASHER	117	CLUTCH WASHER
20	SPACER (OPTIONAL)	62	SPOOL SPACER (B)	118	CLUTCH SCREW
21	LEVEL WIND NUT	66	GEAR SIDE PLATE SCREW (A)	120	BRAKE PLATE HOLDER ASSEMBLY
22	FRONT COVER	67	GEAR SIDE PLATE SCREW (B)	121	SLIDE CAM SPRING (3)
23	FRONT COVER SCREW (A)	69	LUBE PORT CAP	122	SLIDE CAM (M)
24	BALL BEARING	70	LUBE PORT CAP SCREW	123	SLIDE CAM SCREW (3)
25	CRANK SHAFT	71	DRAG SPRING WASHER	124	DIAL CAM (M)
26	IDLER (L) WASHER (A)	72	CLICK HOLDER	125	CLICK SPRING
27	IDLER (L)	73	STAR DRAG	127	LINK PLATE
28	IDLER (L) WASHER (B)	73X	STAR DRAG ASSEMBLY	128	LINK PLATE SCREW
29	BEARING PLATE	74	CLICKER	133	HOOK HOLDER
30	E-RING	75	CLICK PLATE	134	HOOK HOLDER WASHER(OPTIONAL)
31	BEARING PLATE SCREW	76	CLICK PLATE RETIANER	135	HOOK HOLDER SCREW
33	CLUTCH CAM	77	HANDLE WASHER	136	HOOK HOLDER SPRING
34	CLUTCH SPRING	78	HANDLE	141	HOOD
35	KICK LEVER	78X	HANDLE ASSEMBLY	142	HOOD SCREW (4)
36	KICK LEVER SPRING	79	BUSHING	143	FRONT COVER SCREW (B)
37	CAM PLATE	80	HANDLE KNOB	144	LOCK LEVER
38	CLUTCH CAM SCREW	81	BALL BEARING	147	GUIDE PIN
39	PINION YOKE	82	HANDLE KNOB SCREW	148	WASHER
40	PINION GEAR	83	HANDLE KNOB CAP	149	SLIDE PLATE
41	PINION YOKE SPRING (2)	84	HANDLE WASHER	150	SLIDE PLATE SCREW
42	RATCHET	85	HANDLE NUT	151	LOCK LEVER SPRING
43	RATCHET WASHER	86	HANDLE NUT RETAINER	152	COLLAR-K
44	DRIVE GEAR	87	SCREW	153	SPRING PLATE
45	DRAG WASHER(L-3)	88	SPOOL		