

# LEWMAR®

## PRODUCT COMMUNICATION

PRODUCT DIVISION:	ANCHORING SYSTEMS
DATE:	03/10/2006
SUBJECT:	<b>Claw Anchor – SS &amp; Galvanized anchor sizes</b>

Please be advised that the Stainless steel Claw anchors & Galvanized Claw anchors vary in size. This is due to the differences in the manufacturing methods for each type of anchor.

When specifying anchoring systems you should be aware of these differences so please refer to the charts below for exact dimensions.

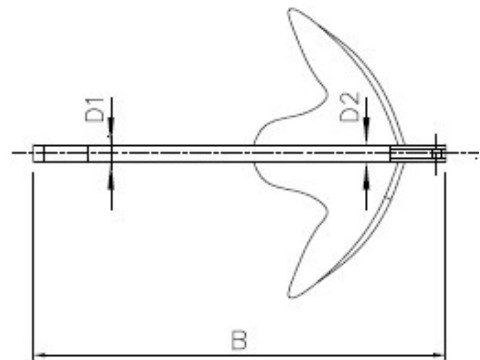
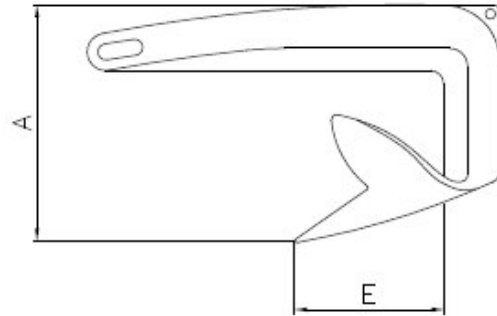
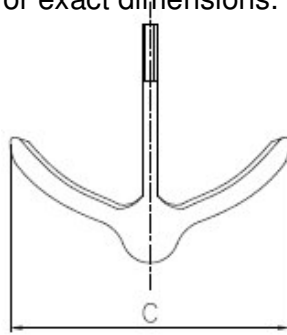

BASIC DIMENSIONS OF GALVANISED CLAW ANCHOR

	A	B	C	D1	E
1 kg	133 ± 8	295 ± 4	182 ± 8	7,5 ± 2	95 ± 6
2 kg	182 ± 8	361 ± 4	240 ± 8	9 ± 2	123 ± 6
5 kg	227 ± 10	468 ± 5	295 ± 8	12 ± 3	150 ± 6
7,5 kg	263 ± 10	499 ± 5	324 ± 10	15 ± 3	151 ± 8
10 kg	282 ± 10	540 ± 6	360 ± 10	15 ± 4	182 ± 8
15 kg	342 ± 12	630 ± 6	435 ± 10	16,5 ± 4	206 ± 12
20 kg	343 ± 12	703 ± 8	452 ± 12	25 ± 5	238 ± 12
30 kg	397 ± 12	812 ± 8	515 ± 12	24 ± 5	283 ± 12
50 kg	465 ± 12	943 ± 10	625 ± 12	25,5 ± 5	313 ± 12
80 kg	528 ± 12	1074 ± 10	699 ± 12	26 ± 5	365 ± 12

BASIC DIMENSIONS OF ST/ST CLAW ANCHOR

	A	B	C	D1	D2	E
1 kg	135 ± 8	292 ± 4	195 ± 8	8 ± 2	10 ± 2	106 (B) ± 6
2 kg	177 ± 8	358 ± 4	240 ± 8	7 ± 2	9,5 ± 2	127 (B) ± 6
5 kg	230 ± 10	453 ± 5	305 ± 8	9 ± 3	14,5 ± 3	146 ± 6
7,5 kg	267 ± 10	481 ± 5	345 ± 10	12,5 ± 3	18 ± 3	138 (B) ± 8
10 kg	288 ± 10	540 ± 6	377 ± 10	13 ± 4	19 ± 4	165 ± 8
15 kg	332 ± 12	625 ± 6	448 ± 10	15 ± 4	22 ± 4	203 (B) ± 12
20 kg	357 ± 12	661 ± 8	465 ± 12	17 ± 5	25 ± 5	220 (B) ± 12
30 kg	405 ± 12	782 ± 8	540 ± 12	18 ± 5	26 ± 5	265 ± 12

S Smith

03/10/2006

Discover other boat hatches and ventilation on our website.