

Mach

MACH® CRUSH® SLP MCR1SHA



10 Bearing System

Reel Specifications

Model	Weight (oz.)	Gear Ratio	Line Capacity (yd./lb.)	Max Drag (lb.)	RPT*
MCR1SHA	7.3	7.5:1	110/12	20	30"

*Recovery per turn.

FEATURES:

- One-piece graphite frame and sideplates
- Premium 10-bearing system with stainless steel double shielded ball bearings and Zero Reverse® one-way clutch bearing
- High strength solid brass Speed Gears®, cut on precision Hamai CNC gear hobbing machines
- Externally-adjustable Multi-Setting Brake (MSB) dual cast control system utilizing both an external click-dial for setting the magnetic brake, plus 4 individually disengaging, disk-mounted internal brake shoes that operate on centrifugal force
- Anodized aluminum spool tension knob with audible click
- Rugged carbon fiber drag system provides up to 20lbs. of drag power
- Audible click, bowed, double anodized aluminum star drag
- Bowed 95 mm aluminum handle with Winn® Dri-Tac knobs

Driven by innovation – Fueled with Passion Feel the Difference!

ATTENTION BRAIDED LINE USERS!

If your Lew's Baitcast reel has pre-drilled holes in the spool, you may tie your braid directly to the spool, by passing the braid thru the provided holes and tying a uni-knot.

If your Lew's baitcast reel does not have pre-drilled holes in the spool, you will need to first tie on and spool at least 20 revolutions of monofilament line, and then tie your braided line to the monofilament line, with either a back-to-back uni-knot or an Albright knot.

Continue to spool your reel as normal, keeping strong tension on the line to ensure the line is firmly wound onto the spool to keep from "digging in" to underlying line layers when pressure is put on the line from fighting fish.

FAILURE TO PROPERLY SPOOL BRAIDED LINE ONTO YOUR REELS SPOOL WILL RESULT IN LINE SLIPPAGE, AND THE IMPRESSION YOUR DRAG IS NOT WORKING PROPERLY.

Performance – Right out of the Box!

Your Speed Spool® reel is designed for performance and functionality. From the way it conforms to your hand, to the way it reacts crisply and effortlessly to your command, you'll know the minute you grab onto your Speed Spool® that you've got a quality reel. Your Speed Spool® reel exploits several new developments which will allow you to set yourself apart from the competition.

One-piece Graphite Frame and Sideplates

Your Speed Spool® reel utilizes a one-piece, lightweight graphite frame and sideplates. Lightweight plus strong, so you'll never have to worry about frame torque or twisting.

Machine Forged Anodized Aluminum Spool

The machine forged anodized aluminum spool of your Speed Spool reel is engineered for deep capacity and double anodized for superior oxidation and abrasion resistance.



Speed Gears®

Lew's Speed Gears are cut on precision Hamai CNC gear hobbing machines resulting in an efficient drive train with less gear feel.



Zero Reverse® Bearing

The handle on your Speed Spool reel will only rotate forward for rock solid hook setting. When you release the handle, it will hold its position because of the Zero Reverse bearing, never losing an inch on your catch; an invaluable property to have when you're pulling it in.

Multi-Setting Braking System (MSB)

In order to combat backlash your Speed Spool® reel features both an externally-adjustable, full-release magnetic braking system as well as an internally adjustable centrifugal brake system. The magnetic brakes give consistent braking throughout the entire cast and are adjusted by the palming sideplate dial. The centrifugal brakes provide initial braking at the beginning of the cast to reduce backlash and can be turned off to reduce braking by removing the palming sideplate and pushing the white pin(s) towards the center of the spool until they click. To turn them back on push the white pin(s) away from the center of the spool until they click.



Bowed 95mm Aluminum Handle

Our bowed aluminum handle will give you all the cranking power you need. The Winn Dri-Tac knobs are an added bonus known for a comfortable fit and ease for all day fishing.

Mach

MACH® CRUSH® SLP MCR1SHA

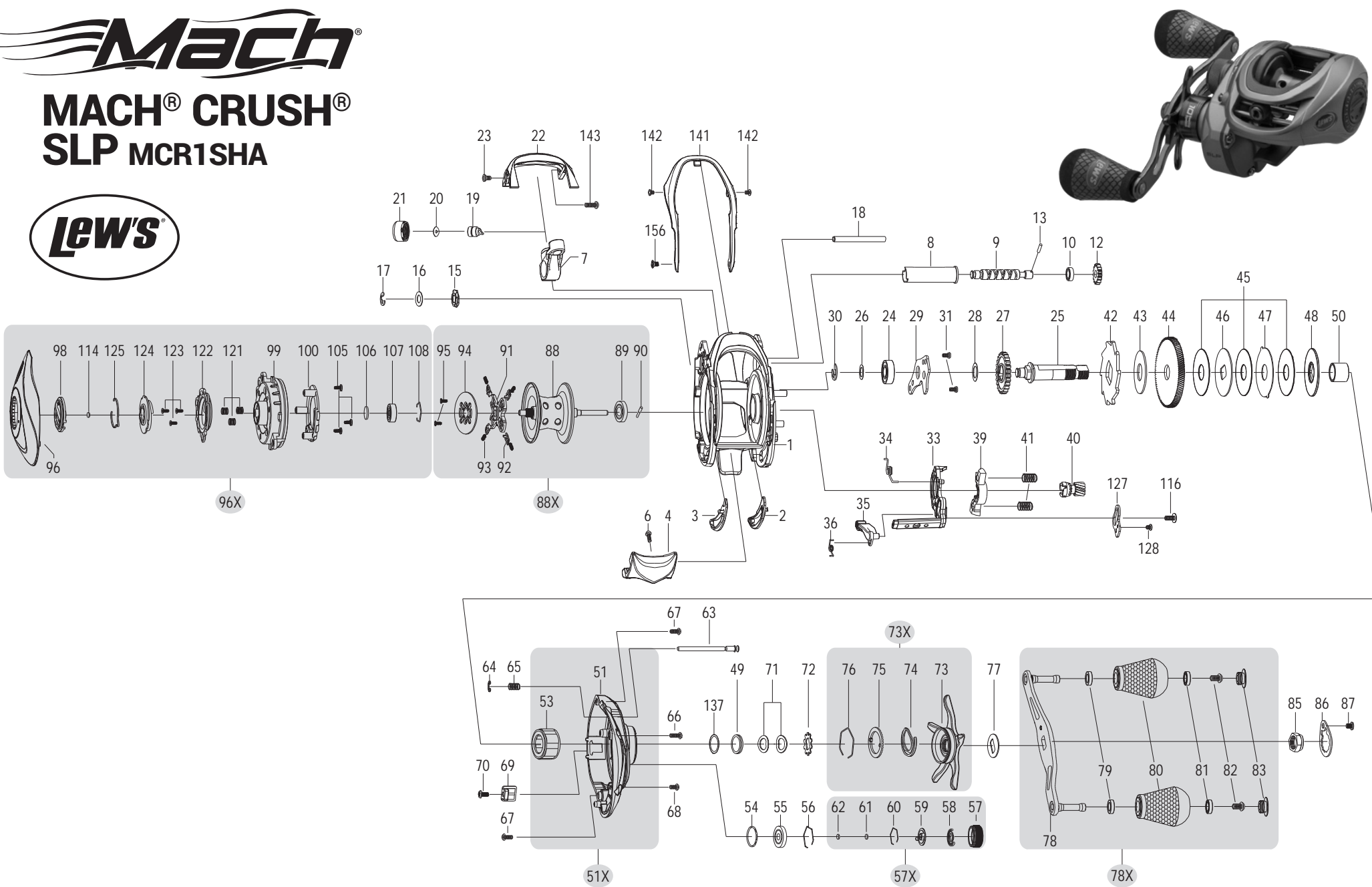

KEY #	PART NAME	KEY #	PART NAME	KEY #	PART NAME
1	FRAME	45	DRAG WASHER-L	81	BALL BEARING
2	CLUTCH BAR PLATE-R	46	DRAG WASHER-D1	82	HANDLE KNOB SCREW
3	CLUTCH BAR PLATE-L	47	DRAG WASHER-A	83	HANDLE KNOB CAP
4	CLUTCH BAR	48	DRAG WASHER-D2	85	HANDLE KNOB SCREW
6	CLUTCH BAR SCREW	49	SLEEVE WASHER(OPTIONAL)	86	HANDLE KNOB CAP
7	LEVELWIND ASSEMBLY	50	SLEEVE		HANDLE NUT
8	PIPE	51	GEAR SIDEPLATE	87	HANDLE NUT RETAINER SCREW
9	WORM SHAFT		51X GEAR SIDEPLATE ASSEMBLY	88	SPOOL
10	BALL BEARING	53	ONE-WAY CLUTCH BEARING		88X SPOOL ASSEMBLY
12	IDLER-S	54	O-RING	89	BALL BEARING
13	WORM SHAFT PIN	55	BALL BEARING	90	PIN
15	WORM SHAFT BUSHING-B	56	BEARING RETAINER	91	BRAKE HOLDER
16	WORM SHAFT WASHER	57	CAST CONTROL CAP	92	BRAKE SHOE
17	E-RING		57X CAST CONTROL CAP ASSEMBLY	93	BRAKE SHOE SPRING
18	PILLAR	58	CLICKER	94	MAGNET PLATE
19	LEVELWIND PIN	59	CLICK PLATE	95	SCREW
20	SPACER(OPTIONAL)	60	CLICK PLATE RETAINER	96	PALM SIDEPLATE
21	LEVELWIND NUT	61	TENSION WASHER		96X PALM SIDEPLATE ASSEMBLY
22	FRONT COVER	62	SPOOL SPACER-B	98	CONTROL DIAL
23	FRONT COVER SCREW-A	63	LOCKING PIN	99	SPOOL COVER
24	BALL BEARING	64	E-RING	100	MAGNET HOLDER ASSEMBLY
25	CRANK SHAFT	65	LOCKING PIN SPRING	105	SPOOL COVER SCREW
26	CRANK SHAFT WASHER (OPTIONAL)	66	GEAR SIDE COVER SCREW-A	106	SPOOL SPACER-A
27	IDLER-L	67	GEAR SIDE COVER SCREW-B	107	BALL BEARING
28	IDLER-L WASHER-B	68	GEAR SIDE COVER SCREW-C	108	BEARING RETAINER
29	BEARING PLATE	69	LUBE PORT CAP	114	WASHER(OPTIONAL)
30	E-RING	70	LUBE PORT CAP SCREW	116	CLUTCH CAM SCREW
31	BEARING PLATE SCREW	71	DRAG SPRING WASHER	121	SLIDE CAM SPRING
33	CLUTCH CAM	72	CLICK HOLDER	122	SLIDE CAM-H
35	CLUTCH SPRING	73	STAR DRAG	123	SLIDE CAM SCREW
36	KICK LEVER		73X STAR DRAG ASSEMBLY	124	SLIDE CAM-D
36	KICK LEVER SPRING	74	CLICK LEAF SPRING	125	CLICK SPRING
39	PINION YOKE	75	CLICK PLATE	127	LINK PLATE
40	PINION GEAR	76	CLICK PLATE RETAINER	128	LINK PLATE SCREW
41	PINION YOKE SPRING	77	HANDLE WASHER	137	DRAG SPACER
42	RATCHET		78X HANDLE ASSEMBLY	141	HOOD
43	RATCHET WASHER	79	BALL BEARING	142	HOOD SCREW-A
44	DRIVE GEAR	80	HANDLE KNOB	143	FRONT COVER SCREW-B
				156	HOOD SCREW-B

MAINTENANCE AND CARE

When applying lubricant to your Speed Spool reel, avoid using multi-purpose oil. Use lightweight oils or greases made for fishing reels. Apply oil to all bearings, the crankshaft and the worm gear. Apply grease to the bushings, pinion gears, drive gears, and crank gears.

After usage, your reel should be inspected for dirt or sand and cleaned if excessive build-up is present. If your reel has come in contact with saltwater it is important to flush all parts with water, dry and re-lubricate your reel. Through diligent cleaning and maintenance your Lew's reel will provide you with years of reliability and sound performance.

fig 1 To remove palming sideplate pull locking pin (63) away from reel body.

