



Machi SPEED SPOOL® SLP

MH1SHA

10 Bearing System

HS 7.5:1 HIGH SPEED



SPEED GEARS

Reel Specifications

Model	Weight (oz.)	Line Capacity (yds./lbs.)	Gear Ratio	RPT* (in.)
MH1SHA	6.4	140/12	7.5:1	30"

*Rotation per turn

FEATURES :

- One-piece lightweight SLP graphite frame and side plates with 3 drain ports
- 10-bearing system includes Zero Reverse® one-way clutch bearing
- Double anodized, aluminum spool tension cap
- Double anodized, aluminum drag star
- Multi-Setting Brake (MSB) system utilizes both magnetic and centrifugal braking to reduce backlash
- High strength solid brass Speed Gears, cut on precision Hamai CNC gear hobbing machines
- Durable Rulon drag system, provides up to 15lbs. of drag power
- Speed Lube for exceptional smoothness and uninterrupted performance in all weather conditions from extreme heat to freezing cold
- Combat style grip thumb bar
- Bowed 95 mm aluminum with Lew's combat style grip paddle knobs

Performance – Right out of the Box!

Your Speed Spool® SLP reel is designed for performance and functionality. From the way it conforms to your hand, to the way it reacts crisply and effortlessly to your command, you'll know the minute you grab onto your Speed Spool® SLP that you've got a quality reel.

Your Speed Spool SLP reel exploits several new developments which will allow you to set yourself apart from the competition.



Speed Gears Lew's Speed Gears are cut on precision Hamai CNC gear hobbing machines resulting in an efficient drive train with less gear feel.

One-piece Graphite Frame and Sideplates Your Speed Spool® reel utilizes a one-piece, lightweight graphite frame and sideplates. Lightweight plus strong, so you'll never have to worry about frame torque or twisting.

Machine Forged Double Anodized Aluminum Spool The machine forged double anodized aluminum spool of your Speed Spool reel is engineered for deep capacity and double anodized for superior oxidation and abrasion resistance.



Zero Reverse Bearing The handle on your Speed Spool® reel will only rotate forward for rock solid hook setting. When you release the handle, it will hold its position because of the Zero-Reverse bearing, never losing an inch on your catch; an invaluable property to have when you're pulling it in.



Multi-Setting Braking System (MSB) In order to combat backlash your Speed Spool® reel features both an externally-adjustable, full-release magnetic braking system as well as an internally adjustable centrifugal brake system. The magnetic brakes give consistent braking throughout the entire cast and are adjusted by the palming sideplate dial. The centrifugal brakes provide initial braking at the beginning of the cast to reduce backlash and can be turned off to reduce braking by removing the palming sideplate and pushing the white pin(s) towards the center of the spool until they click. To turn them back on push the white pin(s) away from the center of the spool until they click.

Cast Control System A second feature exists to prevent backlash, the Cast Control System. An adjustment knob is found next to the star drag. The function saddles the spool shaft with steady pressure in order to stabilize spool speed.

To calibrate the system, reel your lure in until it rests on the tip of the rod, then tighten the knob until taut. Depress the thumb bar, and holding the rod horizontally loosen the knob slowly until the lure begins to descend. The spool should continue to spin after the lure contacts the ground, but should not complete more than one full rotation. If the spool does not continue to spin, the knob is too tight.

If the spool completes more than one rotation, the knob is too loose. Repeat until you have achieved the desired results.

Lightweight Double Anodized Aluminum Spool The spool of your Speed Spool reel has been engineered to maximize casting distance. Double anodized to withstand oxidation and abrasion.

Speed Spool SLP Baitcast reels are designed to be **Super Low Profile**. **Driven by innovation – Fueled with Passion**
Feel the Difference!

ATTENTION BRAIDED LINE USERS!

If your Lew's® Baitcast reel has pre-drilled holes in the spool, you may tie your braid directly to the spool, by passing the braid thru the provided holes and tying a uni-knot.

If your Lew's® baitcast reel does not have pre-drilled holes in the spool, you will need to first tie on and spool at least 20 revolutions of monofilament line, and then tie your braided line to the monofilament line, with either a back-to-back uni-knot or an Albright knot.

Continue to spool your reel as normal, keeping strong tension on the line to ensure the line is firmly wound onto the spool to keep from "digging in" to underlying line layers when pressure is put on the line from fighting fish.

FAILURE TO PROPERLY SPOOL BRAIDED LINE ONTO YOUR REELS SPOOL WILL RESULT IN LINE SLIPPAGE, AND THE IMPRESSION YOUR DRAG IS NOT WORKING PROPERLY.



Machi SPEED SPOOL[®] SLP

MH1SHA

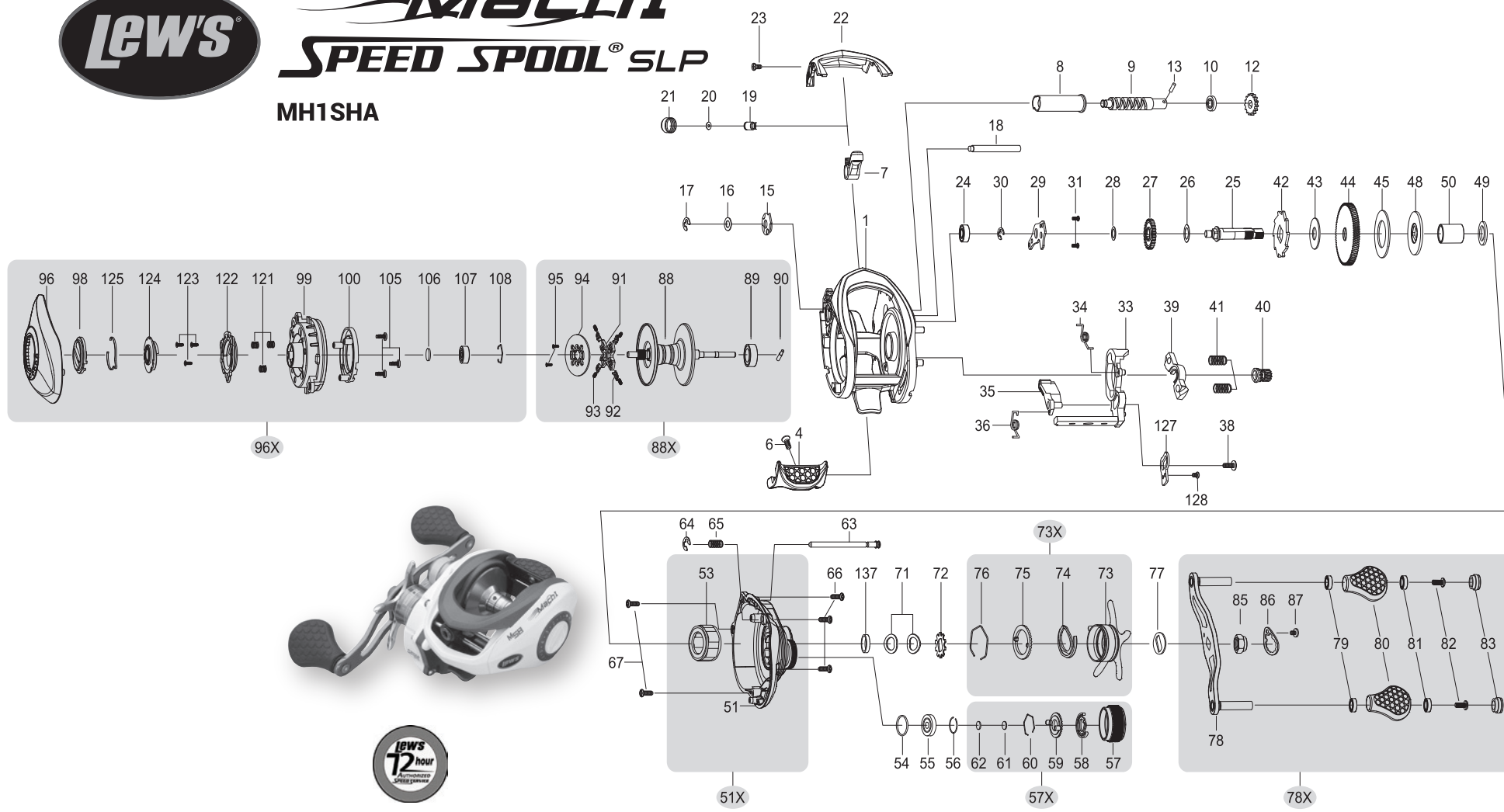

To remove palming sideplate hold down lever (144) and pull slideplate off (96).

fig 1

2. Pull slideplate (96).

LUBE PORT

1. TO OPEN, hold down lever (144).

To ensure sideplate is secure Lew's has added an auto-lock mechanism. When installing sideplate simply press outside of plate towards spool and listen for audible click. Check that switch is in the up or "lock" position before use.

To ensure sideplate is secure Lew's has added an auto-lock mechanism. When installing sideplate simply press outside of plate towards spool and listen for audible click. Check that switch is in the up or "lock" position before use.

To ensure sideplate is secure Lew's has added an auto-lock mechanism. When installing sideplate simply press outside of plate towards spool and listen for audible click. Check that switch is in the up or "lock" position before use.

Maintenance and Care
When applying lubricant to your Speed Spool reel, avoid using multi-purpose oil. Use lightweight oils or greases made for fishing reels. Apply oil to all bearings, the crankshaft and the worm gear. Apply grease to the bushings, pinion gears, drive gears, and crank gears. After usage, your reel should be inspected for dirt or sand and cleaned if excessive build-up is present. If your reel has come in contact with saltwater it is important to flush all parts with water, dry and re-lubricate your reel. Through diligent cleaning and maintenance your Lew's reel will provide you with years of reliability and sound performance.

KEY #	PARTS NAME	KEY #	PARTS NAME	KEY #	PARTS NAME
1	FRAME	43	RATCHET WASHER	81	BALL BEARING-2
2	CLUTCH BAR PLATE-R	44	DRIVE GEAR	82	HANDLE KNOB SCREW-2
3	CLUTCH BAR PLATE-L	45	DRAG WASHER-L	83	HANDLE KNOB CAP-2
4	CLUTCH BAR	46	DRAG WASHER-D1	85	HANDLE NUT
6	CLUTCH BAR SCREW	47	DRAG WASHER-A	86	HANDLE NUT RETAINER
7	LEVELWIND ASSEMBLY	48	DRAG WASHER-D2	87	HANDLE NUT RETAINER SCREW
8	PIPE	49	SLEEVE WASHER (OPTIONAL)	88	SPOOL
9	WORMSHAFT	50	SLEEVE	88X SPOOL ASSEMBLY	
10	BALL BEARING	51	GEAR SIDEPLATE	89	BALL BEARING
12	IDLER-S	51X GEAR SIDEPLATE ASSEMBLY		90	PIN
13	WORM SHAFT PIN	53	ONE-WAY CLUTCH	91	BRAKE HOLDER
15	WORM SHAFT BUSHING	54	O-RING	92	BRAKE SHOE
16	WORM SHAFT WASHER (OPT)	55	BALL BEARING	93	BRAKE SHOE SPRING-4
17	E-RING	56	BEARING RETAINER	94	BRAKE HOLDER
18	PILLAR	57	CAST CONTROL CAP	95	BRAKE HOLDER PLATE SCREW-3
19	LEVELWIND PIN	57X CAST CONTROL CAP ASS'BLY		96	PALM SIDEPLATE
20	SPACER (OPTIONAL)	58	CLICKER	96X PALM SIDEPLATE ASSEMBLY	
21	LEVELWIND NUT	59	CLICKPLATE	98	CONTROL DIAL
22	FRONT COVER	60	CLICKPLATE RETAINER	99	SPOOL COVER
23	FRONT COVER SCREW-A	61	TENSION WASHER	100	MAGNET HOLDER ASSEMBLY
24	BALL BEARING	62	SPOOL SPACE-B	105	SPOOL COVERScrew-3
25	CRANKSHAFT	66	GEAR SIDEPLATE SCREW-A	106	SPOOL SPACER (A)
26	IDLER-L WASHER-A	67	GEAR SIDEPLATE SCREW	107	BALL BEARING
27	IDLER-L	69	LUBE PORT CAP	108	BEARING RETAINER
28	IDLER-L WASH-B	70	LUBE PORT CAP SCREW	111	DRAG SPRING WASHER
29	BEARING PLATE	71	DRAG SPRING WASHER	121	SLIDE CAM SPRING
30	E-RING	72	DRAG SPACER	122	SLIDE CAM-H
31	BEARING PLATE SCREW-2	73	STAR DRAG	123	SLIDE CAM SCREW
33	CLUTCH CAM	73X STAR DRAG ASSEMBLY		124	DIAL CAM-D
34	CLUTCH SPRING	74	CLICKER	125	CONTROL DIAL CLICK SPRING
35	KICK LEVER	75	CLICKPLATE	127	LINK PLATE
36	KICK LEVER SPRING	76	CLICKPLATE RETAINER	128	LINKPLATE SCREW
38	CLUTCH CAM SCREW	77	HANDLE WASHER	137	DRAG SPACER
39	PINION YOKE	78	HANDLE		
40	PINION GEAR	78X HANDLE ASSEMBLY			
41	PINION YOKE SPRING-2	79	BALL BEARING		
42	RATCHET	80	HANDLE KNOB-2		



Machi SPEED SPOOL® SLP

MH1SHLA

Left Hand / Gaucher
Mano izquierda

10 Bearing System

HS
7.5:1
HIGH SPEED



SPEED GEARS

Reel Specifications

Model	Weight (oz.)	Line Capacity (yds./lbs.)	Gear Ratio	RPT* (in.)
MH1SHLA	6.4	140/12	7.5:1	30"

*Rotation per turn

FEATURES :

- One-piece lightweight SLP graphite frame and side plates with 3 drain ports
- 10-bearing system includes Zero Reverse® one-way clutch bearing
- Double anodized, aluminum spool tension cap
- Double anodized, aluminum drag star
- Multi-Setting Brake (MSB) system utilizes both magnetic and centrifugal braking to reduce backlash
- High strength solid brass Speed Gears, cut on precision Hamai CNC gear hobbing machines
- Durable Rulon drag system, provides up to 15lbs. of drag power
- Speed Lube for exceptional smoothness and uninterrupted performance in all weather conditions from extreme heat to freezing cold
- Combat style grip thumb bar
- Bowed 95 mm aluminum with Lew's combat style grip paddle knobs

Performance – Right out of the Box!

Your Speed Spool® SLP reel is designed for performance and functionality. From the way it conforms to your hand, to the way it reacts crisply and effortlessly to your command, you'll know the minute you grab onto your Speed Spool® SLP that you've got a quality reel.

Your Speed Spool SLP reel exploits several new developments which will allow you to set yourself apart from the competition.



Speed Gears Lew's Speed Gears are cut on precision Hamai CNC gear hobbing machines resulting in an efficient drive train with less gear feel.

One-piece Graphite Frame and Sideplates Your Speed Spool® reel utilizes a one-piece, lightweight graphite frame and sideplates. Lightweight plus strong, so you'll never have to worry about frame torque or twisting.

Machine Forged Double Anodized Aluminum Spool The machine forged double anodized aluminum spool of your Speed Spool reel is engineered for deep capacity and double anodized for superior oxidation and abrasion resistance.



Zero Reverse Bearing The handle on your Speed Spool® reel will only rotate forward for rock solid hook setting. When you release the handle, it will hold its position because of the Zero-Reverse bearing, never losing an inch on your catch; an invaluable property to have when you're pulling it in.



Multi-Setting Braking System (MSB) In order to combat backlash your Speed Spool® reel features both an externally-adjustable, full-release magnetic braking system as well as an internally adjustable centrifugal brake system. The magnetic brakes give consistent braking throughout the entire cast and are adjusted by the palming sideplate dial. The centrifugal brakes provide initial braking at the beginning of the cast to reduce backlash and can be turned off to reduce braking by removing the palming sideplate and pushing the white pin(s) towards the center of the spool until they click. To turn them back on push the white pin(s) away from the center of the spool until they click.

Cast Control System A second feature exists to prevent backlash, the Cast Control System. An adjustment knob is found next to the star drag. The function saddles the spool shaft with steady pressure in order to stabilize spool speed.

To calibrate the system, reel your lure in until it rests on the tip of the rod, then tighten the knob until taut. Depress the thumb bar, and holding the rod horizontally loosen the knob slowly until the lure begins to descend. The spool should continue to spin after the lure contacts the ground, but should not complete more than one full rotation. If the spool does not continue to spin, the knob is too tight.

If the spool completes more than one rotation, the knob is too loose. Repeat until you have achieved the desired results.

Lightweight Double Anodized Aluminum Spool The spool of your Speed Spool reel has been engineered to maximize casting distance. Double anodized to withstand oxidation and abrasion.

Speed Spool SLP Baitcast reels are designed to be Super Low Profile. Driven by innovation – Fueled with Passion Feel the Difference!

ATTENTION BRAIDED LINE USERS!

If your Lew's® Baitcast reel has pre-drilled holes in the spool, you may tie your braid directly to the spool, by passing the braid thru the provided holes and tying a uni-knot.

If your Lew's® baitcast reel does not have pre-drilled holes in the spool, you will need to first tie on and spool at least 20 revolutions of monofilament line, and then tie your braided line to the monofilament line, with either a back-to-back uni-knot or an Albright knot.

Continue to spool your reel as normal, keeping strong tension on the line to ensure the line is firmly wound onto the spool to keep from "digging in" to underlying line layers when pressure is put on the line from fighting fish.

FAILURE TO PROPERLY SPOOL BRAIDED LINE ONTO YOUR REELS SPOOL WILL RESULT IN LINE SLIPPAGE, AND THE IMPRESSION YOUR DRAG IS NOT WORKING PROPERLY.



Machi SPEED SPOOL® SLP

MH1SHLA

Left Hand / Gaucher
Mano izquierda

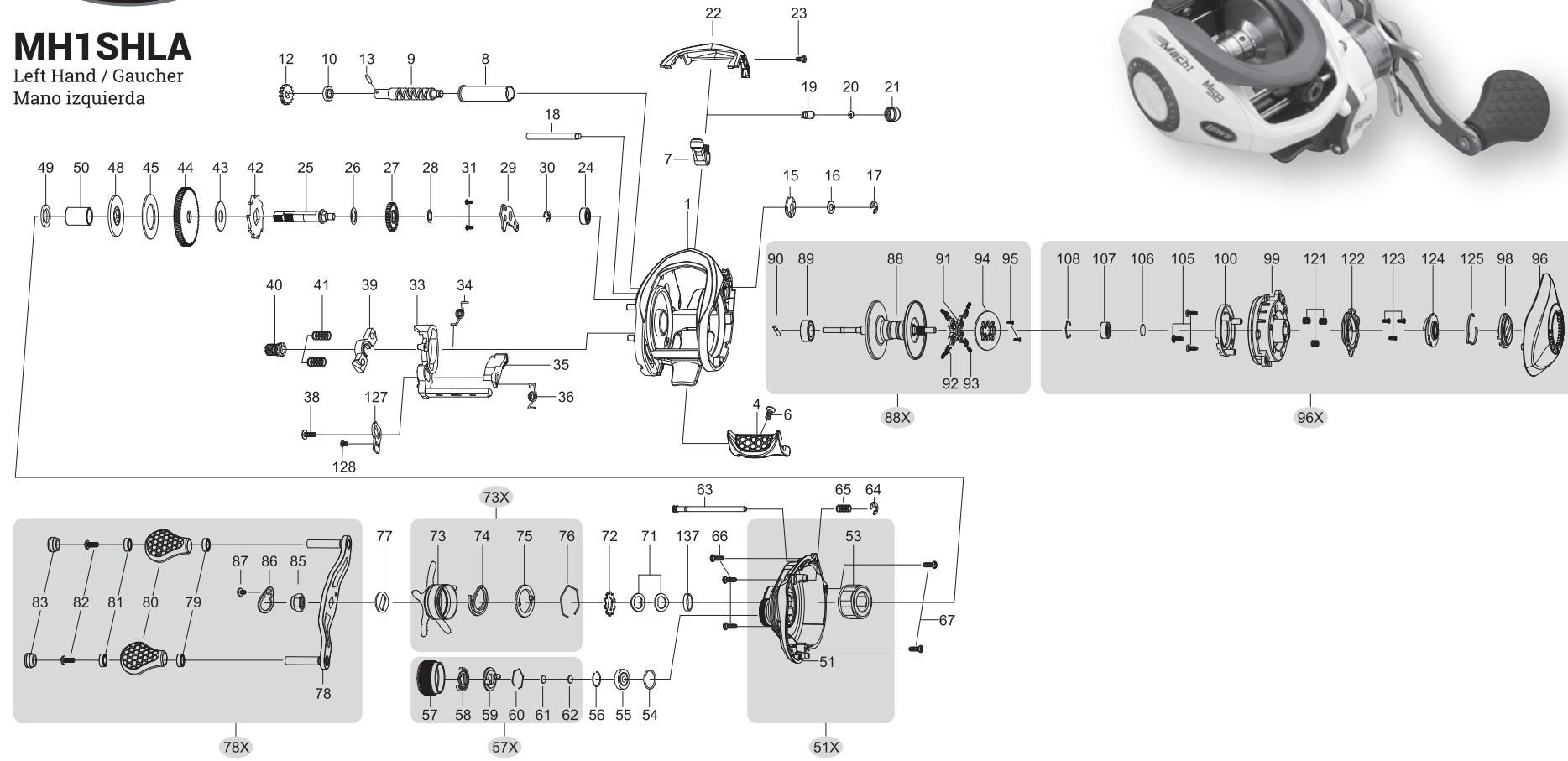

For Warranty information
and registration go to
lews.com

KEY #	PARTS NAME	KEY #	PARTS NAME	KEY #	PARTS NAME
1	FRAME	43	RATCHET WASHER	81	BALL BEARING-2
2	CLUTCH BAR PLATE-R	44	DRIVE GEAR	82	HANDLE KNOB SCREW-2
3	CLUTCH BAR PLATE-L	45	DRAG WASHER-L	83	HANDLE KNOB CAP-2
4	CLUTCH BAR	46	DRAG WASHER-D1	85	HANDLE NUT
6	CLUTCH BAR SCREW	47	DRAG WASHER-A	86	HANDLE NUT RETAINER
7	LEVELWIND ASSEMBLY	48	DRAG WASHER-D2	87	HANDLE NUT RETAINER SCREW
8	PIPE	49	SLEEVE WASHER (OPTIONAL)	88	SPOOL
9	WORMSHAFT	50	SLEEVE	88X SPOOL ASSEMBLY	
10	BALL BEARING	51	GEAR SIDEPLATE	89	BALL BEARING
12	IDLER-S	51X GEAR SIDEPLATE ASSEMBLY		90	PIN
13	WORM SHAFT PIN	53	ONE-WAY CLUTCH	91	BRAKE HOLDER
15	WORM SHAFT BUSHING	54	O-RING	92	BRAKE SHOE
16	WORM SHAFT WASHER (OPT)	55	BALL BEARING	93	BRAKE SHOE SPRING-4
17	E-RING	56	BEARING RETAINER	94	BRAKE HOLDER
18	PILLAR	57	CAST CONTROL CAP	95	BRAKE HOLDER PLATE
19	LEVELWIND PIN	57X CAST CONTROL CAP ASS'BLY			SCREW-3
20	SPACER (OPTIONAL)	58	CLICKER	96	PALM SIDEPLATE
21	LEVELWIND NUT	59	CLICKPLATE	96X PALM SIDEPLATE ASSEMBLY	
22	FRONT COVER	60	CLICKPLATE RETAINER	98	CONTROL DIAL
23	FRONT COVER SCREW-A	61	TENSION WASHER	99	SPOOL COVER
24	BALL BEARING	62	SPOOL SPACE-B	100	MAGNET HOLDER ASSEMBLY
25	CRANKSHAFT	66	GEAR SIDEPLATE SCREW-A	105	SPOOL COVERScrew-3
26	IDLER-L WASHER-A	67	GEAR SIDEPLATE SCREW	106	SPOOL SPACER (A)
27	IDLER-L	69	LUBE PORT CAP	107	BALL BEARING
28	IDLER-L WASH-B	70	LUBE PORT CAP SCREW	108	BEARING RETAINER
29	BEARING PLATE	71	DRAG SPRING WASHER	111	DRAG SPRING WASHER
30	E-RING	72	DRAG SPACER	121	SLIDE CAM SPRING
31	BEARING PLATE SCREW-2	73	STAR DRAG	122	SLIDE CAM-H
33	CLUTCH CAM	73X STAR DRAG ASSEMBLY		123	SLIDE CAM SCREW
34	CLUTCH SPRING	74	CLICKER	124	DIAL CAM-D
35	KICK LEVER	75	CLICKPLATE	125	CONTROL DIAL CLICK SPRING
36	KICK LEVER SPRING	76	CLICKPLATE RETAINER	127	LINK PLATE
38	CLUTCH CAM SCREW	77	HANDLE WASHER	128	LINKPLATE SCREW
39	PINION YOKE	78	HANDLE	137	DRAG SPACER
40	PINION GEAR	78X HANDLE ASSEMBLY			
41	PINION YOKE SPRING-2	79	BALL BEARING		
42	RATCHET	80	HANDLE KNOB-2		

fig 1 To remove palming sideplate pull locking pin (63) away from reel body.

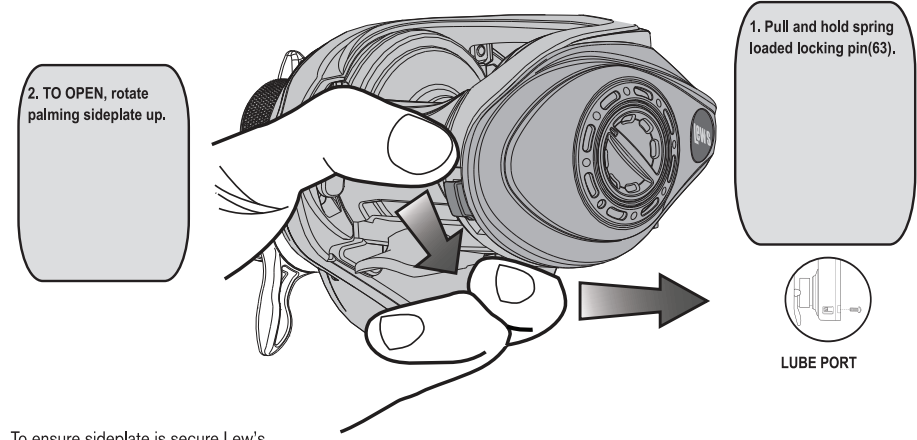

To ensure sideplate is secure Lew's has added an auto-lock mechanism. When installing sideplate simply press outside of plate towards spool and listen for audible click. Check that switch is in the up or "lock" position before use.

Maintenance and Care

When applying lubricant to your Speed Spool reel, avoid using multi-purpose oil. Use lightweight oils or greases made for fishing reels. Apply oil to all bearings, the crankshaft and the worm gear. Apply grease to the bushings, pinion gears, drive gears, and crank gears. After usage, your reel should be inspected for dirt or sand and cleaned if excessive build-up is present. If your reel has come in contact with saltwater it is important to flush all parts with water, dry and re-lubricate your reel. Through diligent cleaning and maintenance your Lew's reel will provide you with years of reliability and sound performance.

