

SMX53-ORA-BLUE

Single Color Surface Mount

LUMISHORE



10.5 - 31v
IP-68

M Class Single Color
Surface Mount Underwater Light

INSTALLATION AND OPERATION INSTRUCTIONS

Congratulations! You have purchased a LUMISHORE advanced LED technology underwater lighting system. Every care has been taken to ensure your compact SMX-53 LED light arrives in perfect condition, so please enjoy the ultimate experience in underwater lighting.

Adding underwater lighting to your vessel has never been easier - one small cable hole and three mounting screws is all it takes.

Please read the following pages to ensure a complete understanding of the LUMISHORE LED lighting system before installation.

Before you Start

- Always ensure that the vessel's power source and battery are disconnected or isolated prior to installation
- A qualified professional should carry out both the electrical and mechanical installation.
- For best underwater illumination, LUMISHORE recommends installation 4" to 12" (100-300mm) below the minimum load water line.
- Choose a location - The light must be mounted on a flat (not curved) surface. For underwater installs mount on transom or side hull only.
- A hole will be drilled to allow the cable to be inserted; care must be taken to ensure there is unrestricted access inside the hull.
- When installing three or more lights, equal spacing 2.5' - 3' is recommended to give a consistent light pool.
- The light is temperature sensitive and must not be located close to the exhaust outlet or other heat source.
- The lights operate on 12V or 24 V DC. Never connect a light directly to the mains AC voltage, or DC voltage other than that specified.
- Each light should be individually fused with a 3A fuse
- For Installation on boats up to 15m (50 ft). Isolation kit (39-0203) MUST be used on boats with conductive hulls.

Mechanical Installation

Tools: Drill, drill bits, marine sealant (3M 4200, or equivalent), F2 Frearson type screwdriver, Flat head screw driver, rags for clean-up:

Pilot Hole for Screws - 9/64" / 3.5mm

Hole for Cable - 9/32" / 7mm

Recess for Gland - 17/32" / 13.5mm hole to a depth of 5/8" / 15mm

1. Select a suitable flat surface that is accessible from behind and ensure the cable can be run without a problem.
2. With one hole at the bottom centre, mark and drill the pilot holes for the screws & drill a $\varnothing 4$ mm counterbore to a depth of 5mm in each location. Drill the power cable hole. The cable hole must be recessed and chamfered on the outside of the hull to accept the cable gland on the back of the light. The light must sit flush against the hull. Note: Cored hulls must be sealed prior to fitting the lights - refer to the manufacturers instructions.

3. Clean and prepare the hull ready for the sealant.

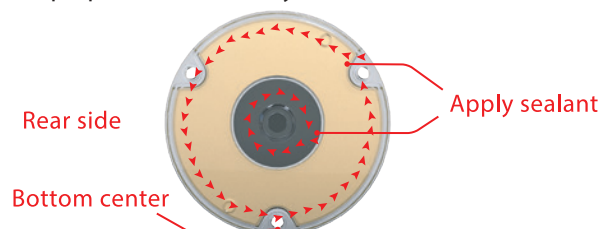

4. Apply a continuous thick bead of sealant to the back of the light, making sure the recess on the outer edge is slightly overfilled. Also apply a bead of sealant around the cable gland. Refer to image above.

5. Push the power cable through the hole and align the light with the pilot hole screws.

6. Attach the light using the 3 supplied screws by hand tightening with a screwdriver.

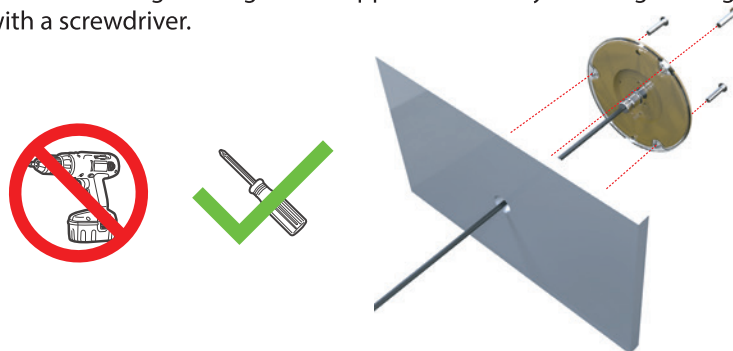

IMPORTANT: Do Not Over Tighten. Do Not Use Power Tools to tighten screws.

7. Use a damp cloth to wipe off excess sealant that has squeezed out around the light. DO NOT use chemical cleaners or solvents.

IMPORTANT: Refer to the directions on the sealant to make sure it has fully cured before launching the boat into the water.

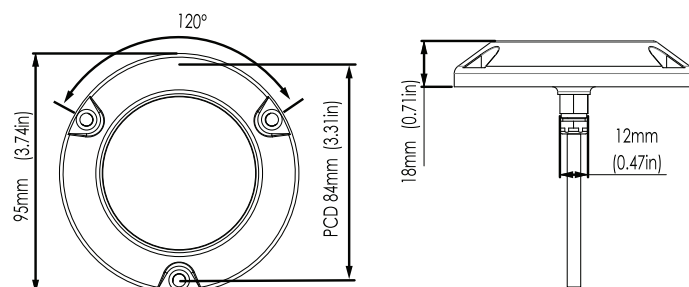

Cleaning and Maintenance

LUMISHORE lights require simple cleaning. Lights should be checked often to ensure the light body and lens area are free from sea growth. In the event that your light requires cleaning, we recommend the use of a soft cloth or soft bristled brush.

- DO NOT use any abrasive cleaning materials as these may damage the body of the light.
- DO NOT use any cleaning fluids that contain solvents, acids or alkalis.
- DO NOT clean using pressure washing or sandblasting equipment.

Slight discolouration of body may occur over life. This does not affect performance, and is not subject to warranty.

Due to nature and high build quality it may on rare occasions be possible to see small levels of condensation, this is normal for high power LEDs and will disappear after cooling and does not harm operation in any way.

If the lights are covered for any reason, e.g maintenance, or painting DO NOT switch the lights on until the covers are removed.

LUMISHORE

The logo graphic consists of three thick, black, wavy lines that sweep from the bottom left towards the right, creating a sense of motion and representing water or waves.