

10-361 • Removable Cookware Handle

Disassembly and Cleaning Instructions

Tools required:

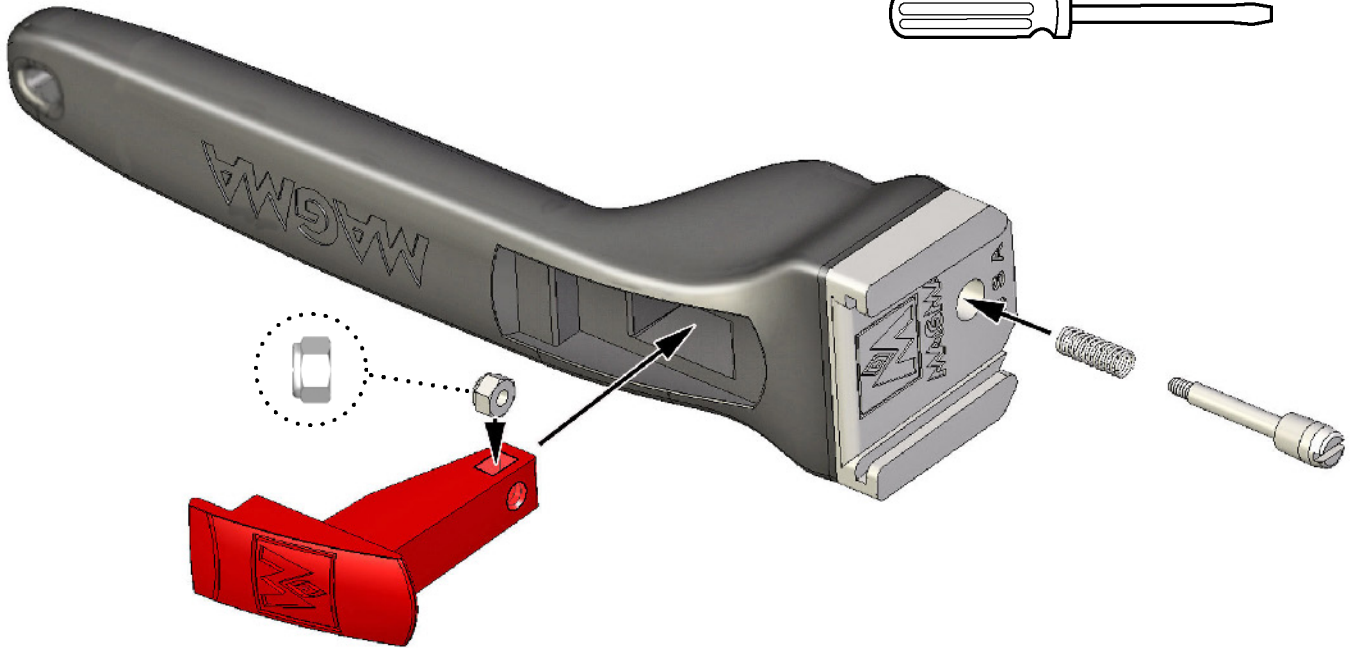

- Place handle on its side as shown.
- Unscrew & remove locking pin and spring with a slot-head screwdriver (Careful not to lose spring).
- Remove red thumb slide (Careful not to lose lock nut).
- Wash all parts with soap and water and dry.
- If necessary, clean any left over residue in locking pin hole with a Q-tip and alcohol.
- Reinstall red thumb slide with locknut in place.
- Reinsert lock pin and spring into pin hole and thread into locknut as shown (Do not over tighten).

