

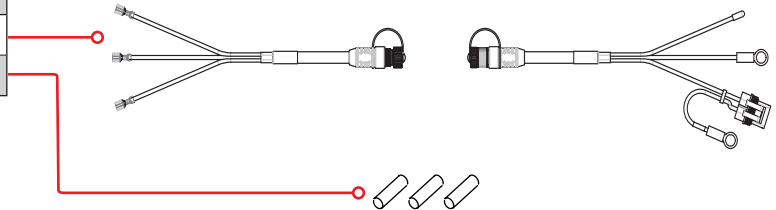

QUICK RELEASE DISCONNECT PLUG 1810244

| Parts Included: | | |
|--------------------------------|-------------|------|
| Description | Part Number | Qty. |
| Talon Cable Connector Assembly | 2377510 | 1 |
| Shrink Tube - 3/8" ID x 1.0" | 2305404 | 3 |



1. Completely disconnect the Talon from battery power.
2. Remove the (4) #8-16 x 1.5" plastite screws (item b) from the shallow cowling half on the right side. Leave the (2) lower #8-32 x 1" screws in place (image 1).

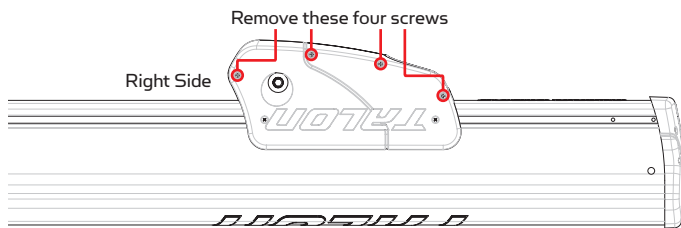

Image 1

3. Remove the (2) #8-32 x 5/8" screws from the left motor cover housing to completely remove the housing (image 2).

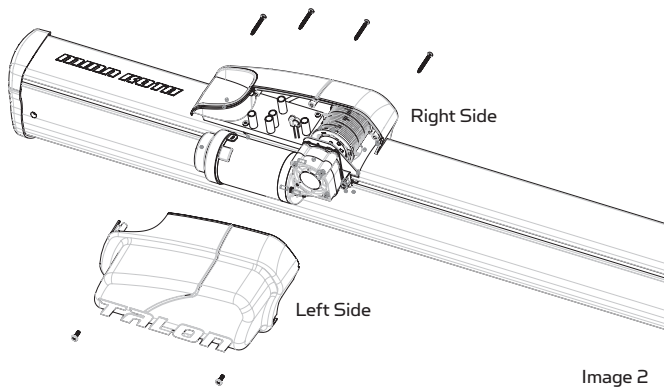

Image 2

4. There are 5 electrical leads total. DO NOT CUT THE BLACK OR RED MOTOR LEADS. Being careful not to cut the wire jackets, use a utility knife to carefully scribe a vertical cut only on the heat-shrink of the white, black, and green wire terminations of the power cable at the base of the control board. Use a needle nose pliers to peel away the cut heat-shrink.
5. Using a needle nose pliers, carefully pull up to disconnect the white, black, and green wires of the power cable from the control board shown in image 3.

NOTE: Remove the fuse and fuse cap from the old power cable and assemble it onto the new quick release disconnect plug.

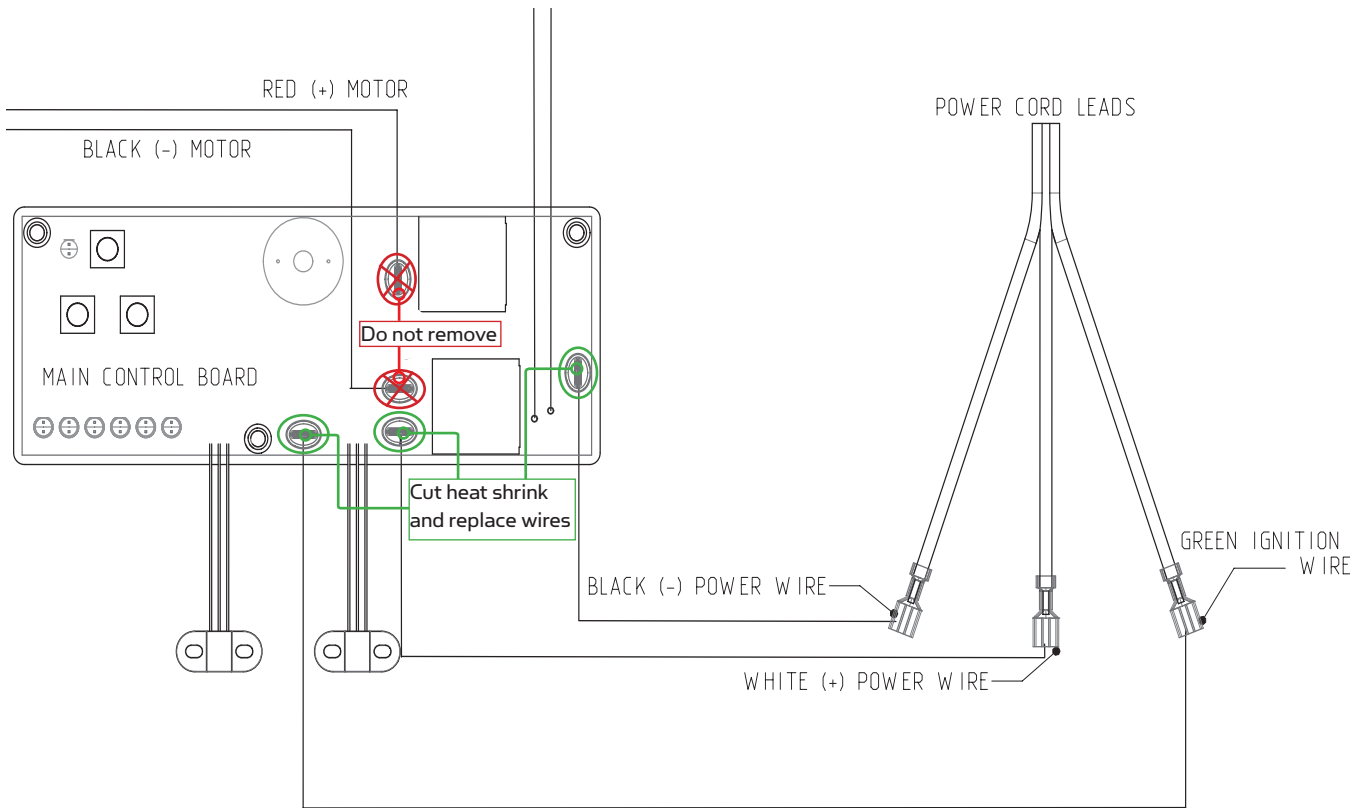

Image 3

- Use a #2 phillips screw driver to remove the plastic strain relief holding the power cord to the side of the extrusion (image 4). Save this for reuse with the cable connector assembly.

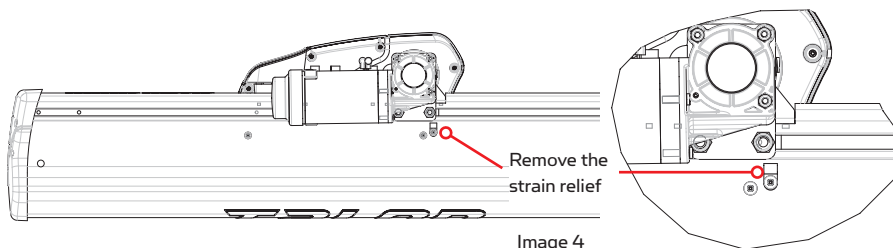

Image 4

- Route the new power cable connector assembly behind the the lift motor.
- Replace the plastic strain relief onto the new cable jacket and secure with the strain relief screw.
- Place the heat shrink sleeves over each lead from the new cable connector assembly, and connect each of the terminals to the board as shown in image 3.
- Apply heat to the heat shrink tubing to seal the connections. Be careful not to burn any of the adjacent components or wires.
- Reassemble the left motor cover, making sure there are no wires pinched at any point during reassembly. Reference the image 2 for proper hardware placement.



Part #2374956

