



MKA-21/RTA-17 Quick Release Bracket

For Use with PowerDrive, Terrova and Ulterra Trolling Motors.

Note: Do not use with motors equipped with a 72" Shaft.

Kit Includes:

Item #	QTY.	Part #	Description
1	1	2371965 2371966	Plate-Inner, White Plate-Inner, Black
2	1	2371967 2371968	Plate-Outer, White Plate-Outer, Black
3	1	2990906	Handle Assembly
4	1	2372631	Lock Pin
5	1	2260800	Hair Clip Pin
	6	2373480	Flat Head Screw-1/4-20 x 1 1/2"
	6	2371712	Washer-Flat 9/32 x 3"
	4	2373482	Flat Head Screw-1/4-20 x 3"
	4	2261713	Washer-1/4 Flat 18-8
	10	2073100	Nut
■	1	2994848	Bag Assembly, Includes 4, 5 and Hardware

Installation Instructions:

1. Remove both side covers (marked [A] in the illustration).
2. Position the Lock Pin [4]. The Handle Assembly [3] can be inserted from either side of the motor once assembled. Install the Lock Pin on the same side that the handle will be used. The Lock Pin will be retained by one of the screws securing the motor to the Outer Plate.
3. Use the (6) 1/4" x 1 1/2" Flat Head Screws, (6) 1/4" Washers and (6) Lock Nuts to fasten the Outer Plate [2] to the bottom of the motor base extrusion oriented as shown.
4. Re-install both side covers. Position Outer Plate [2] over Inner Plate [1] and secure with the Handle Assembly [3].

Note: Mounting template is located on the inside of the box. Cut template out and use it in step 6 to mark and drill the mounting holes for the Inner Plate.

5. Positioning the motor/quick release bracket for mounting location:
 - A: For PowerDrive or Terrova motors fully deploy the motor and position the bracket/motor on the bow of your boat to check for proper clearance (the motor, as it is lowered into the water or raised into the boat must not encounter any obstructions.)
 - B: For Ulterra Motors position the bracket/motor so the notch in the base is aligned with the rubrail of the boat (for proper clearance the entire notch must be visible beyond the rubrail, as shown to the right.)

6. Mark the side edges and rear of the quick release bracket on the bow of your boat. Set the motor aside. Position the template on the marks. Locate the four mounting holes in the template and drill the holes to a 17/64" diameter. Fasten the Inner Plate to the bow of the boat using the (4) 1/4"-20 x 3" Flat Head Screws, (4) Fender Washers, and (4) Nuts.

Note: Due to variations in boat mounting surfaces shims under the Inner Plate may be required.

If the Inner Plate is not mounted flat the Handle Assembly will not slide in easily or properly. After completing installation if the Handle Assembly does not slide easily into place it may be necessary to ream/drill out the handle rod holes. With inner and outer plates assembled use a letter "F" (.257") drill bit to ream the rod holes so that the Handle Assembly slides easily into place.

7. Mount the trolling motor/Outer Plate onto the Inner Plate, slide the Handle Assembly into place and secure with the Hair Clip Pin [5].
8. Your motor is now mounted. Always make sure the handle assembly is fully inserted and retained by the Hair Clip Pin.

Note: You can use a padlock in place of the Hair Clip Pin to prevent motor theft.

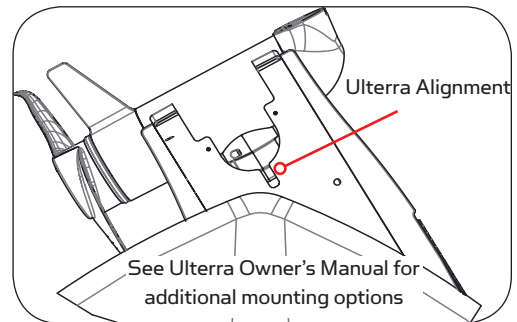
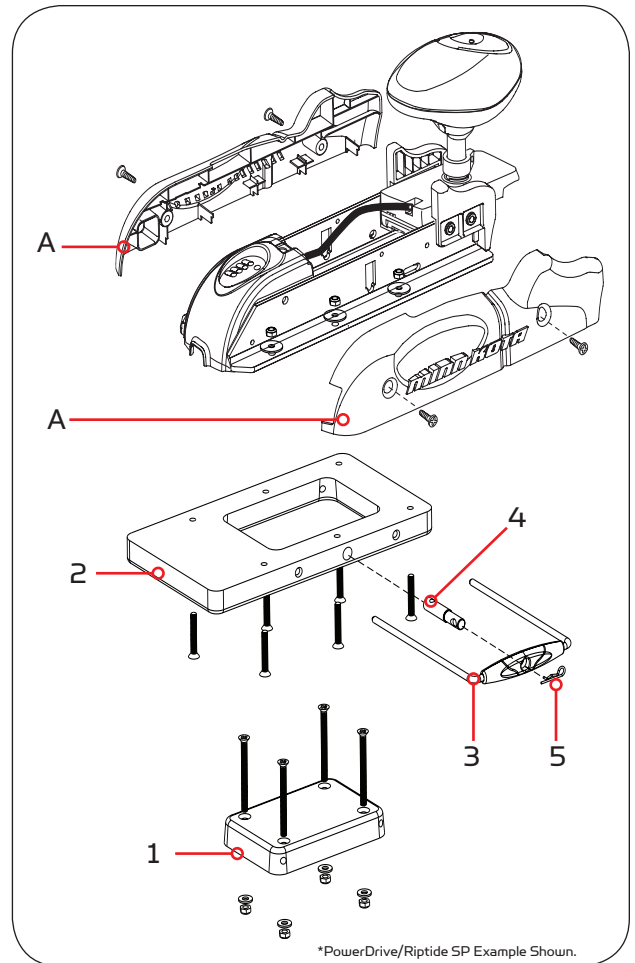

WARNING: This product contains chemicals known to the State of California to cause cancer and birth defects or other reproductive harm.

