



MKA-16-03 Elec. Steer Quick Release Bracket

1854035

FOR USE WITH ALL MINN KOTA® POWERDRIVE™, PONTOON POWERDRIVE™, ULTERRA™ AND TERROVA® FRESHWATER TROLLING MOTORS & THE POWERDRIVE™ PONTOON HAND CONTROL BRACKET & DECKHAND 40

Item / Assembly	Part #	Description	Qty.
A	2990114	QCK REL PLATE/THUMB SCREW ASM	1
2	*	PLATE-MNT, TOP PD QUICK RELEASE	1
4	*	PLATE-MNT, BTM PD/AP QK/RL	1
6	2373421	SCREW-5/16-18 X 3/8 SHCS S/S	1
8	9951778	LOCKWASHER-1/4" ZINC	1
10	2011385	SCREW-TENSION/NEW KNOB	1
▲	2374954	INSTR. SHEET MKA-16-03 BULK QRB	1
B	2994932	BAG ASM, ELEC. STEER QRB	1
12	2371728	WASHER-FENDER 1/4 X 1 1/4 ZP	4
14	2373413	SCREW-1/4-20 X 7/8 HHCS ZP	4
16	2263104	NUT-1/4-20 NYLOCK ZP	8
18	2373516	BOLT-1/4-20 X 2" HHC ZP	4

- ▲ Not shown on Parts Diagram.
- * This part is included in an assembly and cannot be ordered individually.

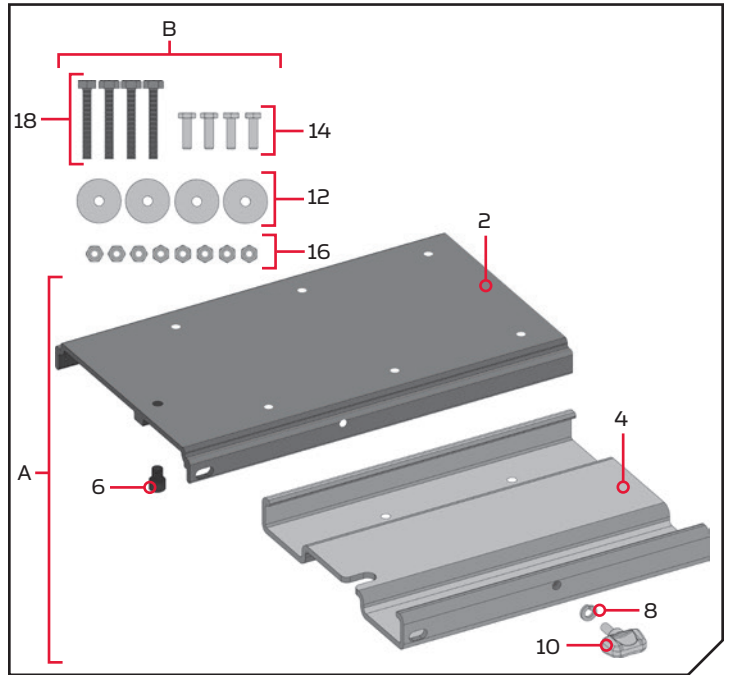

TOOLS AND RESOURCES REQUIRED

- #3 Phillips Screw Driver
- Drill
- 9/32" Drill Bit
- 7/16" Box End Wrench
- A second person to help with the installation

MOUNTING CONSIDERATIONS

It is recommended that the motor be mounted as close to the centerline of the boat as possible. The motor must not encounter any obstructions as it is lowered into the water or raised into the boat when stowed and deployed. Make sure the motor rest is positioned far enough beyond the edge of the boat. Make sure the area under the mounting location is flat, clear to drill holes and install nuts and washers.

NOTE: Images are a graphical representation and may vary slightly from your motor.

Complete Typical Installation

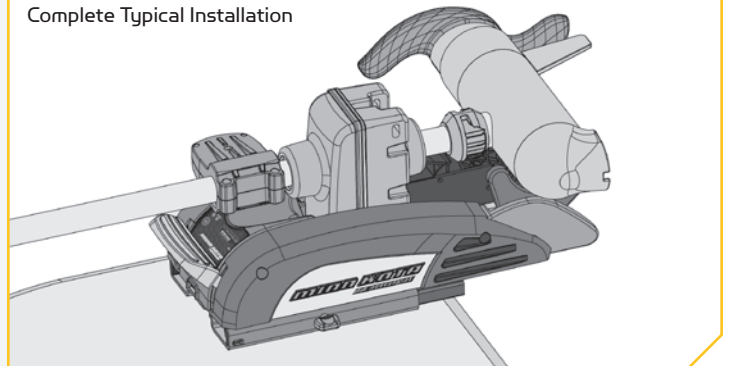

The MKA-16-03 Electric Steer Quick Release Bracket is designed to work on a number of Minn Kota trolling motors. The base extrusion or mounting bracket of the trolling motors may vary. Please note the appearance of the applicable trolling motors and mounting brackets.

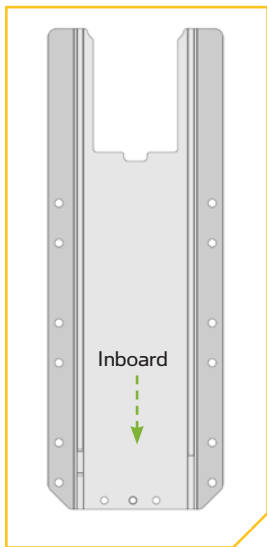

PowerDrive

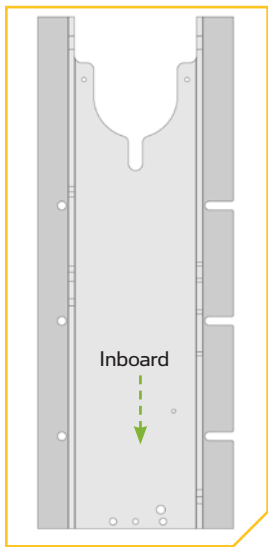

Ultra

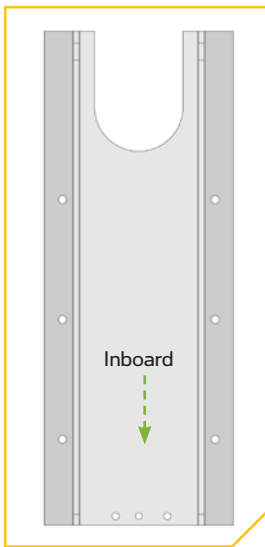

Terra

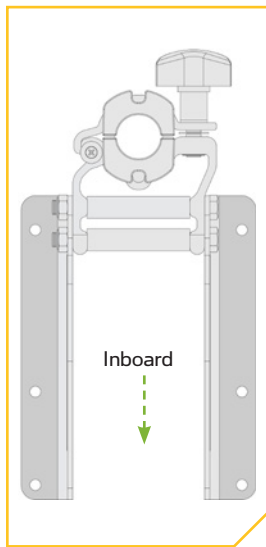

PowerDrive Pontoon
Hand Control Bracket

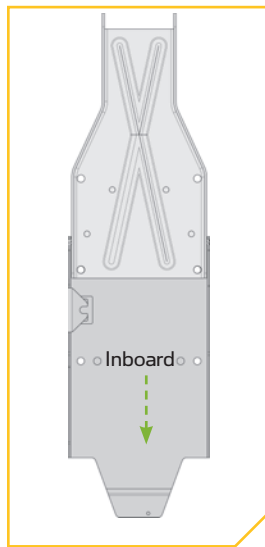

DeckHand 40

INSTALLATION

1

- a. Make sure that the Power Cables from the battery are disconnected, or that the breaker, if equipped, is "off".



WARNING

Make sure the motor is mounted on a level surface and is not connected to a power source.

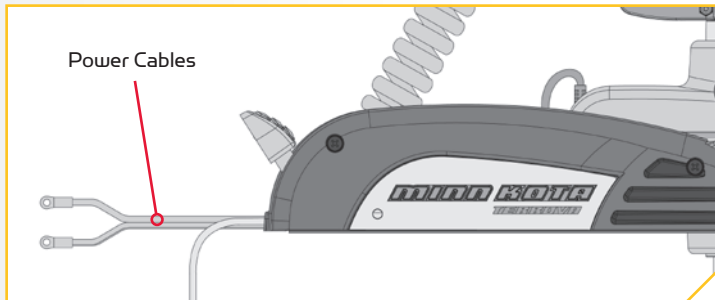

2

- b. Place the mount on an elevated, level surface such as a workbench or the tailgate of a pickup. The motor should be in the stowed position.
- c. Remove the four sideplate screws using a #3 Phillips screwdriver. Two of these screws will be located on each side of the mount.

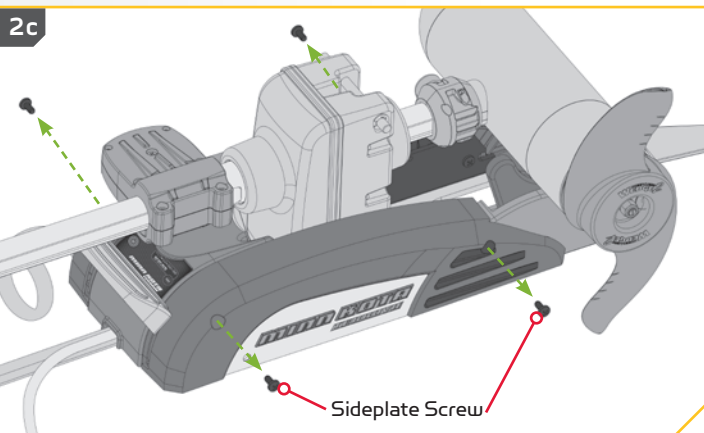
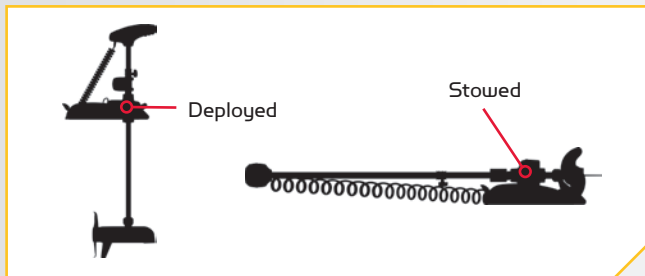

NOTE: A motor may weigh up to 65lbs. We recommend having a second person help with the installation. If mounting to a Pontoon Hand Control Bracket or Deckhand 40, directions specific to motor installation do not apply.

3

- d. Remove the Right Sideplate.
- e. Swing the Left Sideplate out and away from the Base Extrusion. Removing the sideplates exposes the mounting holes in the Base Extrusion.

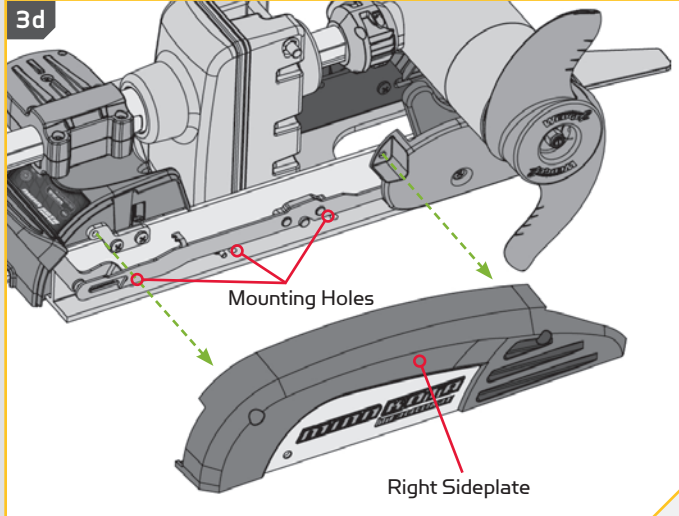
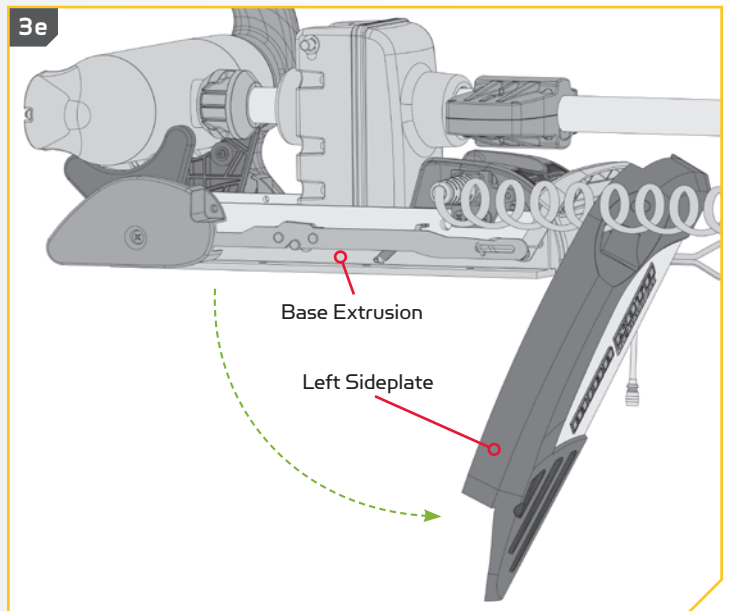
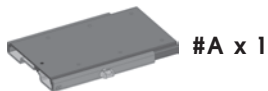
**3e****4****ITEM(S) NEEDED**

#A x 1

- f. Take the Quick Release Bracket Assembly (Item #A) and remove the Tension Screw Knob and Lock Washer. Set the Tension Screw Knob and the Lock Washer aside to reassemble later.
- g. Slide the Top Plate and the Bottom Plate and notice the range of motion allowed in the bracket, and the position of the bracket when it is completely closed. The Socket Head Cap Screw stops the motion of the brackets when closed. Slide the plates completely apart and set the Bottom Plate aside.

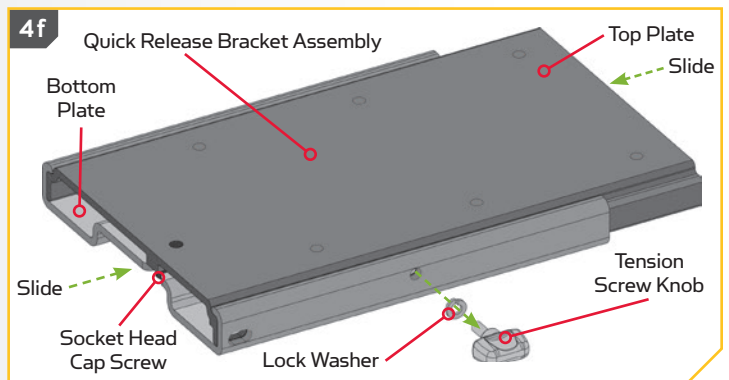
4f
CAUTION

Watch for pinch points when sliding the top and bottom plates of the Quick Release Bracket.

- h. On the Top Plate, take note of the placement of the single Socket Head Cap Screw already attached to the plate. When the Top Plate is attached to the Base Extrusion, the screw will sit under the mount closest to the end where the Power Cord exits the base of the Mount.

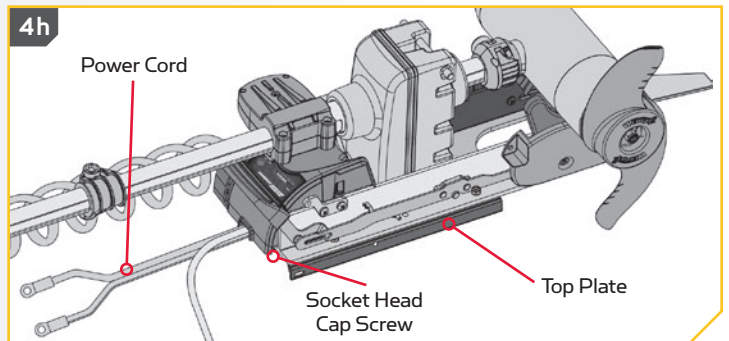
4h

5

ITEM(S) NEEDED

-  #14 x 4
-  #16 x 4

- i. Take the Top Plate and turn it so the flat side faces upwards. Align the Mounting Holes in the Top Plate with the Mounting Holes in the Base Extrusion that were exposed when the sideplates were removed. Make sure that the Socket Head Cap Screw is located on the mount closest to the Power Cord. The appearance of your Base Extrusion may vary depending on motor type.
- j. Use the 1/4 -20 X 7/8 Hex Head Cap Screw (Item #14) and Nylock Nuts (item # 16) to secure the Top Plate to the Base Extrusion. It is recommended to use a minimum of two bolts on each side, placing them the farthest apart on the mount. The screws will pass from the bottom up, through the Top Plate and then the Base Extrusion. The Nylock Nuts are placed on the screws on top of the Base Extrusion and tightened with the 7/16" Box End Wrench. Make sure all hardware is secure.

NOTE: To prevent seizing of hardware, do not use high speed installation tools. Wetting the screws or applying an anti-seize may help prevent seizing.

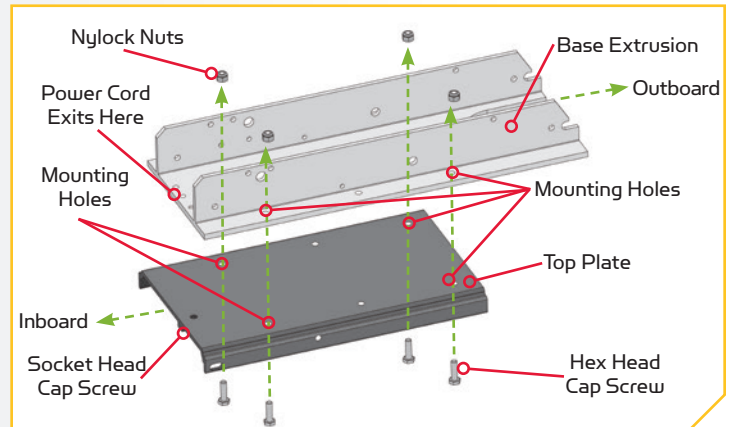

NOTE: If you are mounting an Ulterra to the Quick Release Bracket, the Clipped Washer that was previously used to install the motor to the boat, or included in the mounting hardware that came with the Ulterra motor should be used. Place the Clipped Washer above the Base Extrusion, between the Base Extrusion and the Nylock Nut.

6

- k. After the Top Plate is secured to the Base Extrusion, reassemble the Top Plate to the Bottom Plate by sliding it in place and securing with the Lock Washer and Tension Screw Knob.
- l. Replace the Right Sideplate.
- m. Swing the Left Sideplate back into its correct position on the Base Extrusion.

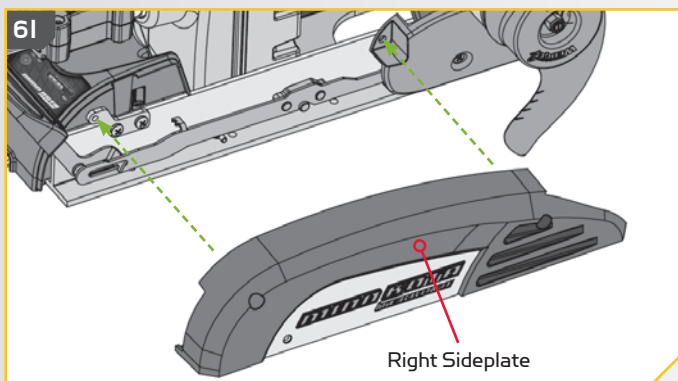
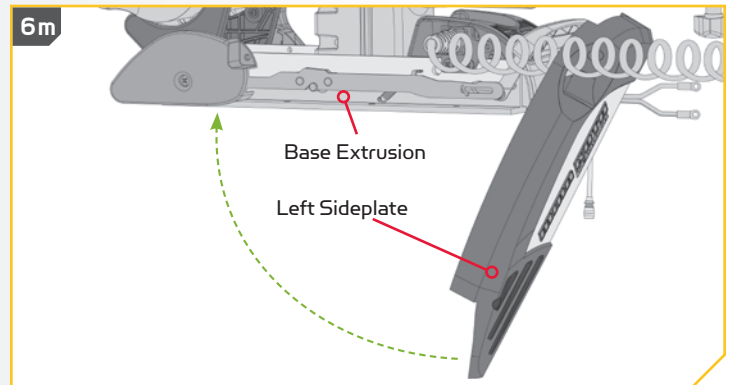

- n. Replace the four sideplate screws using a #3 or #2 Phillips screwdriver. Two of these screws will be located on each side of the mount.

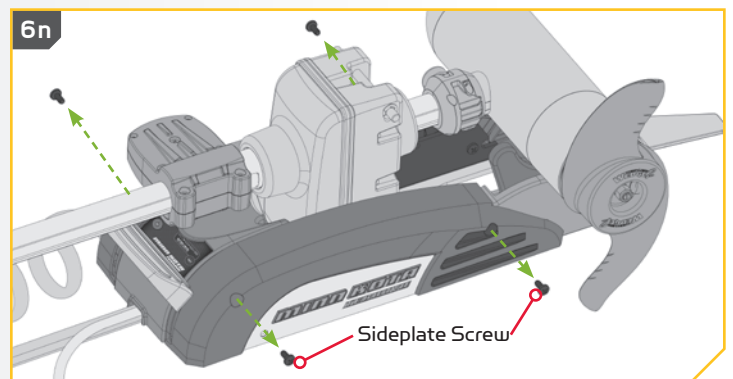

7

- o. Place the mount with the Quick Release Bracket attached as close to the center line or keel of the boat as possible. The motor can be installed on either the Port or Starboard side of the boat based on personal preference. Check placement with the motor in the stowed and deployed positions. Review the mounting considerations at the beginning of the installation.
- p. When the motor is in the deployed position, make sure that the Shaft is 1-1/2" out past the Gunwale of the boat. The lower unit, when stowed and deployed must not encounter any obstructions.

NOTE: Make sure that the motor will not encounter any obstructions when sliding the motor on and off the quick release bracket. The exact placement of the motor and quick release bracket when mounting may vary depending on the boat, boat deck, and which base extrusion or bracket the quick release bracket is being mounted to. The Ultrera motor cannot be deployed before mounting and connecting a power source.

7o

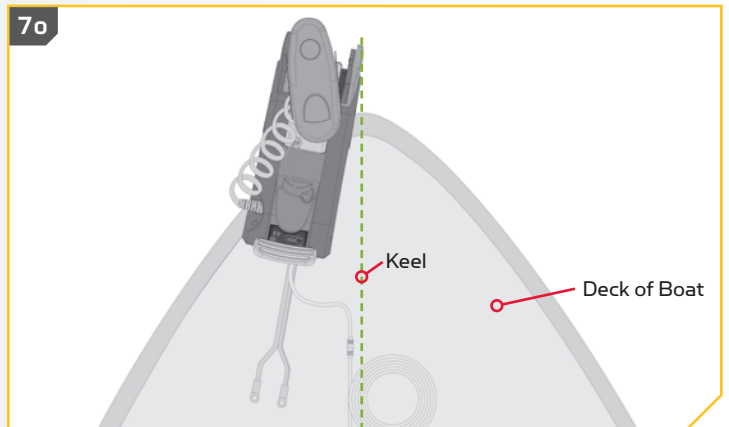

7p

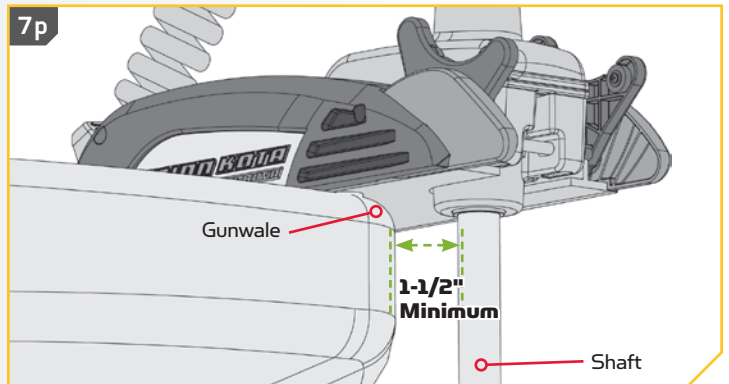

8

- q. Mark the side edges and rear of the Bottom Plate on the bow of the boat.
- r. Remove the Tension Screw Knob and Lock Washer and slide the motor and Top Plate inboard and off to remove it from the Bottom Plate.

8r

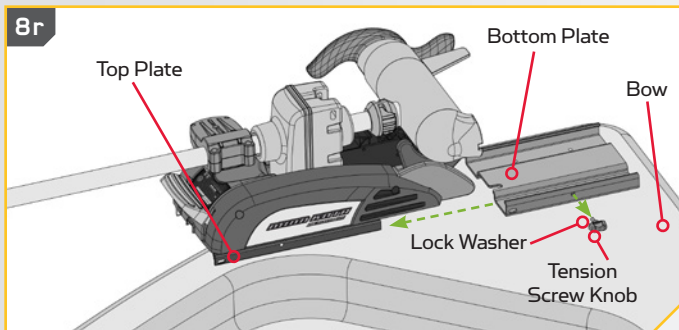

8q

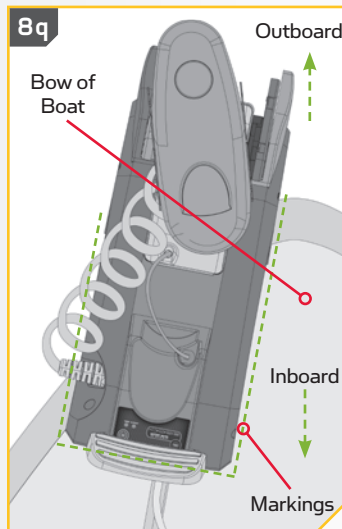

8r

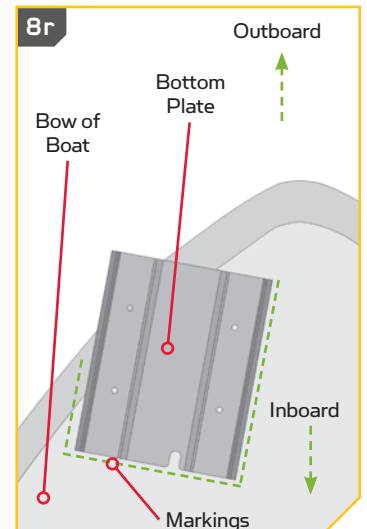

9

- s. Reposition the Bottom Plate on the marks made on the bow of the boat. Make sure the U Shape on the Bottom Plate is facing inboard. Locate the 4 mounting holes in the Bottom Plate and mark them on the bow. It is recommended to use all four bolts to mount the Bottom Plate. Set the Bottom Plate aside.
- t. Drill through the deck of the boat using a 9/32" Drill Bit on the marked locations.



10**ITEM(S) NEEDED**

- u. Put a 1/4-20 X 2" HHC ZP Bolt (Item #18) in each of the four drilled locations. The bolt should pass through the Bottom Plate and the boat deck. Make sure to secure the motor with bolts on each side of the Bottom Plate.
- v. Place a Fender Washer (Item #12) and then a Nylock Nut (Item #16) at the end of each bolt as shown and tightened with the 7/16" Box End Wrench. Make sure all hardware is secure.

NOTE: To prevent seizing of hardware, do not use high speed installation tools. Wetting the screws or applying an anti-seize may help prevent seizing.

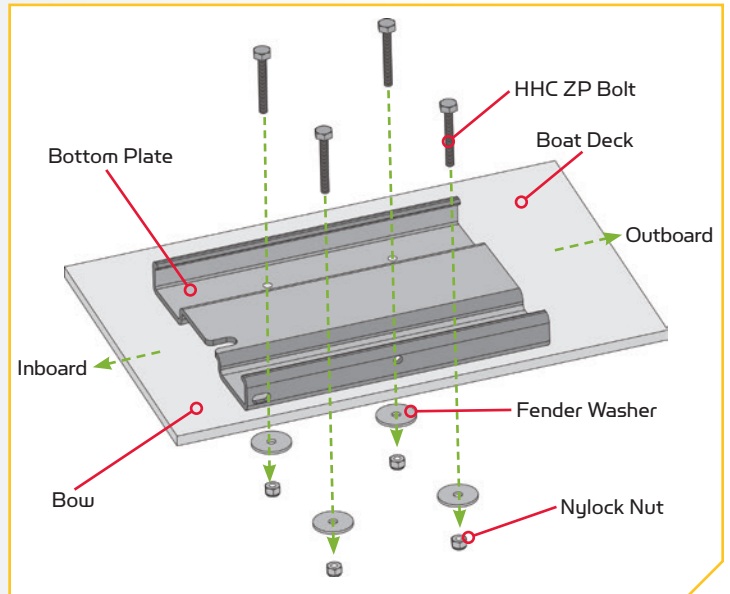
**11**

- w. Slide the Top Plate attached to the motor back onto the Bottom Plate that was mounted to the Bow of the boat and secure with the Lock Washer and Tension Screw Knob. Always check the Tension Screw Knob and tighten when needed.

NOTE: Lock your motor to help prevent theft.

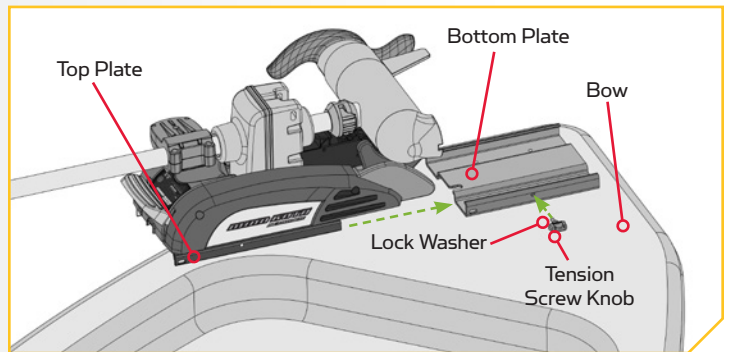
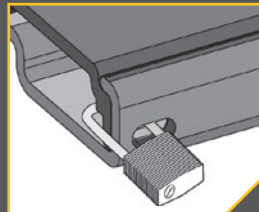

Part #2374914



©2016 Johnson Outdoors Marine Electronics, Inc.

Learn more about boat motors on our website.