

**NEW  
PRODUCT!**



***poly-planar***®

**WATERPROOF SPA SOUND SYSTEMS**

## **SB50G 2" Spa Wall Speaker**



### **Features:**

- 4 ohm impedance
- Full frequency audio range
- 35 watt RMS power rated
- Chemical resistant components allow spa or marine use
- Threaded body with backing nut
- Oval or round grill
- Driver and/or grill can be replaced from front side for easy future service
- Mounts in 66mm/2.6" hole with included gasket and backing nut
- Mounting depth from mounting surface – 37mm/1.5 inches
- Front grill dimensions 121mmX89mm/4.75"X3.5"

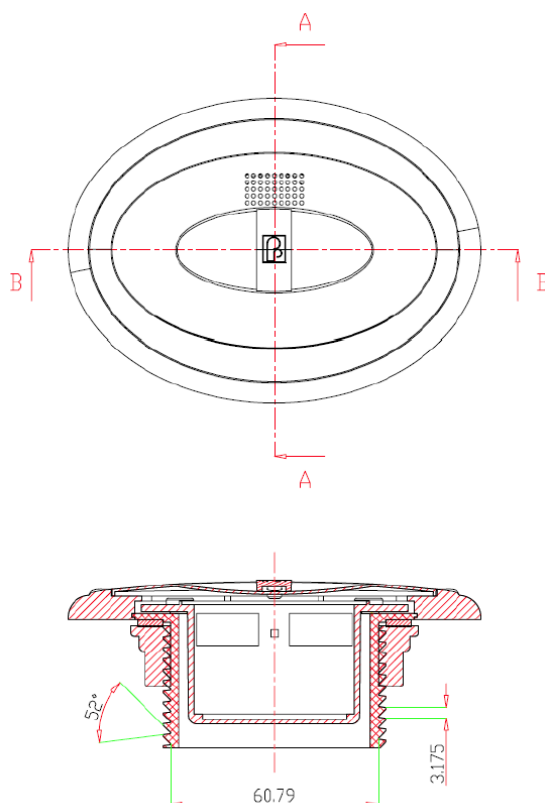

Discover other marine GPS navigation on our website.