

## Pole mount adaptor installation instructions

### Parts supplied

The following parts are supplied with your accessory:

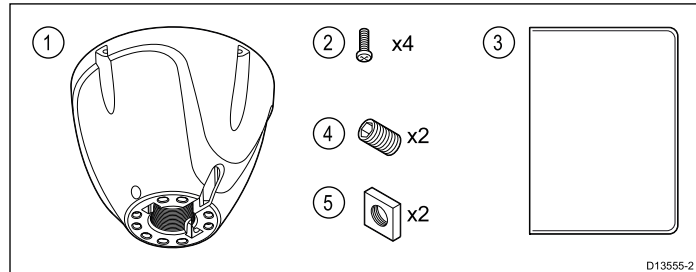

1. Pole mount adaptor
2. Fixings screws x 4
3. Documentation
4. Grub screws x 2 (supplied fitted to the adaptor)
5. Captive nuts x 2 (supplied fitted to the adaptor)

Unpack your product carefully to prevent damage or loss of parts. Check the box contents against the list above. Retain the packaging and documentation for future reference.

### Pole mount compatibility

The Pole mount adaptor can be used to pole or rail mount the following products:

Product description	Part number
RS150 GNSS Receiver	E70310
Micro-Talk Gateway	E70361

### Pole mounting

Pole mounting requires a Pole with a 1 inch 14 TPI thread:

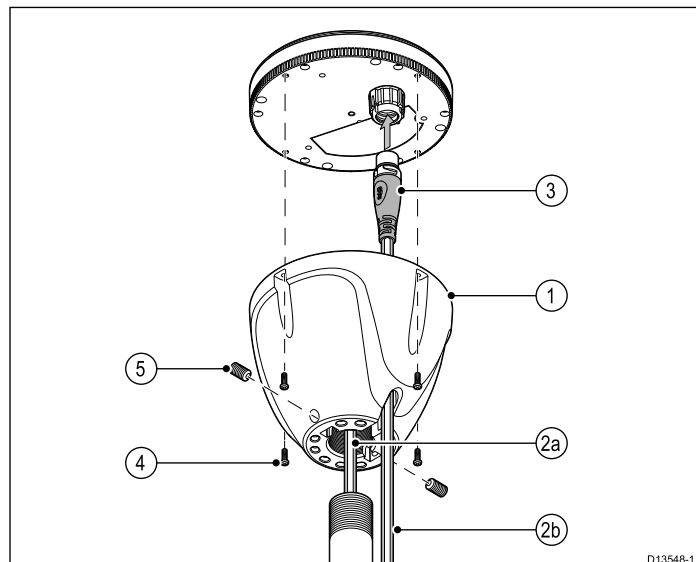

1. Attach the Pole Mount Adaptor (A80370) to the top of the pole.
2. Feed the supplied cable through either:

- 2a) the center of the Pole Mount Adaptor and Pole, or
  - 2b) the cable exit hole.
3. Connect the supplied cable to an available **SeaTalk<sup>ng</sup>** spur connection and then connect the other end of the cable to the connector on the unit and secure using the locking collar.
  4. Ensuring correct orientation, Secure the unit to the Pole Mount Adaptor using the fixings provided.
  5. Fix the unit's orientation by tightening the grub screws provided.

The grub screws and their captive nuts are supplied fitted to the adaptor.

**Note:** The Pole Mount Adaptor may also be used to rail mount the unit using a 3rd party rail clamp with a 1 inch 14 TPI thread.

### Adjusting pole mount alignment

If the unit you are mounting includes a heading sensor, you must ensure that the unit is orientated correctly.

1. Loosen the grub screws slightly.
2. Twist the unit until the desired alignment is achieved.  
  
Unit should be facing the bow and be parallel with the centerline of the vessel.
3. Re-tighten the grub screws to secure the unit in position.