



# CABLE CONNECTION KIT CA27563P INSTRUCTIONS

**INSTALLER: THESE INSTRUCTIONS CONTAIN IMPORTANT SAFETY INFORMATION AND MUST BE FORWARDED TO THE BOAT OWNER.**

These instructions are for assembly of connection kits for CH4400 Series and CH5600P controls.

## INSTALLATION:

### CH4400 SERIES

1. Screw pivot (item 1) onto the threaded end of the cable.
2. Insert bushing (item 4) into hole through arm (item 3), ensuring that the larger flange is on the same side as the chamfer on the hole.
3. Slide the small end of the pivot through the bushing which is through the hole in the arm.
4. Slide the flat washer (item 2) over the small end of the pivot.
5. Secure assembly by inserting cotter pin (item 5) through the hole in the small end of the pivot and spreading the cotter pin legs.

### CH5600P

1. Screw pivot (item 1) onto the threaded end of the cable.
2. Insert bushing (item 4) into hole through arm (item 3), ensuring that the larger flange is on the same side as the chamfer on the hole.
3. Slide the small end of the pivot (item 1) through the bushing which is through the hole in the arm.
4. Slide the flat washer (item 2) over the small end of the pivot.
5. Secure assembly by inserting cotter pin (item 5) through the hole in the small end of the pivot and spreading the cotter pin legs.

### CH4400P

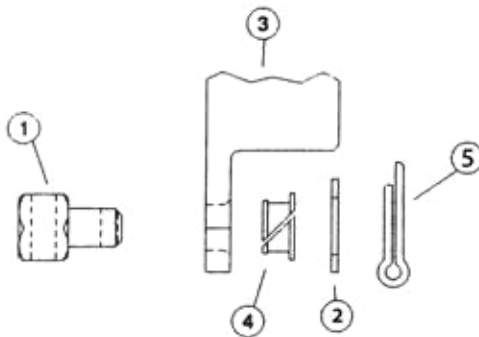

### CH5600P

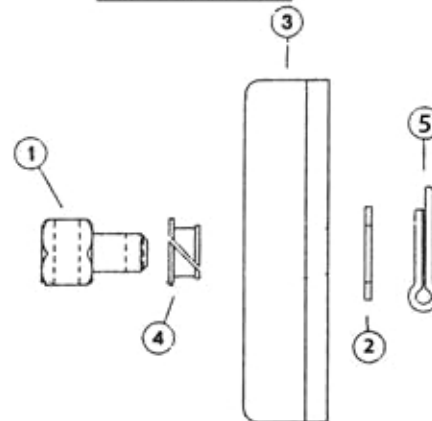

Item #	Description	Qty
1	Pivot	1
2	Flat Washer	1
3	Control Arm	1
4	Bushing	1
5	Cotter Pin	1