



# JETBOAT STEERING SYSTEM BEZEL MOUNTING KIT SB39452

## INSTRUCTIONS

**THESE INSTRUCTIONS CONTAIN SAFETY INFORMATION AND MUST BE FORWARDED TO BOAT OWNER**

These instructions show you how to install a BEZEL mount kit for a Jetboat steering system. **This steering system is for use with small jet propelled boats using 2 cycle engines. IT IS NOT FOR USE WITH LARGE JET PUMPS USING AUTOMOTIVE V8 ENGINES.** A complete system consists of the following components.

- **Bezel Mounting Kit SB39452**
- **Helm assembly SH5087** - 135° steering wheel turn, or,
- **Helm assembly SH5088** - 270° steering wheel turn
- **Cable assembly SSC219XX** (XX denotes length in feet)
- **Steering Wheel**, consult catalog
- **Engine Connection Kit**, See catalog

### WARNING

- BEFORE STARTING INSTALLATION READ THESE INSTRUCTIONS AND ENGINE MAKERS INSTRUCTIONS THOROUGHLY. FAILURE TO FOLLOW EITHER OF THESE INSTRUCTIONS OR INCORRECT ASSEMBLY CAN RESULT IN LOSS OF CONTROL AND CAUSE PROPERTY DAMAGE OR INJURY.
- DO NOT SUBSTITUTE PARTS FROM OTHER MANUFACTURERS. THEY MAY CAUSE A SAFETY HAZARD FOR WHICH SEASTAR SOLUTIONS CANNOT ACCEPT RESPONSIBILITY.
- TO AVOID EXCESSIVE STEERING LOADS AND TO GET THE BEST STEERING PERFORMANCE, THE WATER JET NOZZLE AND THE REVERSE GATE MUST BE ADJUSTED AS INSTRUCTED IN THE MOTOR MANUFACTURERS OPERATION MANUAL. FAILURE TO DO SO CAN AFFECT THE PERFORMANCE OF THE BOAT AND ITS SAFE OPERATION.

**NOTE:** Helms and cable assemblies are supplied lubricated ready for installation, do not add any lubricant to either assembly. Use of other lubricants can cause damage to the steering cable, resulting in the cable seizing or premature wear.

### WARNING

HELMS MUST NOT BE DISASSEMBLED FOR ANY REASON. REMOVAL AND REPLACEMENT OF ANY HARDWARE MAY LEAD TO TOTAL FAILURE OF THE SYSTEM WHICH COULD CAUSE PERSONAL INJURY AND OR PROPERTY DAMAGE.

**CABLE ROUTING:** Before beginning installation, the steering cable routing must be selected. When routing the steering cable select a path with the minimum number of bends making the bends as large a radius as possible. **DO NOT MAKE BENDS LESS THAN 8 INCH RADIUS.** Sharp or frequent bends will result in hard steering and premature cable wear. When it is necessary to pass through a bulkhead, a 3/4" Dia. hole is required. Cable should be supported at regular intervals.

### CAUTION

CABLE MUST NOT BE BUNDLED TOGETHER WITH ELECTRICAL WIRING. CABLE MUST NOT REST ON SHARP EDGES WHICH CAN CAUSE CHAFING.

### HELM MOUNTING BRACKET INSTALLATION

THE HELM MAY BE INSTALLED FOR EITHER PORT, STARBOARD, VERTICAL OR INLINE CABLE ENTRY. THIS IS DETERMINED BY THE TYPE OF ENGINE IN USE AND THE CONSTRUCTION OF THE BOAT. FIGURE 1 AND THE TEMPLATE SHOW A REFERENCE POINT TO ASSIST IN POSITIONING THE MOUNTING BRACKET. STUDY THIS CAREFULLY BEFORE DRILLING ANY HOLES. DIMENSIONS SHOWN IN TEMPLATE MUST BE MAINTAINED TO ENSURE PROPER CLEARANCES. Locate the position for the steering wheel on the console or dashboard. (See figure 1). Using template oriented as determined by figure 1, mark location of holes. Drill three holes 6.60mm. (5/16") diameter and one hole 69.85mm (2 -3/4") diameter. Place Mounting Bracket (Item 1) in position on dash and fasten securely in place using washers (Item 5), hex bolts (Item 3) and Locknuts (Item 4).

### CAUTION

BOLTS (ITEM 3) MUST BE INSTALLED WITH THE HEAD OF THE BOLT BEHIND THE DASHBOARD AS SHOWN IN FIGURE 2, TO PREVENT INTERFERENCE WITH THE ARM OF THE HELM.

Do not install the bezel at this time, proceed to install the helm unit following the instructions packed with that unit.

PARTS LIST		
Item	Description	Quantity
1	Mounting Bracket	1
2	Bezel	1
3	Hex Head Bolt 1/4"	3
4	Lock Nut 1/4"	3
5	Flat Washer 1/4"	3
6	Self Tapping Screw	2
7	Flat Washer 1/2"	1
8	Hex Nut 1/2"	1
9	Woodruff Key	1

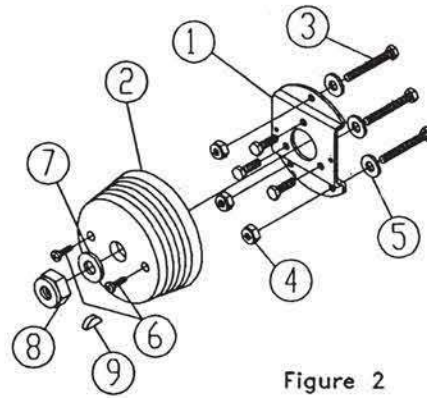

Figure 2

### HELM MOUNTING OPTIONS

<p>There are four basic cable-to-helm mounting options (shown at right):</p> <p>(both sides shown)</p>				
	OPTION 1	OPTION 2	OPTION 3	OPTION 4
<p>There are four basic helm mounting bracket-to-dash options (shown below):</p>	<p>Output when using the above cable mounting options with the following helm mounting bracket location options:</p>			
 	<p>Cable exits helm straight back.</p> <p>Starboard turn pushes cable (Mercury Sport Jet)</p>	<p>Cable exits helm straight back.</p> <p>Starboard turn pulls cable (OMC Turbo Jet)</p>	<p>Cable exits helm to port side.</p> <p>Starboard turn pulls cable (OMC Turbo Jet)</p>	<p>Cable exits helm to starboard side.</p> <p>Starboard turn pushes cable (Mercury Sport Jet)</p>
 	<p>Cable exits helm straight back.</p> <p>Starboard turn pushes cable (Mercury Sport Jet)</p>	<p>Cable exits helm straight back.</p> <p>Starboard turn pulls cable (OMC Turbo Jet)</p>	<p>Cable exits helm to starboard side.</p> <p>Starboard turn pulls cable (OMC Turbo Jet)</p>	<p>Cable exits helm to port side.</p> <p>Starboard turn pushes cable (Mercury Sport Jet)</p>
 	<p>Cable exits helm straight back.</p> <p>Starboard turn pushes cable (Mercury Sport Jet)</p>	<p>Cable exits helm straight back.</p> <p>Starboard turn pulls cable (OMC Turbo Jet)</p>	<p>Cable exits helm straight down.</p> <p>Starboard turn pulls cable (OMC Turbo Jet)</p>	<p>Cable exits helm straight up.</p> <p>Starboard turn pushes cable (Mercury Sport Jet)</p>
 	<p>Cable exits helm straight back.</p> <p>Starboard turn pushes cable (Mercury Sport Jet)</p>	<p>Cable exits helm straight back.</p> <p>Starboard turn pulls cable (OMC Turbo Jet)</p>	<p>Cable exits helm straight up.</p> <p>Starboard turn pulls cable (OMC Turbo Jet)</p>	<p>Cable exits helm straight down.</p> <p>Starboard turn pushes cable (Mercury Sport Jet)</p>

NOTE: In addition to the above mounting bracket options, slotted mounting brackets allow 20° of helm rotation in both directions.

Figure 1