

# RBX™

# RBX-123 Kit

## Rubex Interchangeable Hub System Installation Instructions

It is very important to refer to your Engine's Owner Manual for important safety precautions when installing the propeller. Use the original propeller hardware thrust washer, spacer, locking tab, nut, and cotter pin depending on engine/drive manufacturer. This is a Mercury installation instruction.

- 1) Put the original thrust washer on propeller shaft just as it came off. The taper on the thrust washer should mate properly with the taper on the propeller shaft.
- 2) Put the Rubex RBX Hub (#73151601) into the rear of the propeller's hub cavity (boat side). The splines on the Rubex RBX Hub (#73151601) should face towards the front of the propeller (tips of the blades). The Rubex RBX Hub (#73151601) should slide  $\frac{3}{4}$  or more into propeller hub cavity or it may be backwards.
- 3) Press or tap gently the Rubex RBX Hub (#73151601) so the propeller hub is flush with the hub cavity.
- 4) Grease the propeller shaft.
- 5) Slide the propeller assembly onto the propeller shaft.
- 6) Install Aft Spacer, if required. Consult your engine/drive manual.
- 7) Install the Washer, if required. Consult your engine/drive manual.
- 8) Install the shaft nut. Consult your engine/drive manual for proper torque.
- 9) Secure nut by bending tabs on the Washer to engage slots in Aft Spacer.

### WARNING:

**Always shift engine into the neutral position. Remove spark plug leads and ignition coil lead when you are servicing the propeller.**

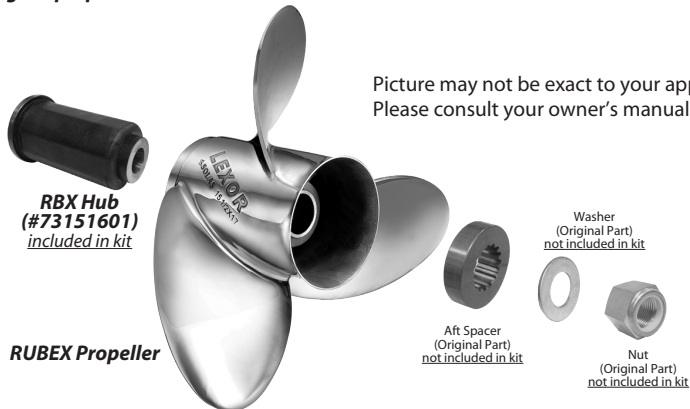

### RBX-123 APPLICATIONS:

Mercury/Mariner/Mercruiser 1 1/4" propshaft, 19 tooth spline

Mercury/Mariner/Mercruiser are registered trademarks of the Brunswick Corporation.

# SOLAS®