



# Manual Galley Pump - Foot Operated

## Gusher® Galley Mk 2 Pump

### Gusher® Galley Mk 2 - discontinued in 1984

Note\* Contained in Service Kit AK0502

PRODUCT  
DISCONTINUED

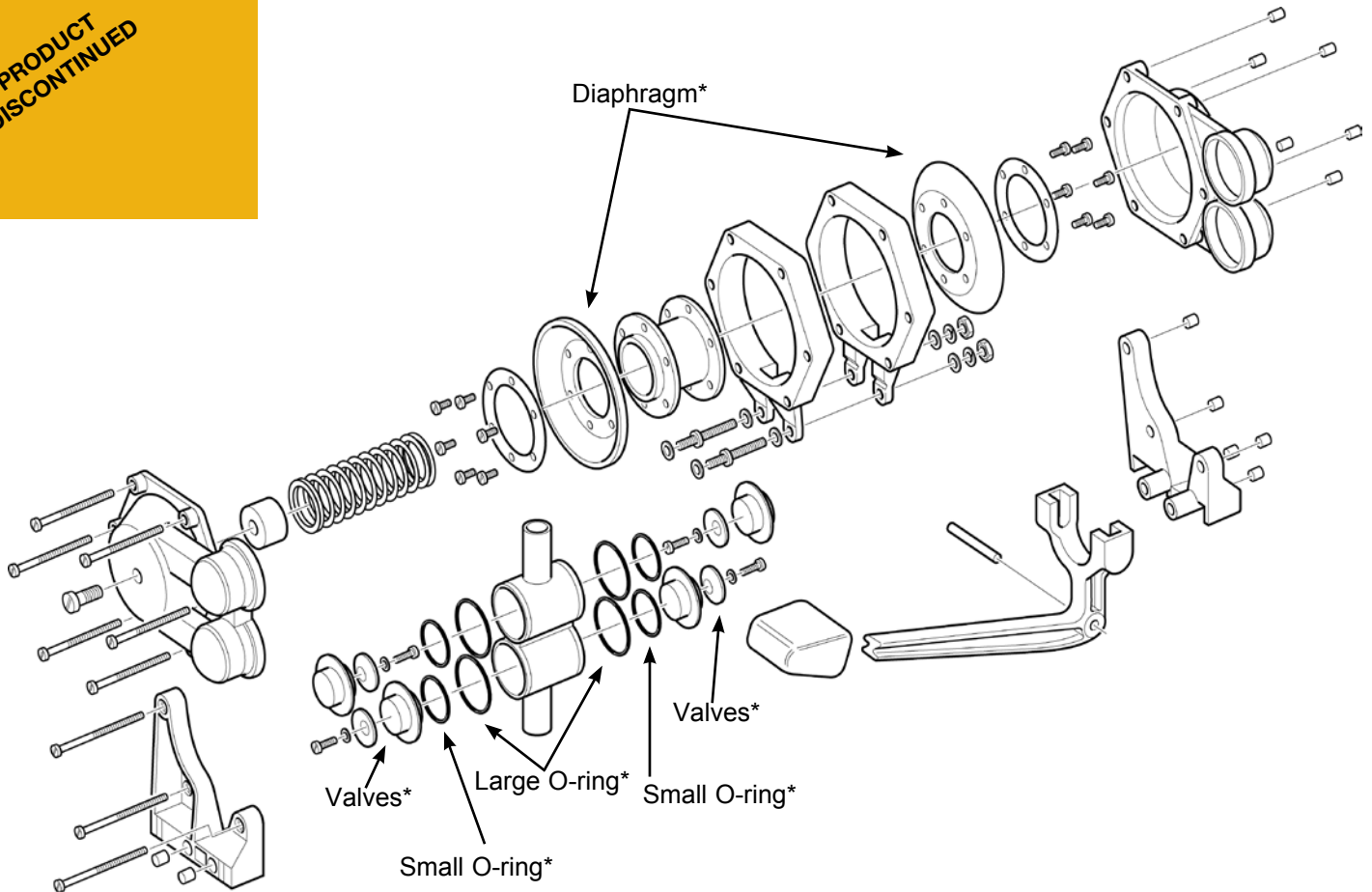

Pump replaced in 1984 by Gusher® Galley Mk 3 (see page 32). Mk 1 stock is not available

### Service Kits

#### AK0502 Service Kit with Complete Set of Serviceable Parts for Whale Gusher® Galley Mk 2

Qty	Containing
4	Small O-ring
4	Valve
4	Large O-ring
2	Diaphragm

Note: This product is now out of production and has been replaced by Whale Gusher® Galley Mk 3 Pump. (See Page 32). No other service kits are available for this pump.



AK0502



# Manual Galley Pump - Foot Operated

## Gusher® Galley Mk 3 Pump (Introduced 1984)

### Gusher® Galley Mk 3 Pump GP0550 (Right Hand Version) GP0551 (Left Hand Version) - Foot Operated Fresh Water Pump.

**Note\*** Contained in Service Kit AK0553 - Introduced 1984

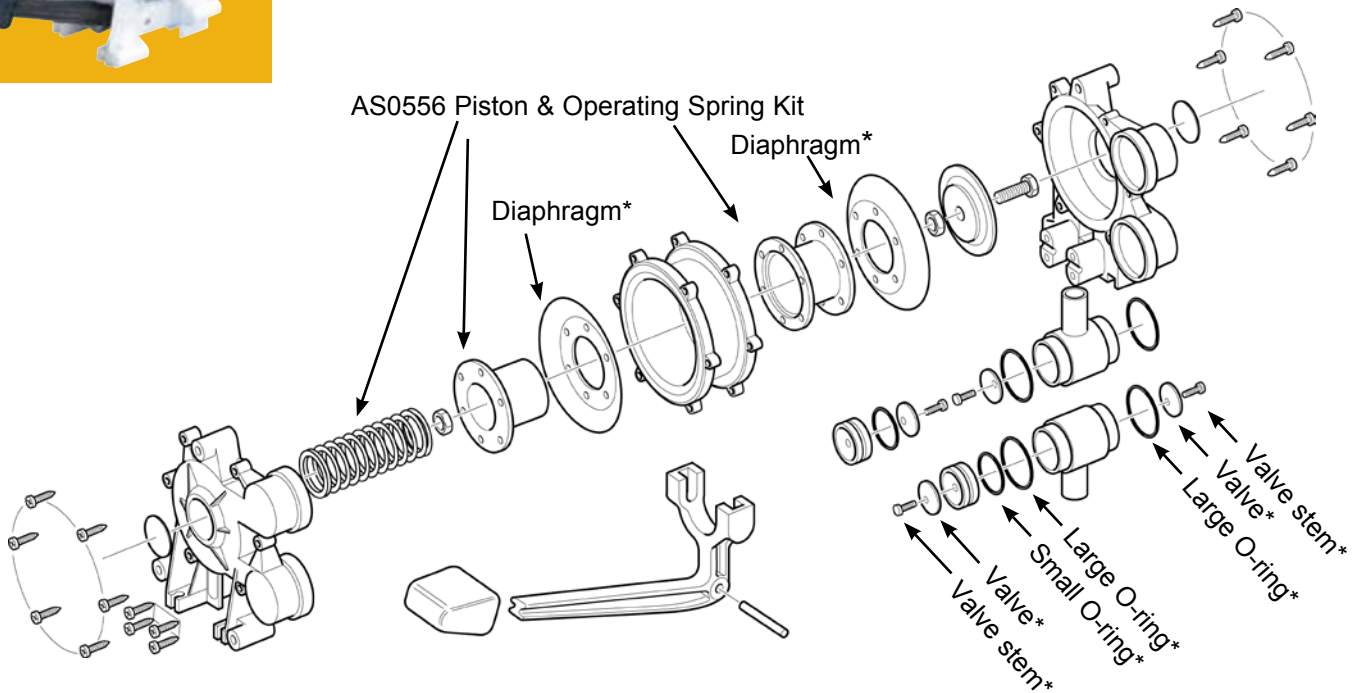

#### Accessories

**WF1530 Silverised Carbon Water Filter (inline)**

#### Service Kits

**AK0553 Service Kit with Complete Set of Serviceable Parts for Whale Gusher® Galley Mk 3**

Qty	Containing
2	Small O-ring
4	Valve
4	Valve stem
4	Large O-ring
4	Self tapping screw
1	Sealing washer
2	Diaphragm

#### AS0556 Piston & Operating Spring Kit

Qty	Containing
1	Nut M6
1	Operating spring
1	Clamping cup
1	Piston
1	Clamping plate
1	Sealing washer
1	Screw M6



WF1530



AK0553



AS0556