



# Whale<sup>®</sup>

## SWIM 'N' RINSE SHOWER

**READ CAREFULLY BEFORE INSTALLATION AND USE. NOTE: THIS PRODUCT IS SPLASH PROOF - NOT WATER PROOF.**

### To the fitter/User:

Ensure all relevant personnel read the points listed below before installation and use of the equipment.

### Application:

The Whale Swim 'n' Rinse Shower is intended to be used as a freshwater external shower for rinsing off salt water and sand. It is designed to be installed in a boat's transom, cockpit or near the swim platform. Use for any other purpose or with any other liquid is entirely at the user's risk.

### Before Installation:

1. Check that there is enough room for the shower hose to retract safely behind the mounting surface.
2. The maximum effective length of shower hose is 6 ft or 1.8 metres. Check that when the shower head is lifted out the hose will stretch to the required height and distance.
3. Check there is enough room to plumb the unit in and the plumbing is accessible.
4. Place large washer into ferrule on hose assembly and tighten onto shower handset

(see Fig. 1).

5. Feed unattached end of hose through hole in housing from the front. Fit the small washer and tighten onto the tee-piece in the rear of the unit, prior to plumbing.

6. As it is possible for a small amount of water to trickle along the shower hose when in operation check that there is no possibility of drips

damaging electrical equipment, furnishings or contents of locker.

### Mounting:

1. Select a suitable location and using the template supplied cut a rectangular hole (size 244.5 x 130.5 mm).
2. Again using the template drill 6 holes (4.4 mm dia).
3. For units with the hinged cover, the cover must be engaged in the hinges **before** fixing the shower in position. Secure using the six screws provided.
4. Conceal the screw heads with the covers provided.

### Plumbing:

1. Locate the existing water system pipework and plumb appropriate supply into transom shower.

### Flexible Hose

The tail pieces are ½" NPT male threaded. For ½" (13 mm) hose attach Whale ½" NPT straight connector or elbow (AS0314) not supplied (see Fig.2.). Use stainless steel hose clips to secure.

### Whale Semi-Rigid Pipework System

Screw on Whale female ½" threaded WX1532 pipework connector (not supplied). Make sure the pipework is fully pushed home (see Fig.

## Operation:

**Safety:** The off position on the shower head should only be used to shut off the flow of water temporarily as the shower head is not designed to withstand constant pressure. It is not a drip proof seal. (Note: Maximum operating pressure is 50 psi).

### Units with Hinged Cover

Hinges are designed to allow lid to be held open when opened to a certain position.

## Maintenance

Regular inspection is recommended. Replacement components are available from dealers or direct from the manufacturer.

### Winterizing

To avoid damage as a result of freezing, drain the entire water system (ensuring that the flow selector is in one of the open positions while draining). Please consult your dealer if in difficulty. If they are unable to solve the problem, contact Whale.

## Warranty

This Whale product is covered by 1 years warranty. Please see the enclosed document for details of our statement of limited warranty.

Fig. 1

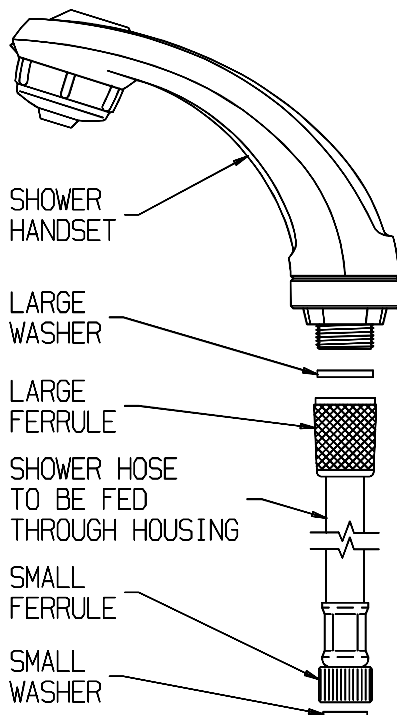
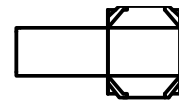
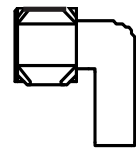

Fig. 2

### Optional Connectors



**AS0314**  
Straight Connector &  
Elbow Connector  
(for 1/2" Bore Flexible  
Hose)



**WX1532**  
Pipework Connector  
(for 15 mm O.D. semi  
rigid pipe)

